





- Larger than Average Mid-Terrace
- Entrance Hall
- Two Reception Rooms
- Large Kitchen Breakfast Room
- Two Double Bedrooms
- Four Piece Bathroom Suite
- Large Rear Garden
- Off Road Parking

### Description

A larger than average, mid-terrace house, conveniently situated and with the benefit of gas central heating and PVCu double glazing. Entrance hall, lounge, dining room, large kitchen breakfast room, first floor landing, two double bedrooms and large bathroom with a four piece suite. Outside there is an ornamental front garden a large rear garden and there is off road parking for at least two cars. Immediately available, restrictions apply.



**Location**  
**Tenure**

**EPC Rating:**

**Important Notes**  
Type Here



### Ground Floor

Approx. 46.9 sq. metres (505.1 sq. feet)

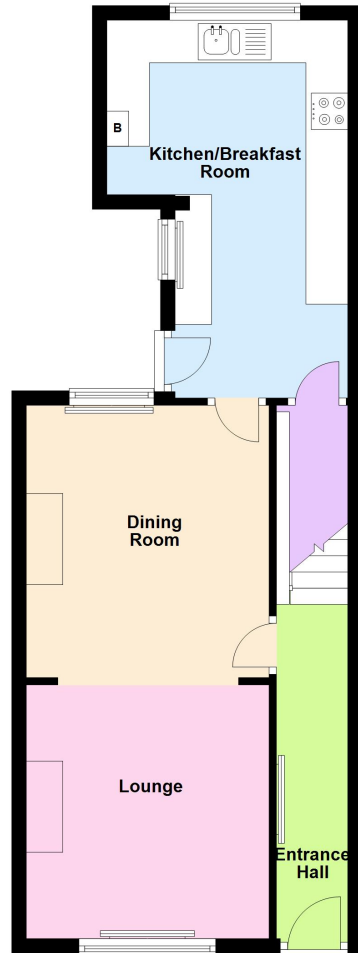

### First Floor

Approx. 38.3 sq. metres (412.1 sq. feet)

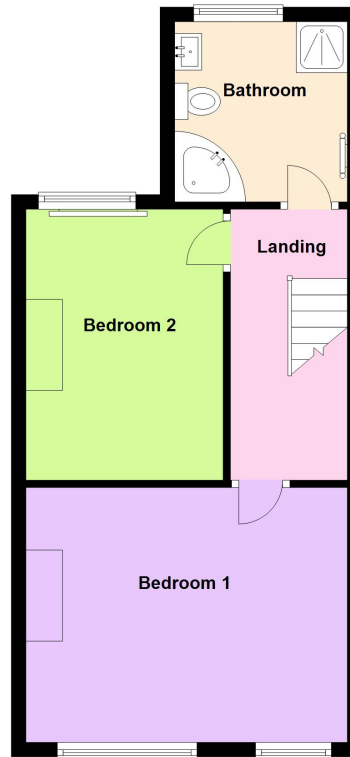

Total area: approx. 85.2 sq. metres (917.2 sq. feet)

