

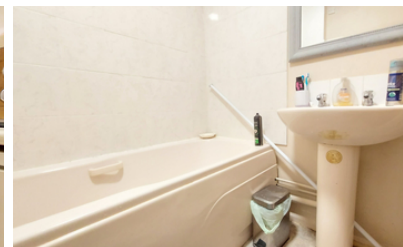

Flat 3 Church View, Church Walk, Bourne, Lincolnshire PE10 9UQ

£65,000

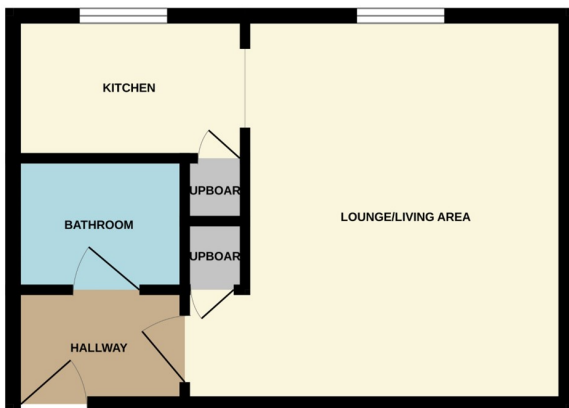

GROUND FLOOR BEDSIT WITHIN WALKING DISTANCE OF BOURNE TOWN CENTRE This block of apartments is conveniently located for local amenities and has an allocated parking space. The property consists of entrance hall, lounge/living area, kitchen and bathroom. There is currently a tenant in the property. To fully appreciate this opportunity viewings are recommended. EPC Rating C/ Council Tax Band A.

ENTRANCE HALL
LOUNGE/LIVING AREA

14' 7" x 12' 1" (4.45m x 3.68m) (approx.) UPVC double glazed window to rear and storage heater.

KITCHEN

8' 9" x 5' 4" (2.67m x 1.63m) (approx.) Fitted with a range of base and eye level units with work surfaces over and stainless steel sink unit, partly tiled, cooker space, plumbing for automatic washing machine, fridge space and cupboard.

BATHROOM

Fitted with a three piece suite comprising wash hand basin, WC and bath. Partly tiled and tiled floor.

AGENTS NOTE

The floorplan is for illustrative purposes only. Fixtures and fittings may not represent the current state of the property. Not to scale and is meant as a guide only.

Leasehold information given by the vendor:
 Approximately just under 90 years left on the lease.

Maintenance charge - £45 per month.

