



18 Stratford Court, Avon Road, Farnham, Surrey. GU9 8PG.
Guide Price £385,000



Description

Set within beautifully landscaped communal grounds, Stratford Court is widely regarded as one of Farnham's most desirable retirement developments, perfectly positioned on the south side of town within easy walking distance of Farnham's elegant Georgian centre and local bus stop. Built in the mid-1980s, this well-proportioned light filled freehold bungalow offers comfortable, secure living in a friendly, warden-assisted community. The accommodation includes gas central heating, two reception rooms, a bright conservatory, a stylish re-fitted kitchen with integrated appliances, two bedrooms and a luxury fully tiled shower room, all complemented by emergency pull cords for peace of mind. Outside, residents enjoy immaculately maintained communal gardens, along with a private patio directly to the rear of the property, a single garage with forecourt and resident parking in the courtyard. Pet ownership is permitted subject to approval, making this an ideal choice for those seeking relaxed, low-maintenance living in one of Farnham's most sought-after retirement settings.



Directions

Proceed out of the town centre up Firgrove Hill and turn right immediately after the pelican crossing into Arthur Road. Take the first turning on the left into Avon Road and the entrance to Stratford Court will be found towards the end of this private road on the right hand side.



Local Authority

Waverley
Band D

**18 Stratford Court, Avon Road,
Farnham, GU9 8PG**

Ground Floor

Approx. 68.9 sq. metres (741.3 sq. feet)

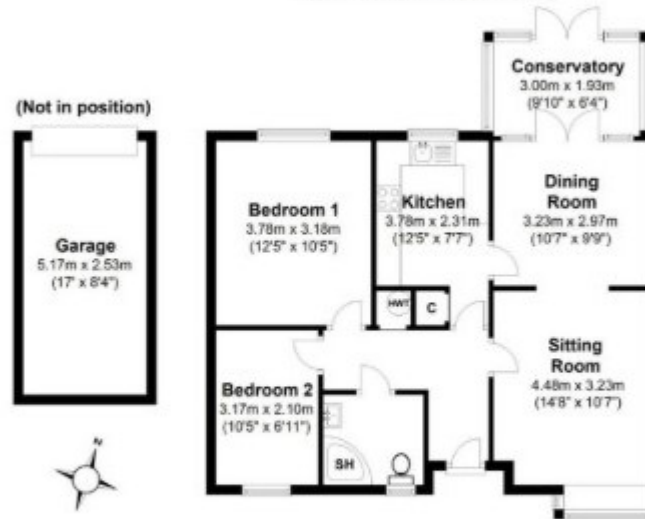

House area: approx. 68.9 sq. metres (741.6 sq. feet)

Garage area: approx. 13.1 sq. metres (141.0 sq. feet)

Total area: approx. 82.0 sq. metres (882.6 sq. feet)

This plan is for layout guidance only.
Measurements are for general guidance
only and must not be relied upon

15 Downing Street , Farnham, Surrey, GU9 7PB

Tel: 01252 718018

Email: sales@keatsfearn.co.uk

Web: www.keatsfearn.co.uk

keatsfearn

