



Lancaster Drive, CAMBERLEY, Surrey GU15 3HY

PRICE £429,950 Freehold

Jigsaw Estates are pleased to offer to the market a rare opportunity to purchase a modern 2-storey town house located in the heart of Camberley town centre and within a few minutes walk of the local train station which offers some direct routes into London. Accommodation comprising three bedrooms and a spacious lounge/dining room. To the front of the property there is driveway parking. Camberley offers excellent transport links.



- TOWN CENTRE LOCATION
- LOUNGE/DINER
- BEAUTIFULLY PRESENTED
- RE-FITTED BATHROOM
- SUNNY ASPECT REAR GARDEN
- THREE BEDROOMS
- MODERN KITCHEN
- RE-FITTED EN-SUITE
- CONSERVATORY
- CLOAKROOM

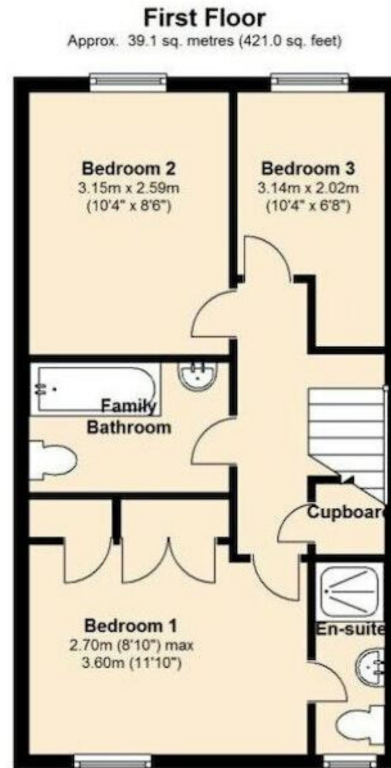
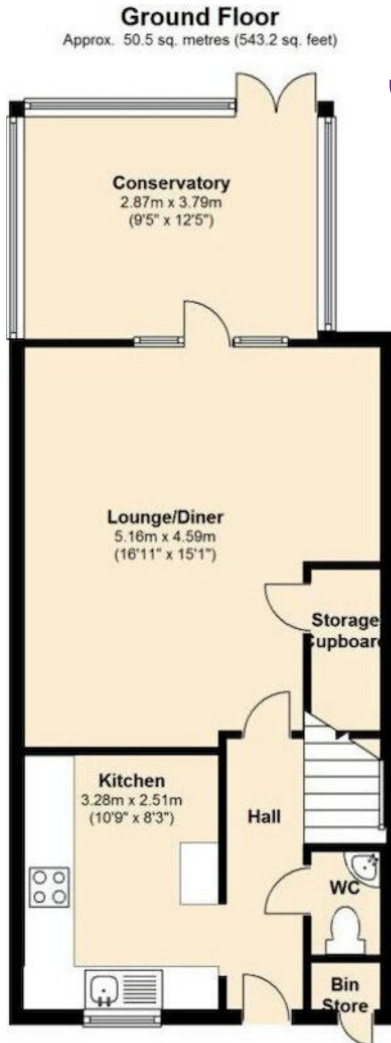

Total area: approx. 89.6 sq. metres (964.2 sq. feet)

Whilst every attempt has been made to ensure the accuracy of the floor plan, measurements are approximate and no responsibility is taken for any error or mis-statement. The plan is for illustrative purposes only.

Energy Efficiency Rating		Current	Potential
Very energy efficient - lower running costs			
(92+)	A		89
(81-91)	B		
(69-80)	C	76	
(55-68)	D		
(39-54)	E		
(21-38)	F		
(1-20)	G		
Not energy efficient - higher running costs			
England, Scotland & Wales		EU Directive 2002/91/EC	

