





17 Peak Close, Belper, Derbyshire DE56 1AL
£319,000 - Freehold



PROPERTY DESCRIPTION

Derbyshire Properties are delighted to present for sale this beautifully presented and spacious modern three storey town house occupying a quiet cul-de-sac location. The current owners have meticulously improved the property throughout adding a stunning kitchen and bespoke fixtures and fittings. The private location offers off street parking/garage and visitor parking. Belper town centre with all its amenities is also easy accessible on foot. We recommend the property would ideally suit your professionals and families and an early until inspection is essential to avoid missing out

POINTS OF INTEREST

- Stunning Modern Town House
- 4 Bedroom, 1 Reception Room
- Elevated Position With Beautiful Views
- Driveway & Garage
- Superb Master Suite With Dressing Room & En-Suite
- Beautiful Kitchen With Island
- Landscaped Rear Garden
- Quiet Cul De Sac Location
- View Absolutely Essential!
- COUNCIL TAX BAND D

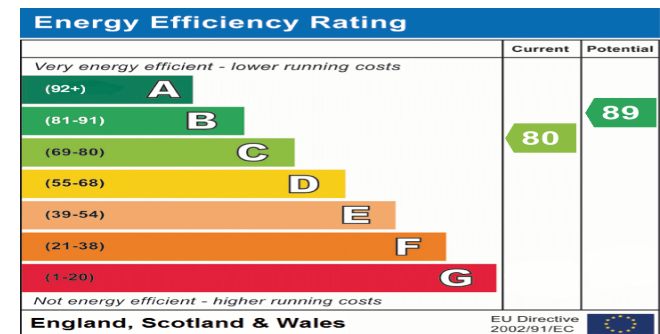

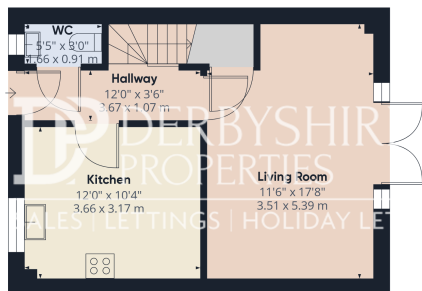

Ground Floor Building 1

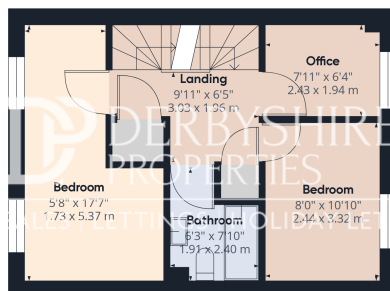

Floor 1 Building 1

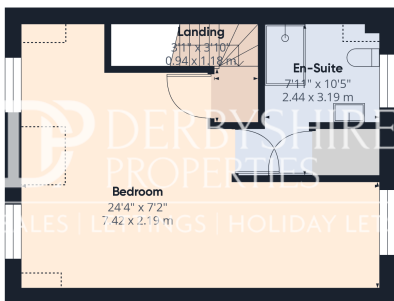

Floor 2 Building 1



Ground Floor Building 2

Approximate total area⁽¹⁾
1333.76 ft²
123.91 m²

Reduced headroom
19.88 ft²
1.85 m²

(1) Excluding balconies and terraces

Reduced headroom
..... Below 5 ft/1.5 m

While every attempt has been made to ensure accuracy, all measurements are approximate, not to scale. This floor plan is for illustrative purposes only.

Calculations are based on RICS IPMS 3C standard.

GIRAFFE360

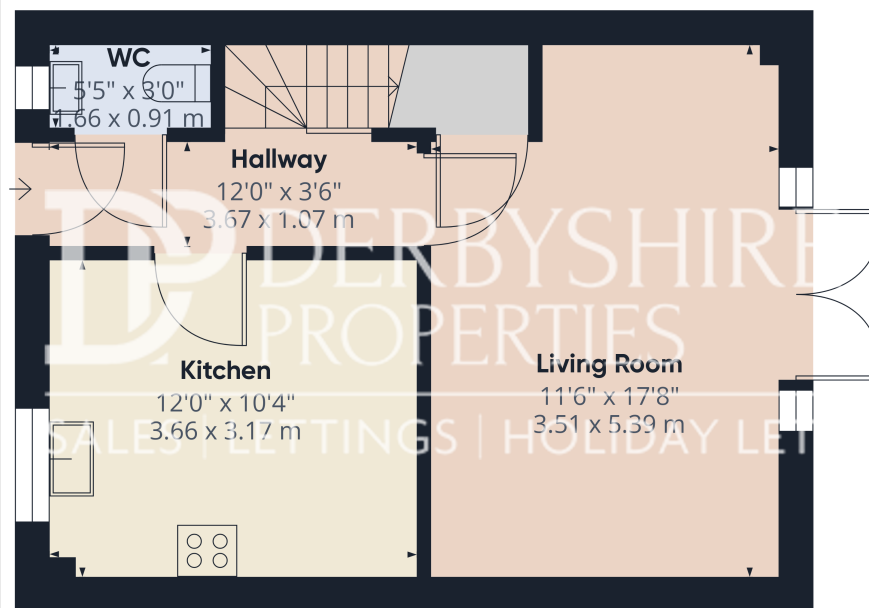

Ground Floor Building 1

Approximate total area⁽¹⁾
405.37 ft²
37.66 m²

(1) Excluding balconies and terraces

While every attempt has been made to ensure accuracy, all measurements are approximate, not to scale. This floor plan is for illustrative purposes only.

Calculations are based on RICS IPMS 3C standard.

GIRAFFE360