



Laleham Road, Staines-upon-Thames, Surrey, TW18 2NX

WELL PRESENTED & SPACIOUS THREE BEDROOM SEMI-DETACHED PROPERTY SITUATED ALONG THIS MUCH SOUGHT AFTER ROAD IDEALLY LOCATED FOR EASY ACCESS TO STAINES TOWN CENTRE, MAINLINE TRAIN STATION, LOCAL SHOPS & SCHOOLS. The property offers great scope for extension (S.T.R.P.P) and currently benefits from a spacious lounge/diner, separate fitted kitchen, three well-proportioned bedrooms, modern white bathroom suite, large secluded rear garden and off-street parking. Viewings Highly Recommended!

ROOM DESCRIPTIONS

FLOORPLAN

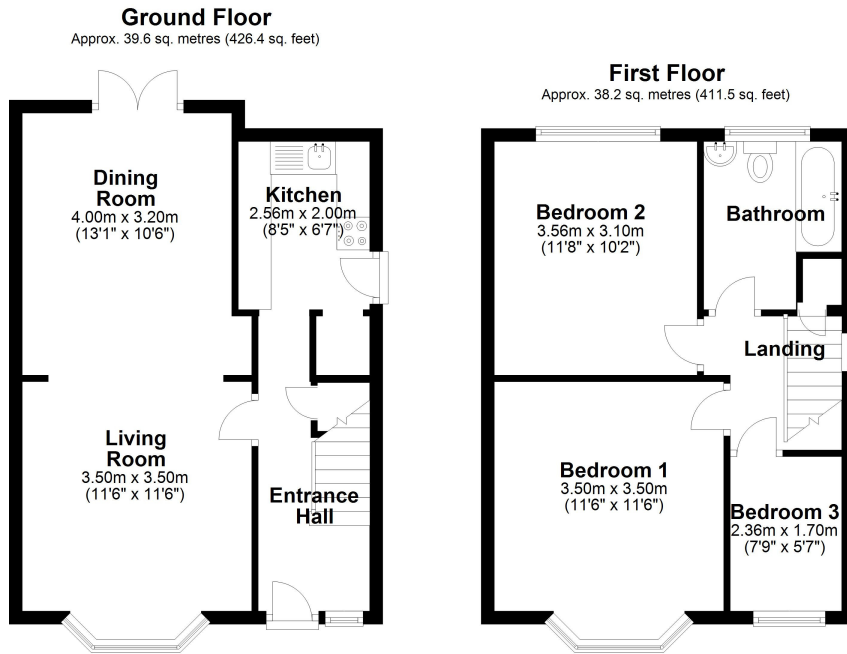

Total area: approx. 77.8 sq. metres (837.8 sq. feet)