

SOLD



Linnet Drive, Chelmsford
£315,000 Freehold

- **NO ONWARD CHAIN**
- **CONSERVATORY**
- **FAMILY BATHROOM**
- **GARAGE**
- **THREE BEDROOMS**
- **GAS CENTRAL HEATING BOILER**
- **CLOSE TO LOCAL SHOPS & OTHER AMENITIES**

NO ONWARD CHAIN

A well presented 3 bedroom property located in the ever popular Tile Kiln development and set within walking distance of local shops, Mildmay Junior School and other amenities. This property offers well proportioned accommodation comprising three bedrooms and a bathroom to the first floor, whilst the ground floor offers entrance porch, lounge leading through to separate dining room, refitted kitchen and a conservatory. There is both front and rear garden and a single garage.



Ground Floor

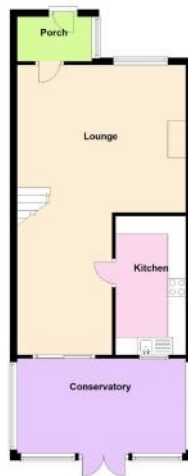

First Floor

