

# Silver Street

Cheddar, BS27 3LE

COOPER  
AND  
TANNER



**£360,000**

Set in a tucked away position and close to village amenities is this well proportioned two bedroom bungalow offer to the market with no onward chain. The property benefits from two bedrooms, ample living space, parking for multiple cars, front and rear gardens and an annexe which offers income opportunities.

# Silver Street Cheddar BS27 3LE

 2  2  1 EPC TBC

## £360,000

### DESCRIPTION

Set in a tucked away position and close to village amenities is this well proportioned two bedroom bungalow offer to the market with no onward chain. The property benefits from two bedrooms, ample living space, parking for multiple cars, front and rear gardens and an annexe which offers income opportunities.

Entering the property from the front you are immediately welcomed into the hall where there is access into all the rooms. The living room is immediately on the left and is a spacious room with an open fireplace. The kitchen is a rear aspect room and is fitted with a selection of wall and base units and has space for white appliances. There is access from the kitchen into the rear courtyard and a large window that provides far reaching countryside views. There are two large bedrooms, one at the front and one at the rear and both benefit from built in wardrobes. The family bathroom is fitted with a walk in shower, vanity sink and WC. There is also a handy hallway cupboard.

The property also benefits from owned solar panels.

### OUTSIDE

The property benefits from a large driveway which provides parking for multiple vehicles and is fully enclosed with wooden gates at the front. There artificial grass in front of the annexe which is wooden built and has its own shower room, kitchen area and space for a bed offering an array of opportunities. There is a enclosed by hedges turfed area just in front on the property and access into the rear courtyard which is laid to tarmac and enjoys far reaching views across open countryside.

### LOCATION

#### TENURE

Freehold

#### SERVICES

All mains services

#### EPC

TBC

#### COUNCIL TAX

Band D

#### VIEWINGS

Strictly by appointment only- Please call Cooper and Tanner

#### DIRECTIONS

From our office in Union Street, Cheddar, turn left and proceed along into Cliff Street until you come to a mini roundabout. Take the second exit, alongside The Riverside Inn, into The Bays and then turn immediately left into Birch Hill. Follow Birch Hill up the hillside to the top, turning left into Silver Street. Continue along Silver Street for approximately a quarter of a mile and the turning into Purdie Close will be seen on the right hand side, just after The Gardeners Arms and the bungalow is tucked in the corner.





GROUND FLOOR  
948 sq.ft. (88.0 sq.m.) approx.

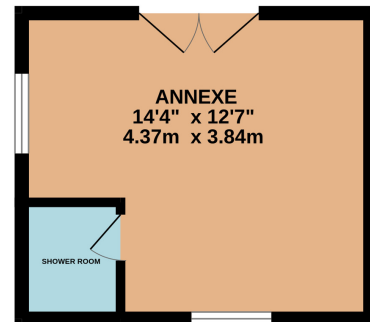
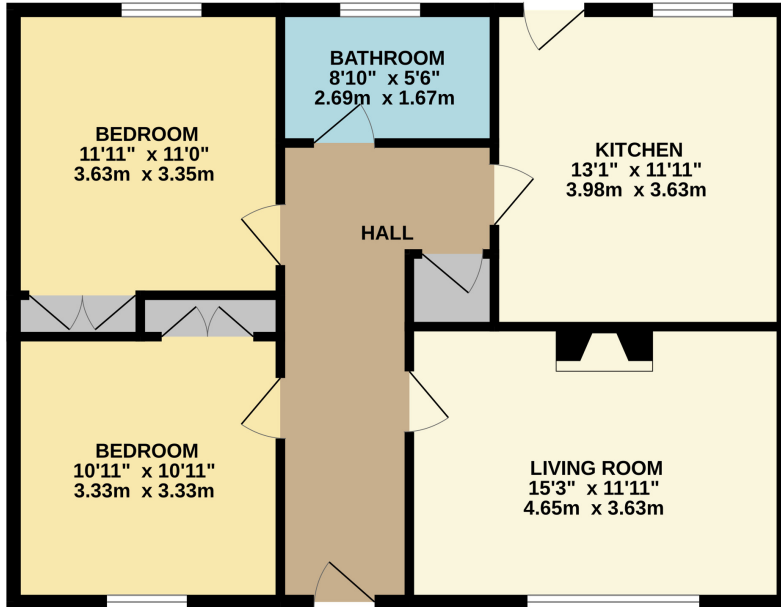

TOTAL FLOOR AREA : 948 sq.ft. (88.0 sq.m.) approx.

Whilst every attempt has been made to ensure the accuracy of the floorplan contained here, measurements of doors, windows, rooms and any other items are approximate and no responsibility is taken for any error, omission or mis-statement. This plan is for illustrative purposes only and should be used as such by any prospective purchaser. The services, systems and appliances shown have not been tested and no guarantee as to their operability or efficiency can be given.  
Made with Metroptx ©2024

CHEDDAR OFFICE

Telephone 01934 740055

Unit 2, Union Street, Cheddar, Somerset BS27 3NA

[cheddar@cooperandtanner.co.uk](mailto:cheddar@cooperandtanner.co.uk)

COOPER  
AND  
TANNER

Important Notice: These particulars are set out as a general outline only for the guidance of intended purchasers and do not constitute, nor constitute part of, an offer or contract. All descriptions, dimensions, reference to condition and necessary permissions for use and occupation, warranties and other details are given without responsibility and any intending purchasers should not rely on the m as statements or representations of fact but must satisfy themselves by inspection or otherwise as to the correctness of each of them.

