

# Truuli



## Clifton Road, London, SE25 6NL

£230,000 Leasehold

- Split level accommodation
- No onward chain
- Ready to move in condition
- Close to Selhurst and Thornton Heath Railway stations
- Plenty of internal storage
- Separate and large kitchen

Southbridge Place, Surrey, CR0 4HA

Tel: 0330 043 0002

Email: [save@truuli.co.uk](mailto:save@truuli.co.uk) Web: [www.truuli.co.uk](http://www.truuli.co.uk)

# Clifton Road, London, SE25 6NL

£230,000 Leasehold

Tucked away on the ever-popular Clifton Road, this well-presented split-level one-bedroom apartment offers an abundance of space, charm and practicality, the perfect blend for modern living.

Clifton Road

 = Reduced headroom below 1.5m / 5'0"

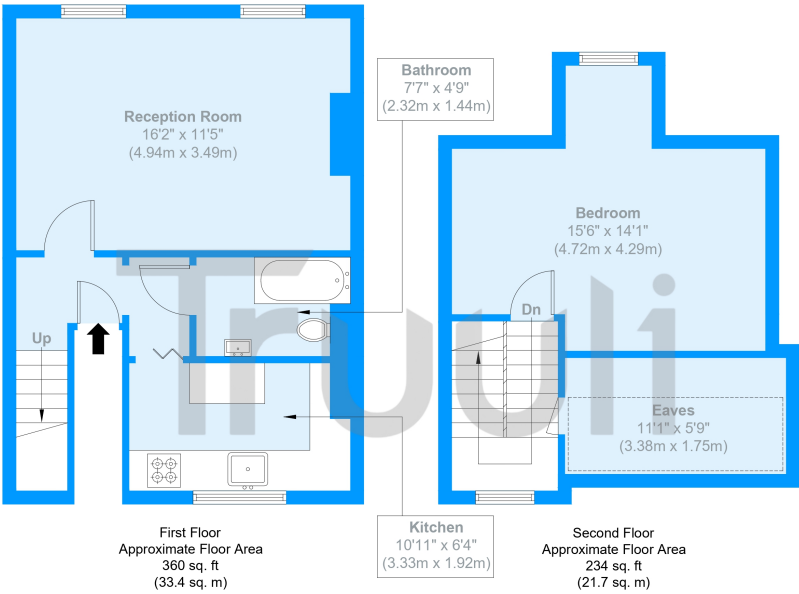

Approximate Gross Internal Area = 55.1 sq m / 593 sq ft  
Restricted head height / Eaves = 4 sq m / 43 sq ft  
Total = 59.1 sq m / 636 sq ft

The Floor plan is not to scale and measurements and areas shown are approximate and therefore should be used for illustrative purposes only. The plan has been prepared in accordance with the RICS code of Measuring Practice and whilst we have confidence in the information produced it must not be relied on. Maximum lengths and widths are represented on the floor plan. If there is any aspect of particular importance, you should carry out or commission your own inspection of the property.  
Copyright © BleuPlan

