



Day & Co
ESTATE AGENTS

28 Cavendish Street
Keighley
BD21 3RG



3 Valley View Close, Oakworth,
Keighley, West Yorkshire, BD22
7LZ

£140,000

T: 01535 664609

W: www.dayandcoestateagents.co.uk

E: keighley@dayandcoestateagents.co.uk

- MID TOWN HOUSE
- GAS CENTRAL HEATING & DOUBLE GLAZING
- NO CHAIN

- THREE BEDROOMS
- GARDENS & GARAGE
- EPC RATING D

SUMMARY

** MID TOWN HOUSE, THREE BEDROOMS, THROUGH LOUNGE/DINER, GAS CENTRAL HEATING, DOUBLE GLAZING, FRONT GARDEN, DECK REAR GARDEN, DISTANT VIEWS TO REAR, GARAGE, NO CHAIN, EPC RATING D **

FULL DESCRIPTION

Offered for sale is this Three bedroom, mid town house which has gardens, garage, enjoys distant views to the rear and benefits from both gas central heating and double glazing. In brief the accommodation comprises of an entrance porch, hall, through lounge/diner, kitchen. First Floor - Landing, Three bedrooms and a bathroom. No chain. EPC Rating D

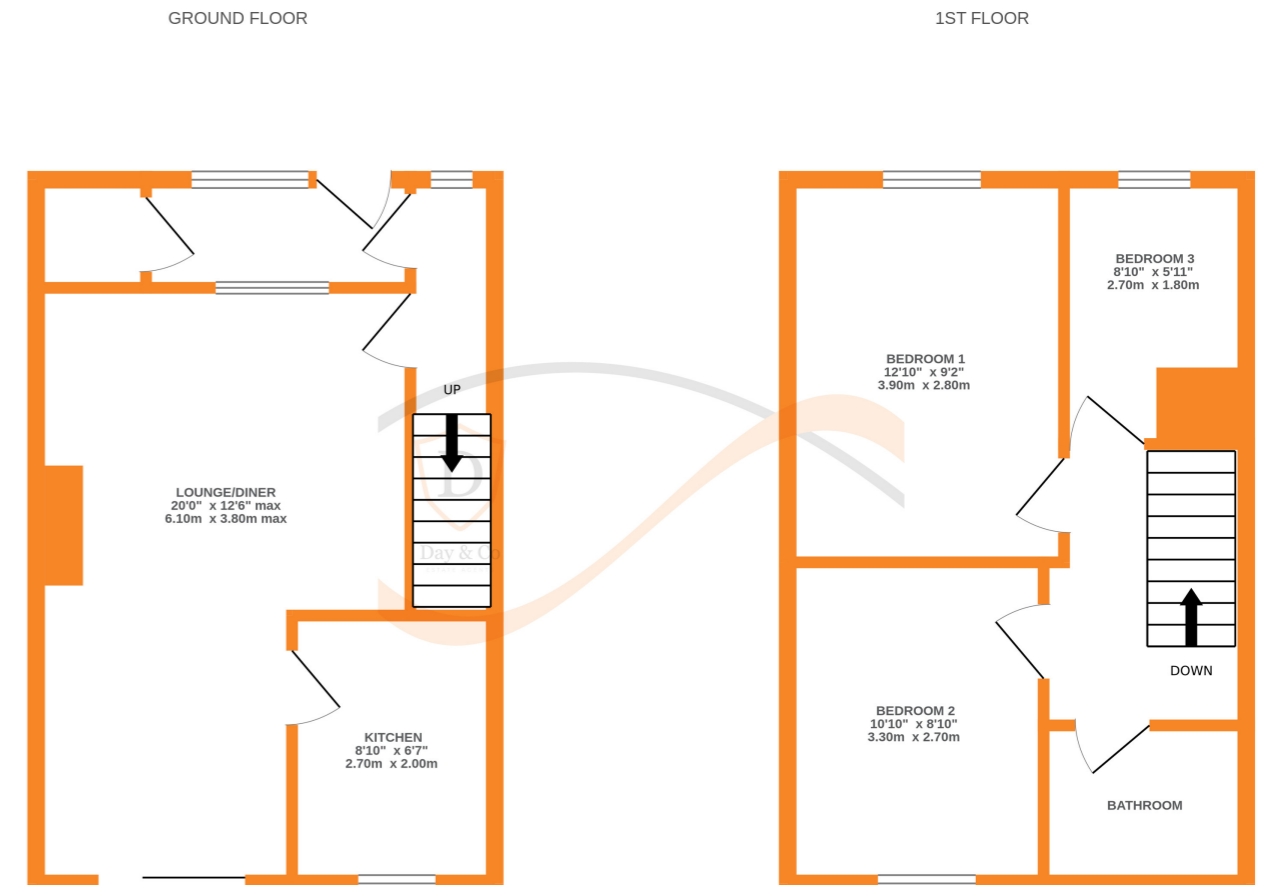

Whilst every attempt has been made to ensure the accuracy of the floorplan contained here, measurements of doors, windows, rooms and any other items are approximate and no responsibility is taken for any error, omission or mis-statement. This plan is for illustrative purposes only and should be used as such by any prospective purchaser. The services, systems and appliances shown have not been tested and no guarantee as to their operability or efficiency can be given.
Made with Metropix ©2024