



- Two Bedroom Home
- No Onward Chain
- Beautifully Presented Throughout
- South Facing Rear Garden
- Gas Central Heating
- Central Position
- Charming Period Features
- Living Room

## 6 Albert Place, Coggeshall, Colchester, Essex. CO6 1TZ.

Occupying a secluded position within the ever-sought-after Medieval market town of Coggeshall, known for its excellent array of boutique shops, pubs, and local eateries, is this quintessentially British two-bedroom cottage. New to the market and offered for sale with no onward chain, this well-established property has recently been renovated to an excellent standard whilst still retaining all of its original period features. Internally, the property comprises a living room with a feature cast iron fireplace, a county-style kitchen, a contemporary family bathroom, and two well-appointed double bedrooms. Externally, this character-filled home is further enhanced by having a south-facing rear garden. Please call Michaels Property Consultants for further details.



# Property Details.

## Living Room



11' 11" x 9' 8" (3.63m x 2.95m) Window to front, feature fireplace. Radiator.

## Kitchen



11' 10" x 9' (3.61m x 2.74m) Window to rear, fitted with a range of wall and base units and work surfaces. Stairs leading to the first floor, and access through to the rear lobby.

## Rear Lobby

Storage cupboard, door to rear garden. Radiator.

## Ground Floor Bathroom



Storage cupboard, door to rear garden. Radiator.

## Bedroom One



11' x 10' 8" (3.35m x 3.25m) Window to front, built-in wardrobes, feature fireplace. Radiator.

# Property Details.

## Bedroom Two



9' 2" x 9' (2.79m x 2.74m) Window to rear, airing cupboard with boiler. Radiator.

## Rear Garden



Path to rear gate, mainly lawned with flower bed borders.

# Property Details.

## Floorplans

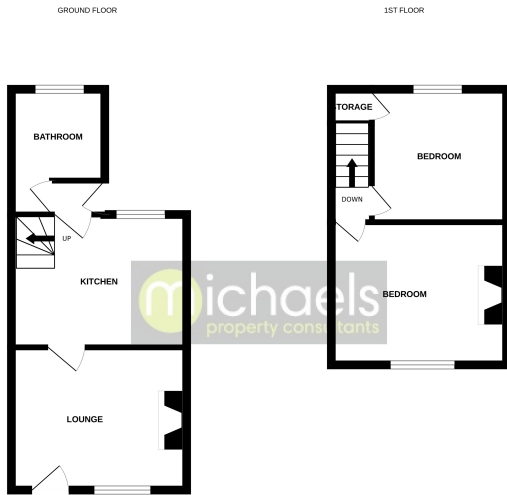

We have carried out a visual inspection of the property to ensure the accuracy of the floor plans contained herein. Measurements of spaces are given as an approximate guide only. We do not guarantee the accuracy of the measurements. We do not guarantee the accuracy of the floor plans. The accuracy of the floor plans is not guaranteed and no guarantee is made with respect to the same.

## Location

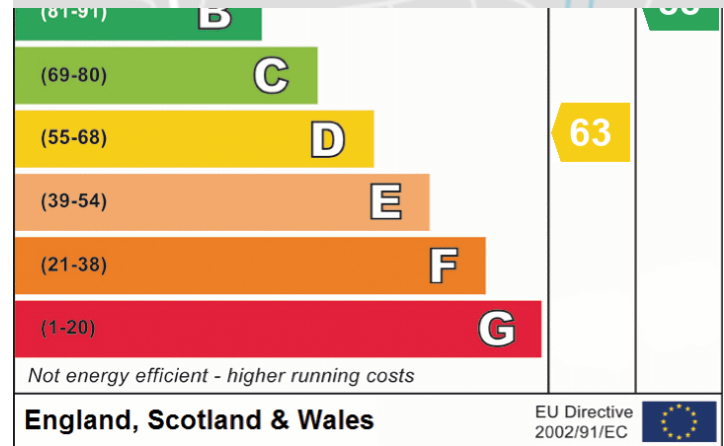
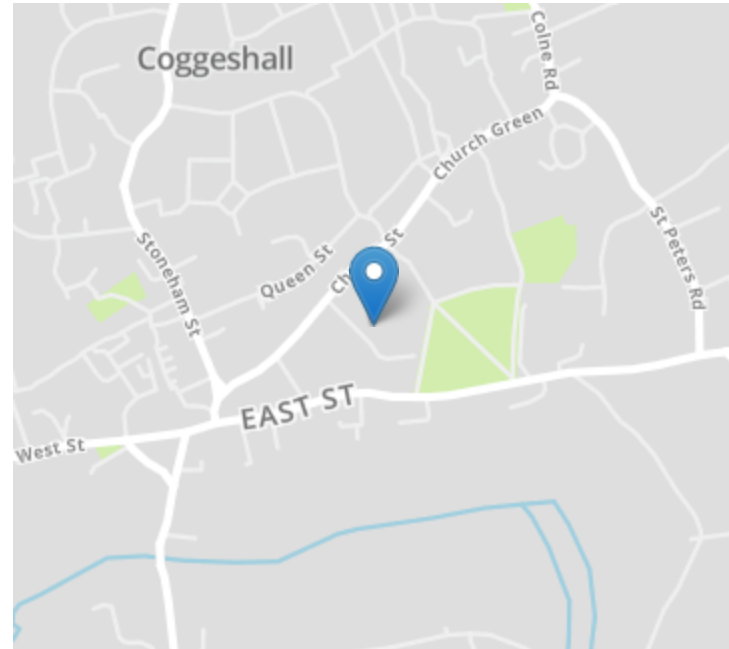

We have not carried out a structural survey and the services, appliances and specific fittings have not been tested. All photographs, measurements, floor plans and distances referred to are given as a guide only and should not be relied upon for the purchase of carpets or any other fixtures or fittings. Gardens, roof terraces, balconies and communal gardens as well as tenure and lease details cannot have their accuracy guaranteed for intending purchasers. Lease details, service ground rent (where applicable) are given as a guide only and should be checked and confirmed by your solicitor prior to exchange of contracts.