



Three Bedroom Terraced House
Merivale Grove, Walderslade, Chatham, Kent, ME5 8HP

£270,000
Freehold

Merivale Grove, Walderslade, Chatham, Kent, ME5 8HP

£270,000

Freehold

Description

Being offered with no forward chain. A great opportunity for the first time buyer to place your own creative stamp. Located in a popular cul-de-sac with good proximity to local schools and Walderslade Village shops and amenities.

The property itself comprises of a good size lounge and the kitchen/diner which offers a range of fitted wall and base units. Also the patio door leads out to the rear garden. Upstairs you have three good size bedrooms and a family bathroom. The outside space has a front garden and the rear garden is tiered with a large patio area. Also offered with garage and parking en bloc. Please call the Walderslade Sales Team for further details.

Key Features

- No Forward Chain
- Three Bedroom Terrace
- Kitchen/Diner
- Ideal First Time Purchase
- Place Your Own Creative Stamp
- Cul-De-Sac Position
- Garage En Bloc & Parking

Local Area

Walderslade is within reach of local primary and secondary schools, shopping parades, doctors surgery and dentist. Being close to Chatham and Maidstone town centres, Capstone Valley Ski and Snowboard Centre, Historic Rochester and Dockside centre plus Bluewater Shopping Centre being approximately 20 minutes away by car. The area offers good transport links to the A2/M2, M20 and M25 plus Ebbsfleet International and Ashford.

GROUND FLOOR
450 sq.ft. (41.8 sq.m.) approx.

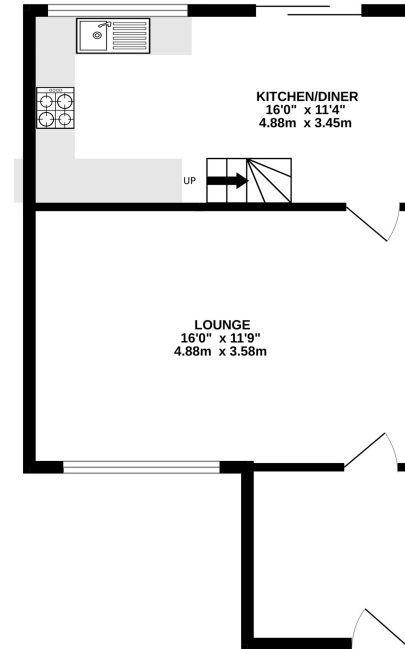

1ST FLOOR
385 sq.ft. (35.8 sq.m.) approx.

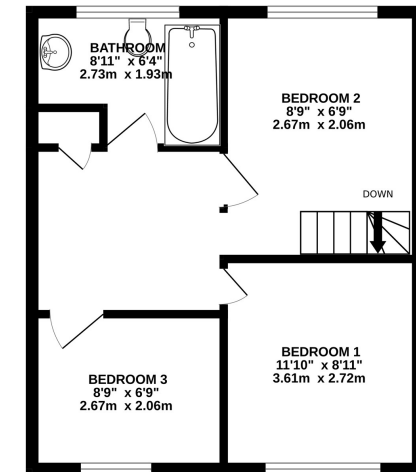

TOTAL FLOOR AREA : 835 sq.ft. (77.6 sq.m.) approx.

Whilst every attempt has been made to ensure the accuracy of the floorplan contained here, measurements of doors, windows, rooms and any other items are approximate and no responsibility is taken for any error, omission or mis-statement. This plan is for illustrative purposes only and should be used as such by any prospective purchaser. The services, systems and appliances shown have not been tested and no guarantee as to their operability or efficiency can be given.
Made with Metropix ©2025



Property Location

Merivale Grove, Walderslade, Chatham, Kent, ME5 8HP

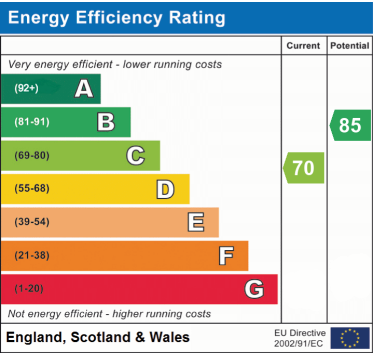
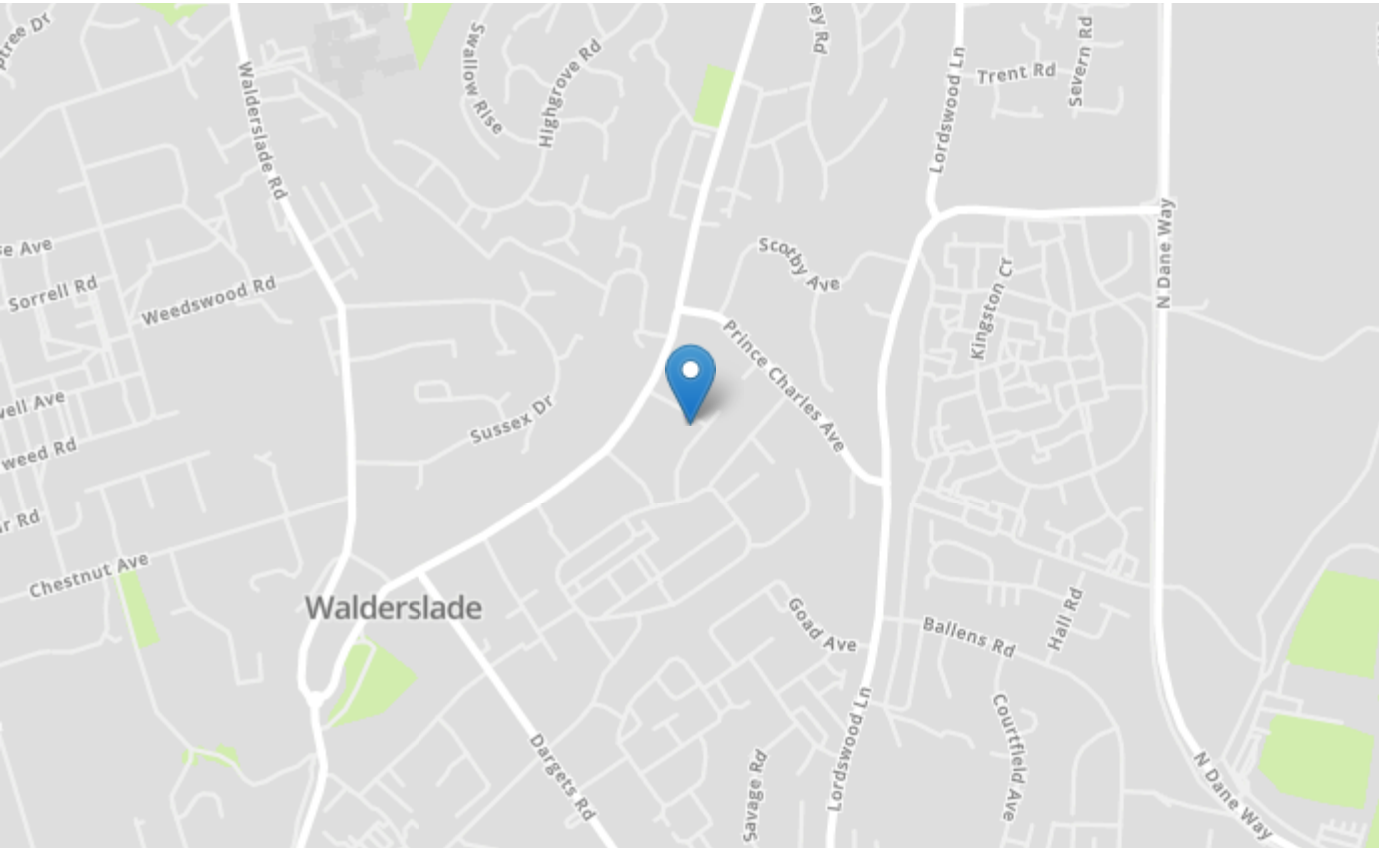

| | |
|-----------------|----------|
| Tenure | Freehold |
| Lease Term | N/A |
| Ground Rent | N/A |
| Service Charge | N/A |
| Local Authority | Medway |
| Council Tax | Band C |

Greyfox Walderslade

Unit 2, Thetford House
Walderslade Village Centre
Walderslade Road
Chatham
Kent
ME5 9LR
Tel: 01634 672227 Email:
walderslade@greyfox.co.uk

Greyfox Rainham

67C High Street
Rainham
Kent
ME8 7HS

Tel: 01634 377737 Email:
rainham@greyfox.co.uk

Agent Notes
These particulars are prepared as a general guide to a broad description of the property and should not be relied upon as a statement or representation of fact and do not constitute part of an offer or contract. The seller does not make or give nor do our employees or Greyfox have authority to make or give any representation or warranty to the property. We have not carried out a structural survey and the services, appliances and specific fittings have not been tested. All photographs, measurements, floorplans and distances referred to are given as a guide only and should not be relied upon for the purchase of carpets or any other fixtures or fittings. Lease details, service charges and ground rent (where applicable) and council tax are given as a guide only and should be checked and confirmed by you on inspection and your solicitor prior to exchange of contracts. If there are any points of particular importance to you we will be pleased to check the information for you and to confirm that the property remains available. This is particularly important should you be travelling some distance to view and where statements have been made by us to the effect that the information has not been verified. The copyright of all details, photographs and floorplans remain exclusive to Greyfox. For details of our privacy policy and referral fee arrangements with any of our selected partner companies please visit <https://www.greyfox.co.uk/legal/privacy> and <https://www.greyfox.co.uk/referral-fees>.