



Day & Co
ESTATE AGENTS

28 Cavendish Street

Keighley

BD21 3RG



1b Elm Street, Oxenhope,
Keighley, West Yorkshire, BD22
9JL

£149,995

T: 01535 664609

W: www.dayandcoestateagents.co.uk

E: keighley@dayandcoestateagents.co.uk

- END STONE TERRACE, TWO BEDROOMS
 - GAS CENTRAL HEATING & DOUBLE GLAZING
 - ENCLOSED REAR PATIO YARD
- LOUNGE & DINING KITCHEN
 - LARGE CELLAR

SUMMARY

** Delightful Stone Built End Terrace, Two Bedrooms, Lounge & Dining Kitchen, Large Cellar, Enclosed Patio Yard, Gas Central Heating, Double Glazing, Viewing Advised, Awaiting EPC **

FULL DESCRIPTION

Of interest to a variety of buyers is this delightful, two bedroom end terrace, situated in the sought after village location of Oxenhope with excellent access to the local primary school and village amenities. The accommodation comprises of an entrance with side entrance door, lounge with double glazed window to the side, wooden flooring. Stove is only ornamental as its not working. Dining kitchen with a range of units double glazed window to the rear, door leading to a large cellar, rear entrance vestibule with rear door. First floor landing. Bedroom 1 has a built in wardrobe, double glazed window to the side. Bedroom 2 is a good size also with double glazed window to the side. The shower room comprises of a shower, WC, wash hand basin and double glazed window. Gas central heating & Double glazing. Externally there is an enclosed rear patio yard. Street parking. Awaiting EPC

BASEMENT

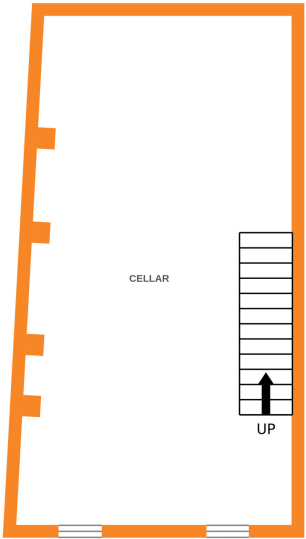

GROUND FLOOR

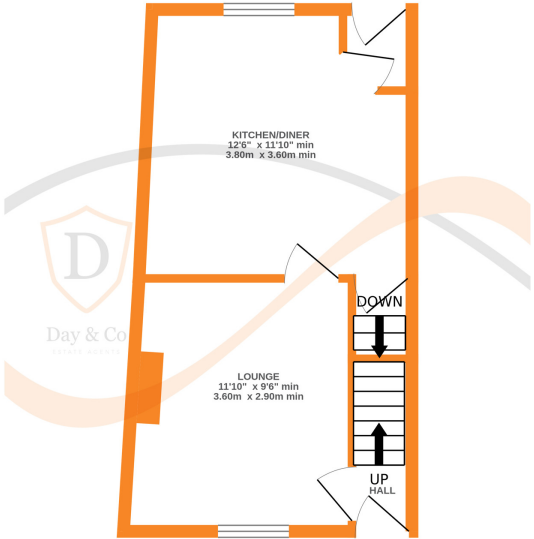

1ST FLOOR

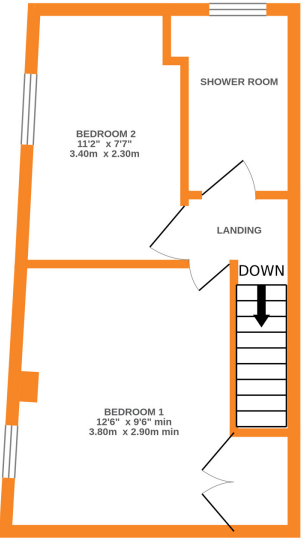

Whilst every attempt has been made to ensure the accuracy of the floorplan contained here, measurements of doors, windows, rooms and any other items are approximate and no responsibility is taken for any error, omission or mis-statement. This plan is for illustrative purposes only and should be used as such by any prospective purchaser. The services, systems and appliances shown have not been tested and no guarantee as to their operability or efficiency can be given.
Made with Metropix ©2026