



94 Medworth, Orton Goldhay, Peterborough. PE2 5RY

£165,000 Freehold

Investors only for this end terraced house located in the popular area of Orton Goldhay. The tenants have lived in the property for eight years and are very settled and want to stay. The property comprises of entrance hall, kitchen/diner, living room, first floor landing leading to three bedrooms, bathroom with separate toilet, airing cupboard housing the Valliant boiler which is serviced annually. Outside there is an enclosed rear garden with a side gate. Communal parking to the front of the property. The current tenants are paying £700 a month rent.



FLOORPLAN, FEATURES & EPC

Ground Floor

Approx. 41.1 sq. metres (442.9 sq. feet)

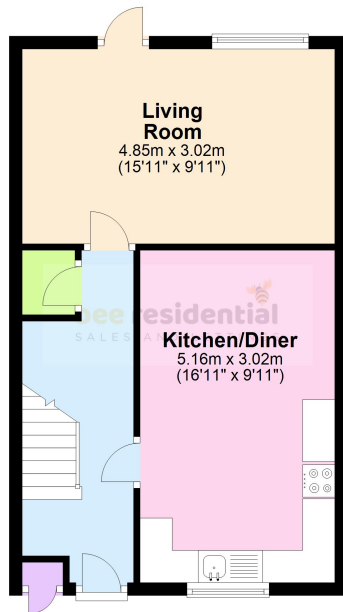

First Floor

Approx. 40.5 sq. metres (436.3 sq. feet)

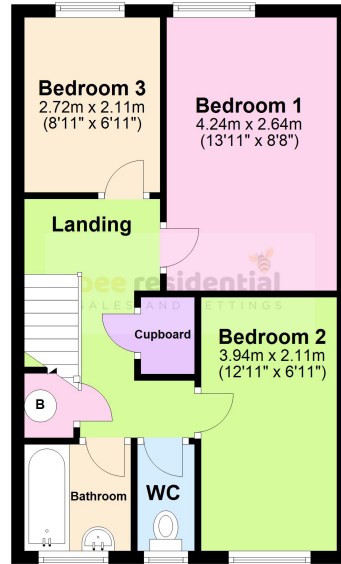

Total area: approx. 81.7 sq. metres (879.2 sq. feet)

The dimensions shown on our floor plans are approximate as each home is individually built, the precise measurements may vary although we endeavour to make the information as accurate as possible. Consequently these particulars should be treated as general guidance only and do not constitute a contract or warranty.
Plan produced using PlanUp.

- INVESTORS ONLY
- TENANTS IN-SITU
- VALLIANT BOILER SERVICED ANNUALLY
- GAS CENTRAL HEATING

- uPVC DOUBLE GLAZING
- COMMUNAL PARKING
- KITCHEN/DINER
- CLOSE TO LOCAL AMENITIES

