



11a High Street, Langford, Bedfordshire, SG18 9RP

£395,000

Extended and well presented four bedroom end of terrace town house situated in the heart of the village within walking distance of local amenities and countryside walks. The downstairs accommodation has recently been extended to offer an open plan, re-fitted kitchen/dining room/lounge and cloakroom. On the first floor there are three good size bedrooms plus a family bathroom, while the spacious master bedroom is on the second floor complete with en-suite. Outside off road parking is provided via a block paved courtyard to the rear as well as a powered garage in block. The property is located within easy reach of the A1 motorway and local train stations and is available chain free.



## 11a High Street

Approximate Gross Internal Area  
1300 sq ft - 121 sq m

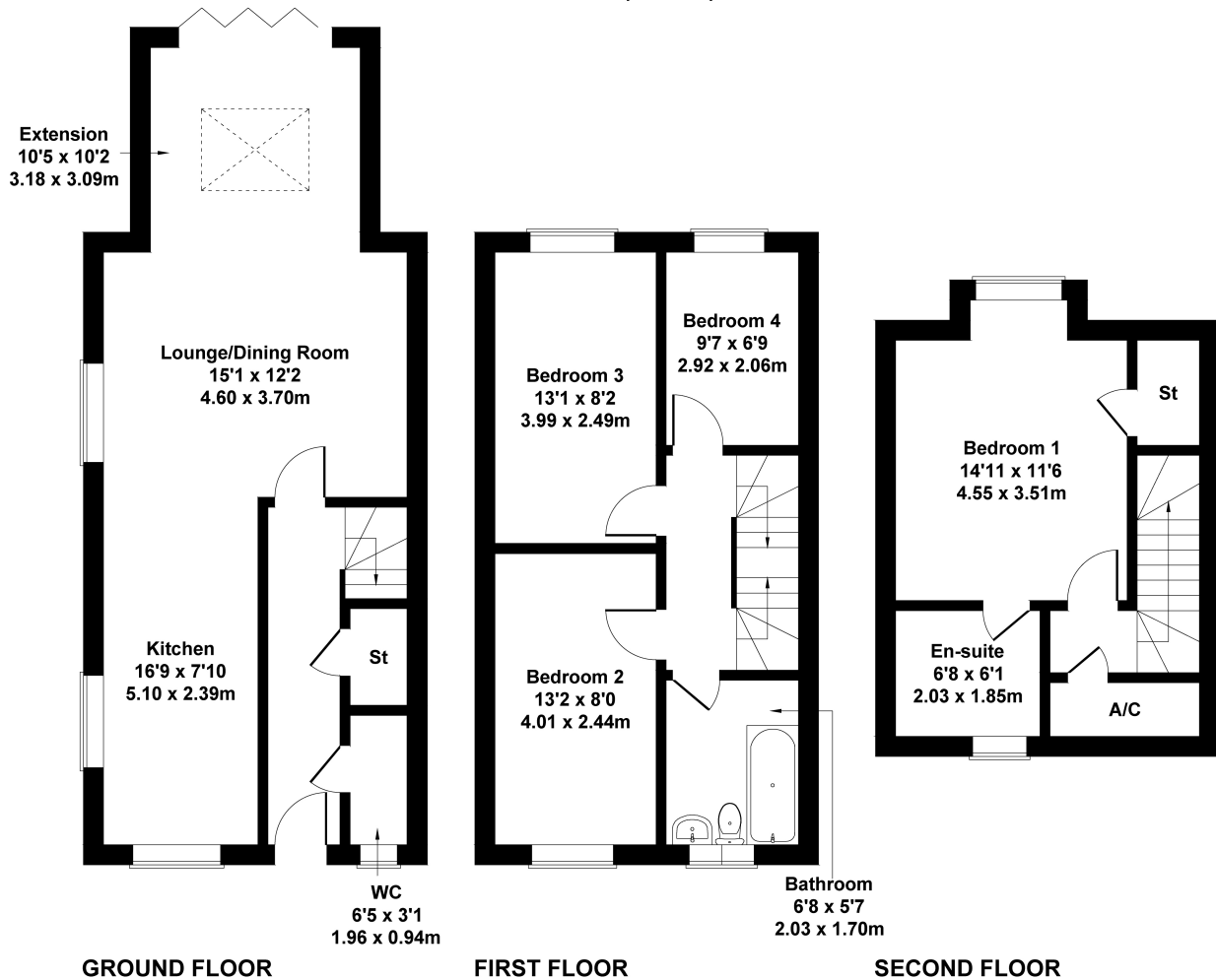

Not to Scale. Produced by The Plan Portal 2022  
For Illustrative Purposes Only.

- WELL PRESENTED END TERRACE FAMILY HOME
- FOUR GOOD SIZED BEDROOMS
- EXTENDED GROUND FLOOR ACCOMMODATION
- OPEN PLAN KITCHEN/DINING ROOM/LOUNGE
- RE-FITTED KITCHEN WITH BUILT IN APPLIANCES
- CLOAKROOM, BATHROOM & EN-SUITE
- GARAGE & PARKING TO REAR
- EASY ACCESS TO A1 + TRAIN STATION
- COUNTRYSIDE WALKS ON YOUR DOORSTEP
- AVAILABLE CHAIN FREE

