

22 John Harrison Way, Greenwich, LONDON, SE10 0GJ

£1,900 PCM

A wonderful opportunity to rent an appealing two bedroom apartment set on the banks of the river Thames and only minutes on foot to the shops, bars and restaurants of the upper riverside O2 district. Presented in excellent condition throughout with access to the Aperture residents villa set over five impressive floors of the latest technology in gym and spa. 24 hour concierge.

Viewing by appointment with 1st avenue.

Call: 020 8293 8600

1st avenue, 128 Metcalfe Court, West Parkside, London SE10 0EL
email: info@1stavenue.co.uk

22 John Harrison Way, Greenwich, **£1,900 PCM** LONDON, SE10 0GJ

1stavenue
Real Estate Services

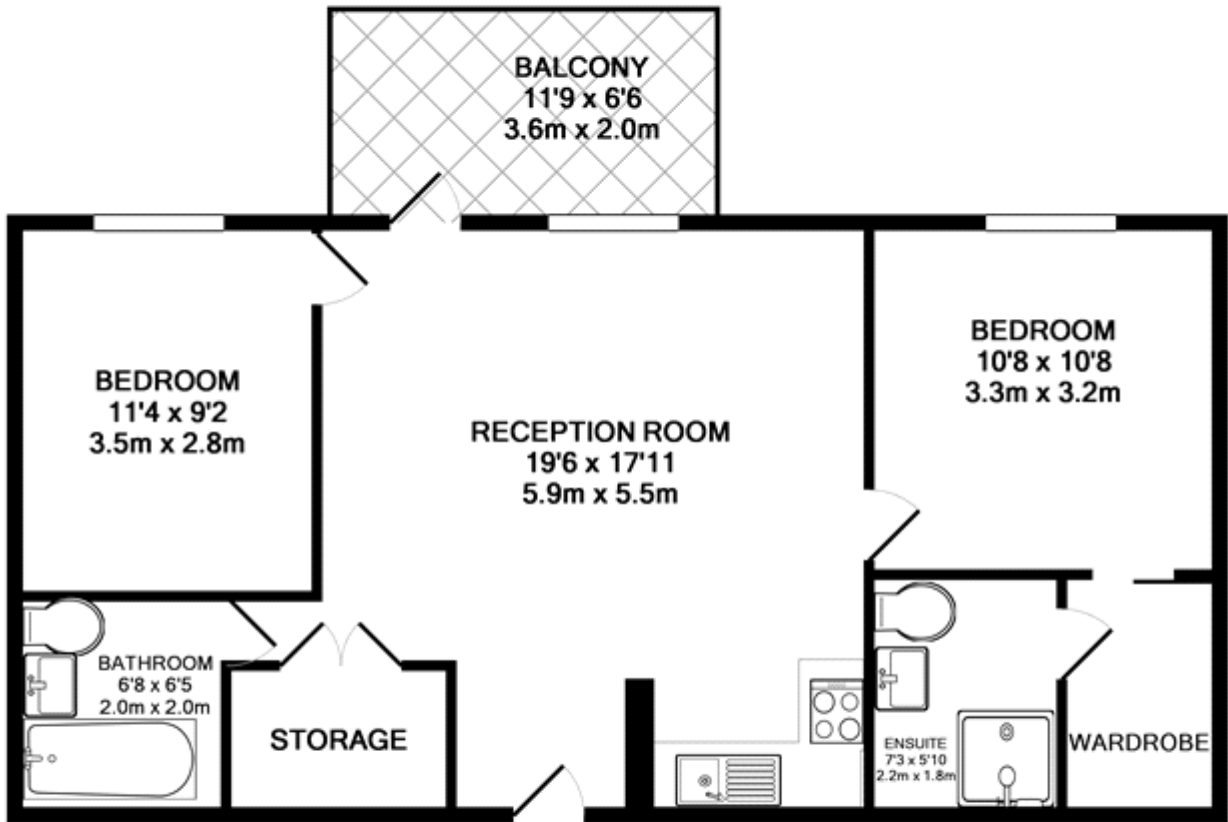

TOTAL APPROX. FLOOR AREA 655 SQ.FT. (60.9 SQ.M.)

Whilst every attempt has been made to ensure the accuracy of the floor plan contained here, measurements of doors, windows, rooms and any other items are approximate and no responsibility is taken for any error, omission, or mis-statement. This plan is for illustrative purposes only and should be used as such by any prospective purchaser. The services, systems and appliances shown have not been tested and no guarantee as to their operability or efficiency can be given

Made with Metropix ©2019

Viewing by appointment with 1st avenue.

Call: 020 8293 8600

1st avenue, 128 Metcalfe Court, West Parkside, London SE10 0EL
email: info@1stavenue.co.uk

1stavenue
Real Estate Services