



6 Council Houses, Heath House, Wedmore BS28 4UJ

£499,950 Freehold

COOPER
AND
TANNER



6 Council Houses, Heath House Wedmore BS28 4UJ

 4  3  1 EPC D

£499,950 Freehold

Description

Located in a quiet hamlet outside popular Wedmore, this surprisingly spacious four bedroom family home, has been cleverly extended and updated to incorporate bright living and family rooms and a large kitchen/diner.

Entrance to the property is by a side door where the hallway leads to the kitchen, utility and family room. The remodelled kitchen spans the width of the house and has oak base and wall cupboards, an island unit and a chimney recess with space for a range cooker. There is a separate utility room leading onto a cloakroom and to the rear of the house there is a study, currently used for storage, and a family room leading onto the light-filled, contemporary living room with pyramid ceiling, light Kardean wood effect flooring, modern wood burner and tri-fold doors opening onto the garden and outdoor seating area.

There are two double and two single bedrooms upstairs and a family bathroom which is fully tiled with corner bath and shower over.

Outside

The front and side of the property has large gravelled areas allowing for plenty of off road parking. To the rear, the level gardens offer a patio seating and dining area, perfect for barbeques, a lawned area and mature trees to the rear of the garden. The rear gardens are fenced and there is space for sheds and further storage to the side of the house. A gate to the rear of the garden opens onto an access lane for use by Council House owners.









Location

Heath House is a small hamlet located approximately 1.5 miles from Wedmore. Wedmore is a thriving village set on a high ridge above the Somerset Levels with a rich history and architectural heritage. Established in Saxon times, the modern-day Wedmore is an exciting social and commercial rural centre with a wide range of retail and leisure facilities including a selection of boutique shops. Day to day amenities include a newsagents/general stores, chemist, a butcher shop, delicatessen, post office, fishmongers, grocers, a range of eateries, 2 public houses. A lively and friendly community, Wedmore hosts over 70 organisations with a diversity of cultural and sporting activities including opera, theatre, parkland golf course, floodlit all weather tennis courts, indoor and outdoor bowling greens and both cricket and football pitches.

There is a community run bus service to the larger nearby towns and the property falls within the popular catchment area for Wedmore First School, Hugh Sexey Middle School and Kings of Wessex Academy and Sixth Form.

Directions

From the Cooper and Tanner office head up Church Street toward Blackford and turn left opposite the school as you leave the village then turn right onto Heath House Road. Continue over the crossroads at Wellsway/Sand Road and the row of Council Houses is on your right side after approximately half a mile.



Local Information Heath House, Wedmore

Local Council: Sedgemoor

Council Tax Band: B

Heating: Oil central heating

Services: Mains electric and water, private drainage

Tenure: Freehold



Motorway Links

- M5



Train Links

- Highbridge & Burnham Train Station



Nearest Schools

- Wedmore First School
- Hugh Sexey Middle School
- Kings of Wessex Academy

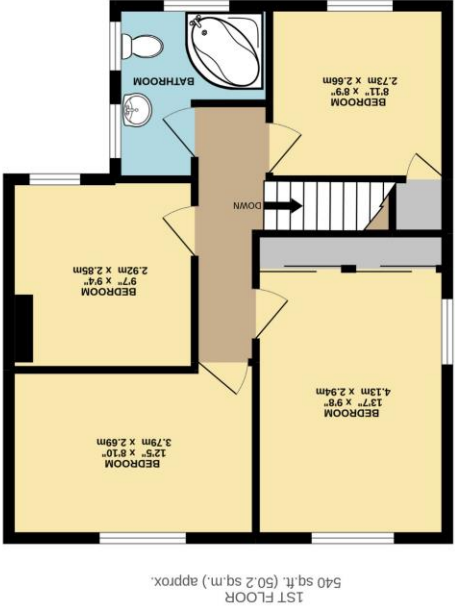
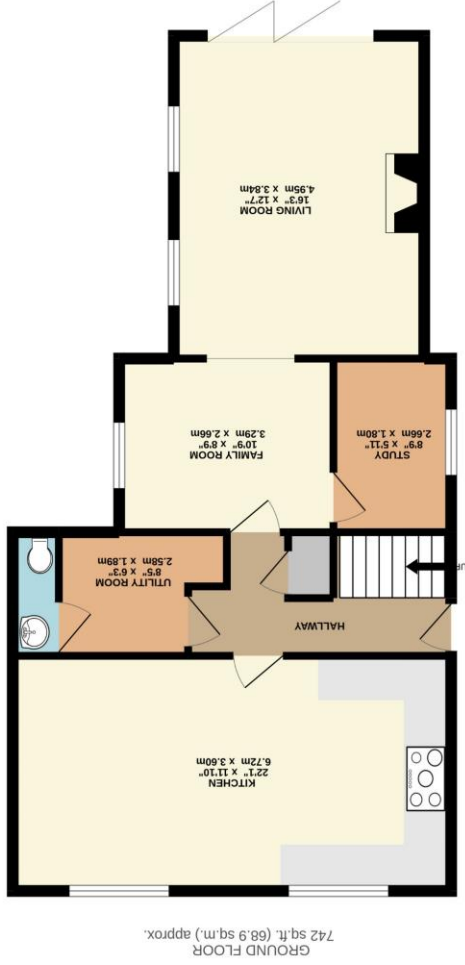

Whilst every attempt has been made to ensure the accuracy of the floorplan contained here, measurements of doors, windows, rooms and other areas are approximate and no responsibility is taken for any error, omission or mis-statement. The plan is for illustrative purposes only and should be used as such by any prospective purchaser. The services, systems and appliances shown have not been tested and no guarantee as to their operability or efficacy can be given.

Made with Metagix ©2022

WEDMORE OFFICE
 telephone 01934 713296
 Providence House, The Borough, Wedmore, Somerset BS28 4EG
 wedmore@cooperandtanner.co.uk

COOPER
 AND
 TANNER



Important Notice: These particulars are set out as a general outline only for the guidance of intended purchasers and do not constitute, nor constitute part of, an offer or contract. All descriptions, dimensions, reference to condition and necessary permissions for use and occupation, warranties and other details are given without responsibility and any intending purchasers should not rely on them as statements or representations of fact but must satisfy themselves by inspection or otherwise as to the correctness of each of them.