



Two Bedroom Terraced House
Alexandra Glen, Chatham, Kent, ME5 9EB

Offers Over £270,000
Freehold

Alexandra Glen, Chatham, Kent, ME5 9EB

Offers Over £270,000

Freehold

Description

No chain! This terrace house is situated in the popular Walderslade Woods area and is convenient for motorway access and local walks. A great purchase for a first time buyer or investor. The property is in excellent order throughout and we understand from the vendor that the boiler has been installed in the last few months and radiators were also new at that time.

There is a covered porch area to the front. Accommodation comprises: entrance hall with staircase to first floor and an understair cupboard. The kitchen faces to the front aspect with a range of units and the recently installed boiler. The lounge is bright and airy and has French doors opening onto the rear garden which has a lawn and patio area. Upstairs are two double bedrooms and a bathroom. There is an allocated parking space close to the property

Key Features

- Two Double Bedrooms
- Walderslade Woods
- Terrace House
- No Chain
- Excellent order throughout
- Allocated parking space
- M2/ M20 motorway links nearby

Local Area

Walderslade Woods is within reach of Tunbury local primary school along with a variety of secondary schools, shopping parades, doctors surgery, dentist and chiropodist. The area offers good transport links to the A2/M2 M20 and M25. It is close to Chatham and Maidstone town centres as well as railways links. Ebbsfleet International is approximately 15 minutes away by car.

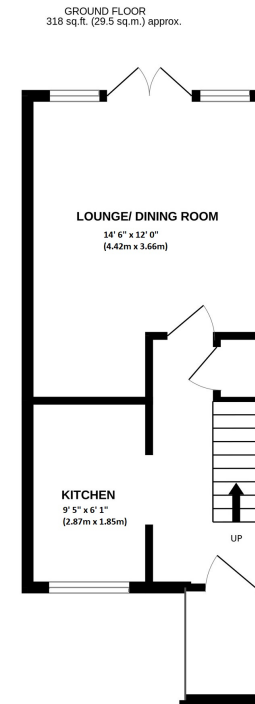

1ST FLOOR
295 sq.ft. (27.4 sq.m.) approx.

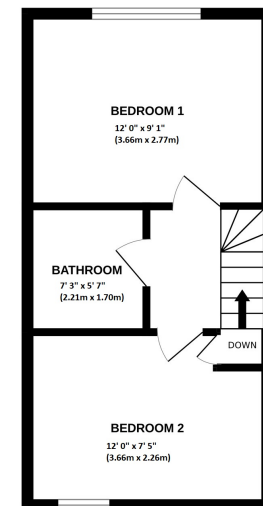

TOTAL FLOOR AREA : 612 sq.ft. (56.9 sq.m.) approx.

Whilst every attempt has been made to ensure the accuracy of the floorplan contained here, measurements of doors, windows, rooms and any other items are approximate and no responsibility is taken for any error, omission or mis-statement. This plan is for illustrative purposes only and should be used as such by any prospective purchaser. The services, systems and appliances shown have not been tested and no guarantee as to their operability or efficiency can be given.
Made with Metropix ©2024



Property Location

Alexandra Glen, Chatham, Kent, ME5 9EB

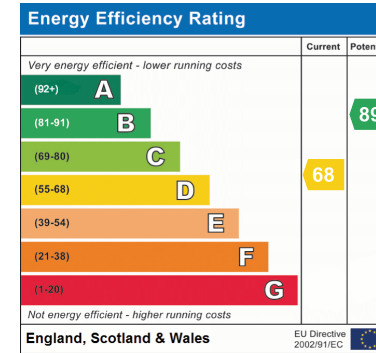
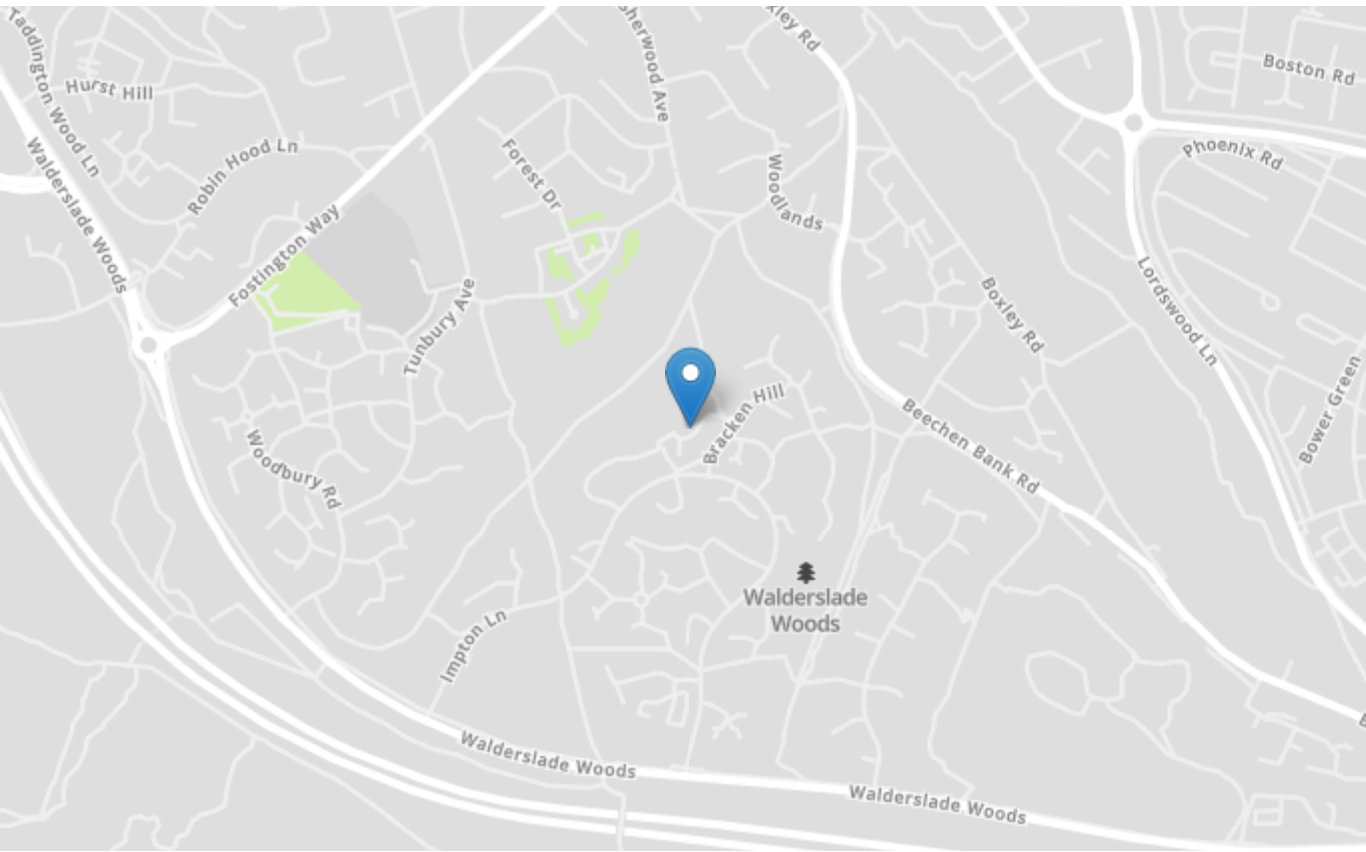

Tenure	Freehold
Lease Term	N/A
Ground Rent	N/A
Service Charge	N/A
Local Authority	Maidstone
Council Tax	Band C

Greyfox Walderslade

Unit 2, Thetford House
Walderslade Village Centre
Walderslade Road
Chatham
Kent
ME5 9LR
Tel: 01634 672227 Email:
walderslade@greyfox.co.uk

Greyfox Rainham

67C High Street
Rainham
Kent
ME8 7HS
Tel: 01634 377737 Email:
rainham@greyfox.co.uk

Agent Notes

These particulars are prepared as a general guide to a broad description of the property and should not be relied upon as a statement or representation of fact and do not constitute part of an offer or contract. The seller does not make or give nor do our employees or Greyfox have authority to make or give any representation or warranty to the property. We have not carried out a structural survey and the services, appliances and specific fittings have not been tested. All photographs, measurements, floorplans and distances referred to are given as a guide only and should not be relied upon for the purchase of carpets or any other fixtures or fittings. Lease details, service charges and ground rent (where applicable) and council tax are given as a guide only and should be checked and confirmed by you on inspection and your solicitor prior to exchange of contracts. If there are any points of particular importance to you we will be pleased to check the information for you and to confirm that the property remains available. This is particularly important should you be travelling some distance to view and where statements have been made by us to the effect that the information has not been verified. The copyright of all details, photographs and floorplans remain exclusive to Greyfox. For details of our privacy policy and referral fee arrangements with any of our selected partner companies please visit <https://www.greyfox.co.uk/legal/privacy> and <https://www.greyfox.co.uk/referral-fees>.