



HILTON KING & LOCKE
SPECIALISTS IN PROPERTY



Swallow Fields, Iver Heath, Buckinghamshire. SL0 0DQ.

£875,000 Freehold

FOUR BEDROOM DETACHED

***TWO RECEPTION ROOMS PLUS
KITCHEN/BREAKFAST ROOM***

GARAGE OWN DRIVE

PRIVATE REAR GARDEN

CUL-DE-SAC LOCATION

An exceptional, bright and airy detached home ideally situated on the quiet and highly sought after Swallow Fields development in Iver Heath.

This attractive four bedroom family home offers 1555 square ft of accommodation, plus a private rear garden and a garage.

The ground floor includes a 16'2 x 16'5 rear aspect living room with french doors leading to the garden, a front aspect dining room, a 12'6 x 10'4 kitchen/breakfast room which has a door leading to the garden, and has space for a table and chairs. Completing the ground floor is a utility room and a cloakroom.

Upstairs are four well proportioned bedrooms. The master bedroom is 14'2 x 9'10 and has built in double wardrobes with its own ensuite, while bedroom two is an impressive 22'11 x 9'7 and offers a lovely double aspect. Bedroom three measures 12'7 x 9' and has a



bay fronted window, while bedroom four overlooks the rear garden. There is also a family bathroom.

The front drive offers ample off street parking on a block paved drive, and the rear garden is private and well stocked with a large patio while being mainly laid to lawn.

Location

Swallow Fields is a popular residential road situated within sought after Iver Heath, the home of Pinewood Studios and a range of schools, recreational facilities and local shopping amenities. The larger centres of Uxbridge and Gerrards Cross provide a wider range of shopping facilities. Central London is easily accessible by road via the A40, M40 (J1A) and M25 (J16) plus access to Heathrow and Gatwick Airports. Buckinghamshire is renowned for its education system, with an excellent choice of Grammar, state and independent schools.



Important Notice

Particulars: These particulars are not an offer or contract, nor part of one. You should not rely on statements by Hilton King & Locke Ltd in the particulars or by word of mouth or in writing (‘information’) as being factually accurate about the property, its condition or its value. Hilton King & Locke Ltd does not have any authority to make any representations about the property, and accordingly any information given is entirely without responsibility on the part of the agents, seller(s) or lessor(s).

Photographs etc: The photographs show only certain parts of the property as they appeared at the time they were taken. Areas, measurements and distances given are approximate only.



23 High Street
Iver Buckinghamshire SL0 9ND

Tel: 01753 650033
iver@hklhome.co.uk

Ground Floor
Approx. 79.1 sq. metres (851.6 sq. feet)



HILTON KINGS & LOCKE

SPECIALISTS IN PROPERTY

First Floor
Approx. 65.4 sq. metres (704.2 sq. feet)

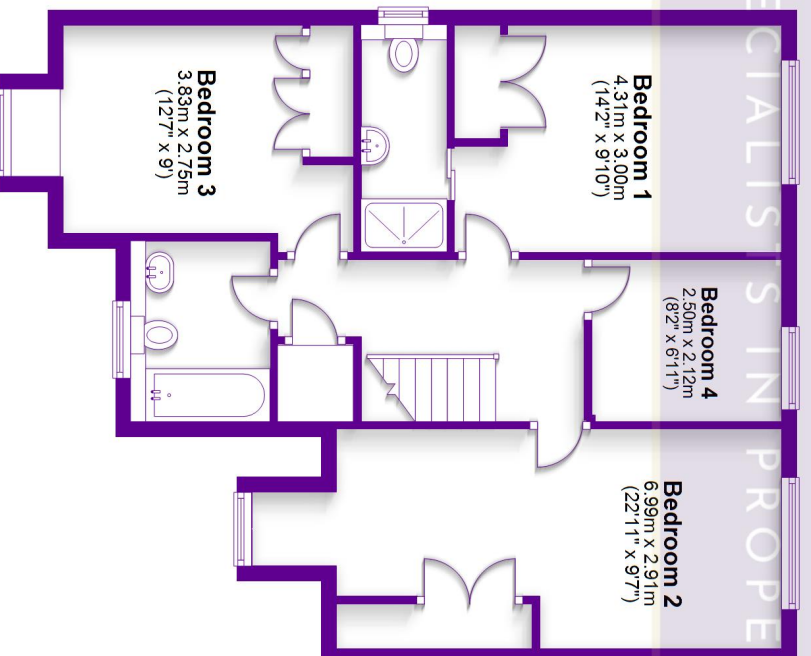

Total area: approx. 144.5 sq. metres (1555.8 sq. feet)

FOR ILLUSTRATIVE PURPOSES ONLY - NOT TO SCALE
The position and size of doors, windows, appliances and other features are approximate only.
© My Home Property Marketing - Unauthorised reproduction prohibited.
Plan produced using PlanUp.