



Apartment 14 Hornbeam House, London, 22 Quebec Way SE16 7EW

A spectacular third floor, triple aspect, three double bedroom, three bathroom stylish apartment extending over 1,235 sq ft with generous private balcony and concierge facilities located within Quebec Quarter, a modern development located moments from Canada Water station [Jubilee Line & Overground], Surrey Quays shopping centre and Stave Hill Ecological Park.

This impressive 1,235 sq ft triple aspect apartment comprises entrance area with utility/storage cupboard, impressive reception room with dining area, floor to ceiling windows, door to generous private balcony, stylish open plan fitted kitchen with stone work tops and integrated appliances, master bedroom with en-suite shower room, guest bedroom two with en-suite bathroom, bedroom three with door to terrace and family shower room. Residents of Hornbeam House have the benefit of access to landscaped communal gardens and concierge facilities. Secure allocated parking available under separate negotiation. Canada Water station [Jubilee & Overground] is moments away together with Surrey Quays shopping centre and Stave Hill Ecological Park. EWS1 Compliant.

- Hornbeam House SE16
- Triple Aspect Apartment
- Three Bathrooms
- Stylish Interior
- Concierge Facilities
- 1,235 Sq Ft
- Three Double Bedrooms
- Generous Private Balcony
- Parking Available Under Separate Negotiation
- EWS1 Compliant

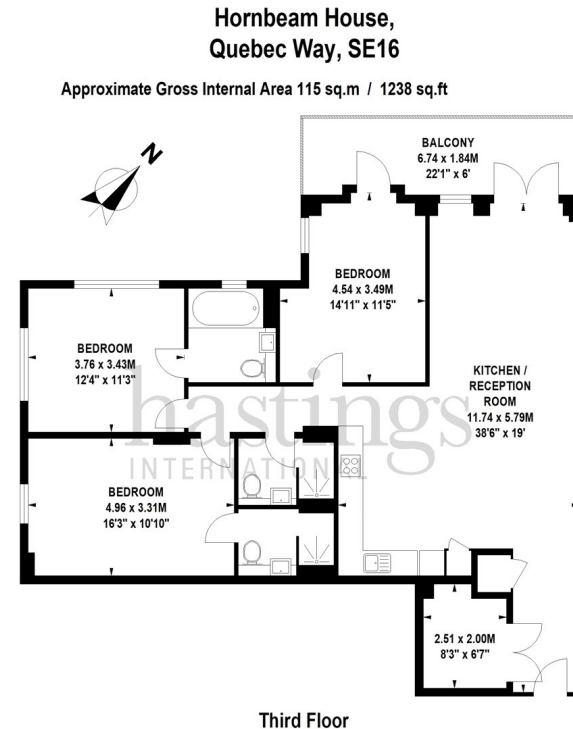

Illustration for identification purposes only, not to scale
All measurements are maximum, and includes wardrobes and window bays where applicable

