



Claytongate
Coppull
Chorley
Lancashire
PR7 4PR

Offers In Excess Of £210,000

bettermove

Claytongate Chorley

Bettermove are proud to present this 2 bedroom bungalow in Chorley available with no forward chain.

The property benefits from double glazing, gas central heating throughout and has off street parking available.

The council tax band is B.

This is a leasehold property with 999 years on the lease from 1960; the ground rent is £5pa.

The interior of this property comprises a spacious living room, fitted kitchen, 2 bedrooms, shower room and conservatory. The exterior boasts a private rear garden, perfect for enjoying the summer months.

Located in the popular town of Chorley, the property is close to a range of amenities, including shops, supermarkets, restaurants and pubs. Excellent transport connections can be found from the M6, A49 and local bus routes.

This exciting opportunity should not be missed! All enquiries can be made through Bettermove on 0330 004 0050.



Total Approx. Floor Area 1030 Sq.ft. (95.66 Sq.M.)

Whilst every effort is made to accurately reproduce these floor plans, measurements are approximate, not to scale and for illustrative purposes only

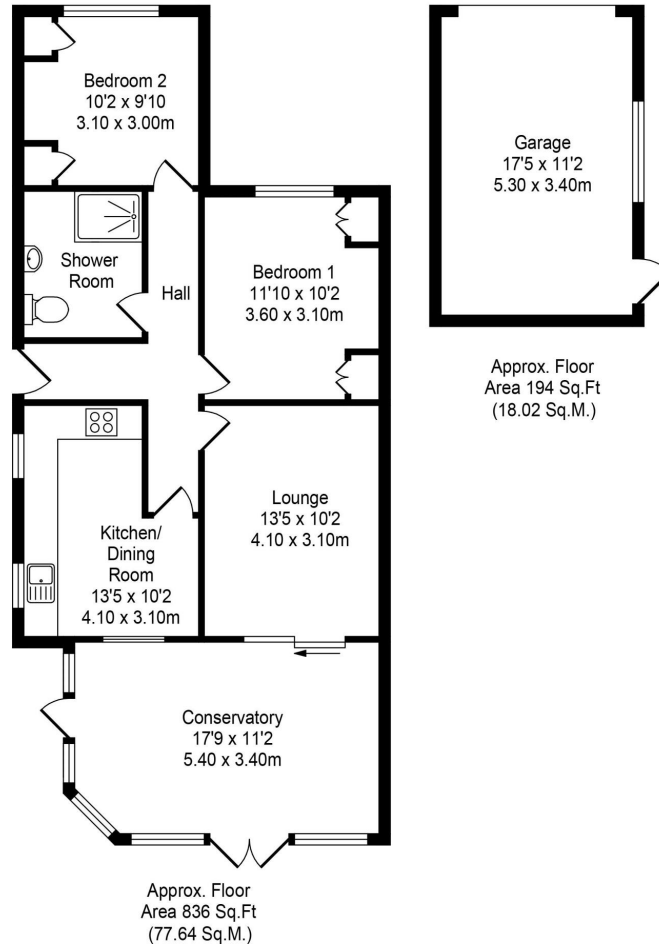

Energy Efficiency Rating		
	Current	Potential
<i>Very energy efficient - lower running costs</i>		
(92+) A		
(81-91) B		90
(69-80) C	74	
(55-68) D		
(39-54) E		
(21-38) F		
(1-20) G		
<i>Not energy efficient - higher running costs</i>		
England, Scotland & Wales	EU Directive 2002/91/EC	



20-22 Bridge End, Leeds, LS1 4DJ
t: 0330 004 0050 e: hello@bettermove.co.uk
www.bettermove.co.uk