



Two Bedroom Terraced House
High Street, Rainham, Gillingham, Kent, ME8 8DS

Offers in Excess of £230,000
Freehold

High Street, Rainham, Gillingham, Kent, ME8 8DS

Offers in Excess of £230,000

Freehold

Description

Chain Free and situated in a prime location, this delightful two-bedroom terraced home is an opportunity not to be missed. The ground floor features a spacious lounge, perfect for relaxing or entertaining, along with a separate dining area ideal for family meals or gatherings. The kitchen, which offers a functional layout, conveniently leads out to a lovely garden—perfect for outdoor dining or simply enjoying the fresh air. The garden also features a handy outside toilet. Upstairs, you'll find two spacious double bedrooms, perfect for comfort and relaxation. A hallway connects these rooms to the separate bathroom, providing easy access while maintaining privacy. This home offers potential to extend STRP and with Rainham Precinct just a short walk away, this location truly stands out. Don't miss the chance to explore this property, contact the Greyfox sales team in Rainham today to arrange your viewing!

Please note this home is heated by electric radiators.

Key Features

- Offered With No Onward Chain
- Potential First Time buyer or Investment Opportunity
- Two Double Bedrooms
- Terraced Family Home
- Upstairs Separate Bathroom
- Rear Garden Approx 42.9ft x 13ft
- Cellar
- Located Conveniently For Amenities And Rainham Train Station

Local Area

Rainham in the Medway towns is located descending towards the banks of the river Medway, approximately 39 miles from London. The ancient Watling Street main road (A2) runs through the town with the M2 motorway on the southern edge with good links to the M25/M20. There are a good number of shops and facilities within the town, a mainline station and a selection of local schools including Rainham Mark Grammar School

BASEMENT
190 sq. ft. (17.6 sq. m.) approx.



GROUND FLOOR
397 sq. ft. (36.6 sq. m.) approx.

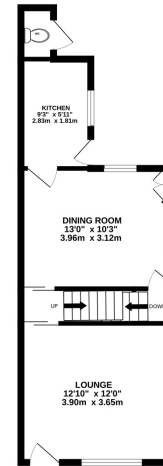

1ST FLOOR
386 sq. ft. (35.6 sq. m.) approx.



TOTAL FLOOR AREA : 973 sq.ft. (90.4 sq.m.) approx.

Whilst every attempt has been made to ensure the accuracy of the floorplan contained here, measurements of doors, windows, rooms and any other items are approximate and no responsibility is taken for any error, omission or mis-statement. This plan is for illustrative purposes only and should be used as such by any prospective purchaser. The services, systems and appliances shown have not been tested and no guarantee as to their operability or efficiency can be given.
Made with Metropix ©2024



Property Location

High Street, Rainham, Gillingham, Kent, ME8 8DS

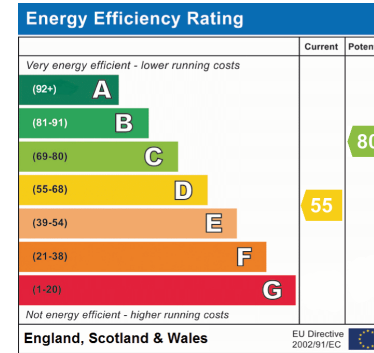
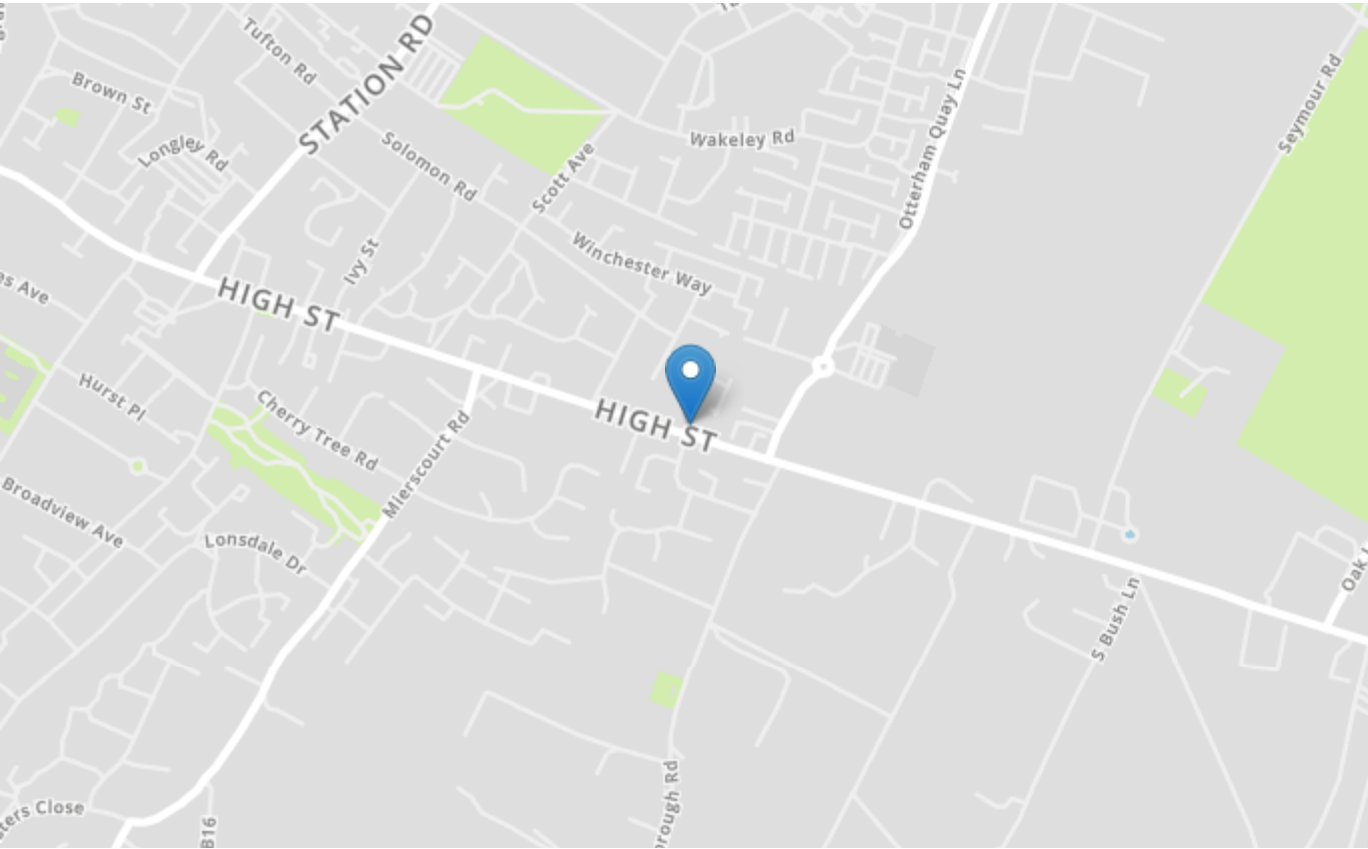

Tenure	Freehold
Lease Term	N/A
Ground Rent	N/A
Service Charge	N/A
Local Authority	Medway
Council Tax	Band B

Greyfox Walderslade

Unit 2, Thetford House
Walderslade Village Centre
Walderslade Road
Chatham
Kent
ME5 9LR
Tel: 01634 672227 Email:
walderslade@greyfox.co.uk

Greyfox Rainham

67C High Street
Rainham
Kent
ME8 7HS
Tel: 01634 377737 Email:
rainham@greyfox.co.uk

Agent Notes

These particulars are prepared as a general guide to a broad description of the property and should not be relied upon as a statement or representation of fact and do not constitute part of an offer or contract. The seller does not make or give nor do our employees or Greyfox have authority to make or give any representation or warranty to the property. We have not carried out a structural survey and the services, appliances and specific fittings have not been tested. All photographs, measurements, floorplans and distances referred to are given as a guide only and should not be relied upon for the purchase of carpets or any other fixtures or fittings. Lease details, service charges and ground rent (where applicable) and council tax are given as a guide only and should be checked and confirmed by you on inspection and your solicitor prior to exchange of contracts. If there are any points of particular importance to you we will be pleased to check the information for you and to confirm that the property remains available. This is particularly important should you be travelling some distance to view and where statements have been made by us to the effect that the information has not been verified. The copyright of all details, photographs and floorplans remain exclusive to Greyfox. For details of our privacy policy and referral fee arrangements with any of our selected partner companies please visit <https://www.greyfox.co.uk/legal/privacy> and <https://www.greyfox.co.uk/referral-fees>.