



**£95PPW £2,476.79 pcm**

- MODERN AND STYLISH PROPERTY
- SIX BEDROOMS
- TWO BATHROOMS
- GREAT LOCATION
- AVAILABLE 01.07.2021





# Norwood Terrace

16 Norwood Terrace, Leeds, West Yorkshire, LS6 1EA

£95PPPW £2,476.79 pcm

Diamond Properties are pleased to be able to offer to let this five bedroom, two bathroom student property that is located in Hyde Park, close to Burley Park Train station and the 24 HR Co-op, this really is an excellent property! Recently refurbished to a high standard, this property is stylish and modern throughout! Briefly comprising of a large kitchen and lounge with loads of great storage and a plethora of mod cons, all set on a modern laminate and tiled flooring. All the bedrooms are **Ground Floor** two tiled bathrooms offering one with a **Bathroom** and one with a shower, this is a cracking house, with great furniture and decorated to a high standard. Get a viewing before it is gone!!!

## Kitchen

Kitchen

## Bedroom

Double bedroom

## Living-room

Living-room

## First Floor

### Bedroom

Double bedroom

### Bedroom

Double bedroom

### Bedroom

Double bedroom

### Bathroom

Bathroom

## Second Floor

### Bedroom

Double bedroom

### Bedroom

Double bedroom

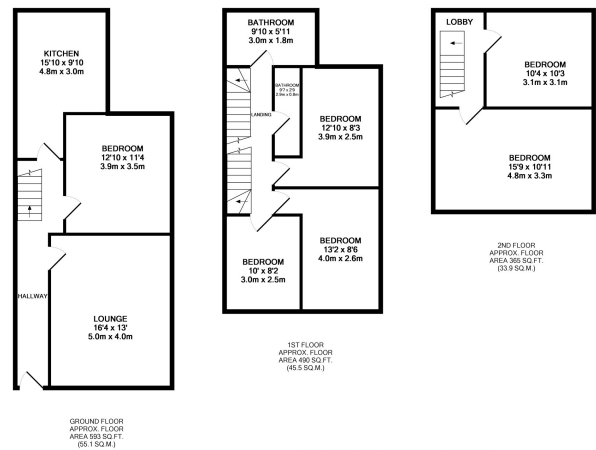

While every attempt has been made to ensure the accuracy of the floor plan contained here, measurements of doors, windows, rooms and any other items are approximate and the responsibility is placed on any prospective purchaser. The plan is for illustrative purposes only and should be used as a guide to any prospective purchaser. The services, systems and appliances shown have not been tested and no guarantee is given as to their operability or efficiency over the given.

Made with Metaphor 02017