

**FOR SALE**

£250,000 Leasehold



**47 Winnipeg Way, Broxbourne,  
Hertfordshire. EN10 6FG**

## ABOUT THE PROPERTY

Woodhouse are pleased to offer, this 2 -Bedroom 2- Bathroom Apartment situated in the ever- popular Canada Fields area of Broxbourne. Offered with NO ONWARD CHAIN, so move in as soon as your solicitor allows!

The apartment is set on the ground floor and benefits from allocated parking. The Apartment has a spacious Lounge, Kitchen, Family Bathroom and 2 x Double Bedrooms (with the Master En-suite).

Winnipeg Way is in the ever-popular Canada Fields Development. Situated between the amenities of Cheshunt and Broxbourne, there is also Brookfield Shopping Centre and the A10 / M25 close by. Contact Woodhouse to arrange a viewing to see for yourself what this apartment has to offer you!

Lease details within 24 hours.

## FEATURES

- CHAIN-FREE
- 2 Bedrooms
- 2 Bathrooms (as Master Bedroom is En-Suite)
- Ground Floor
- Allocated parking
- Situated on the popular Canada Fields
- Between the amenities of Cheshunt & Broxbourne
- Close to Brookfield Centre and the A10
- 100+ year lease
- Contact Woodhouse today



## ROOM DESCRIPTIONS



## FLOORPLAN

### GROUND FLOOR

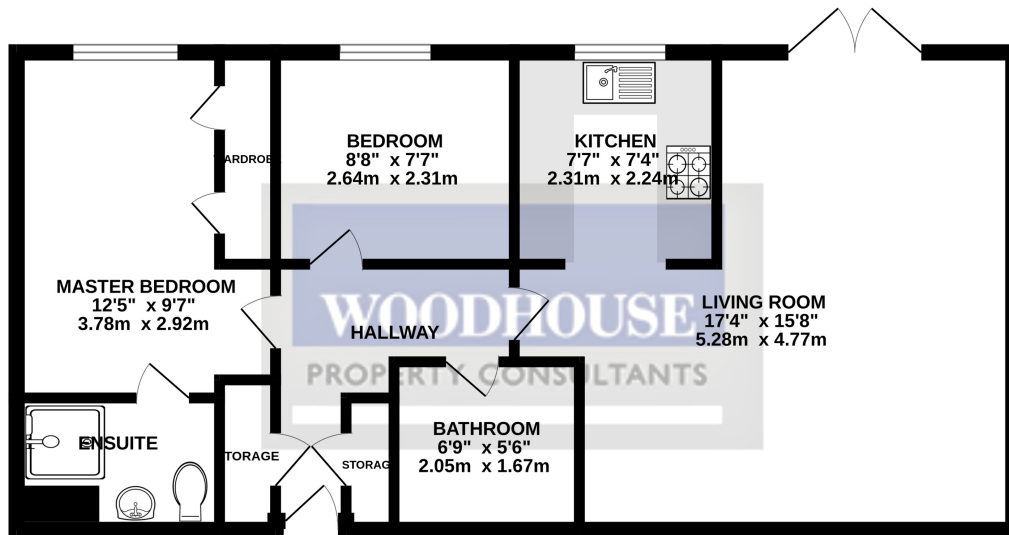

Whilst every attempt has been made to ensure the accuracy of the floorplan contained here, measurements of doors, windows, rooms and any other items are approximate and no responsibility is taken for any error, omission or mis-statement. This plan is for illustrative purposes only and should be used as such by any prospective purchaser. The services, systems and appliances shown have not been tested and no guarantee as to their operability or efficiency can be given.  
Made with Metropix ©2025