



Wratten Road West

Hitchin | Hertfordshire | SG5 2EJ

www.stonegate-estates.co.uk



WRATTEN ROAD WEST

Property Description

Situated on the outskirts of the town centre and within easy access to the local shops and restaurants is this modern, well presented one bedroom retirement apartment.

Located on the first floor of this delightful development, the apartment enjoys a corner location which offers a dual aspect from the living room and a balcony with views over the communal gardens.

The bedroom has a walk in wardrobe with shelving and hanging rails, the shower room is just off the hallway and has a refitted shower cubicle.

The main living space is larger than normal and due to the extra two side windows, offers a light and airy feel to what is already a good sized room. Directly off here is the balcony which would accommodate two chairs and a small table allowing for daytime relaxation or a glass of wine in the evening sun.

Presented in immaculate condition and having had a refitted kitchen, the apartment really is a gem and is well worth a visit to fully enjoy the layout and all the benefits that this Churchill development brings.



£415,000 Leasehold



Approximate Gross Internal Area
57.2 sq m / 616 sq ft

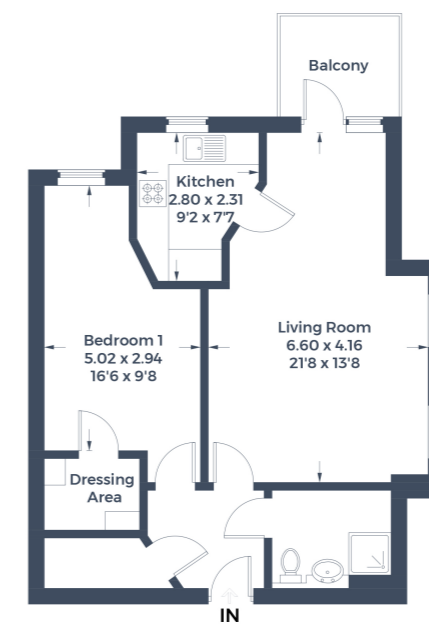

This plan is for layout guidance only. Not drawn to scale unless stated. Windows and door openings are approximate. Whilst every care is taken in the preparation of this plan, please check all dimensions, shapes and compass bearings before making any decisions reliant upon them.
© CJ Property Marketing Produced for Stonegate Estates



- One Bedroom Apartment
- Walk in Wardrobe
- Shower Room
- Storeroom
- Dual Aspect Living Room
- Corner Location
- Balcony
- Very Well Presented
- Residents Lounge & Coffee Bar
- Communal Gardens

EPC Rating: B

Stonegate Estate Agents

01462 438979

sales@stonegate-estates.co.uk | www.stonegate-estates.co.uk

