

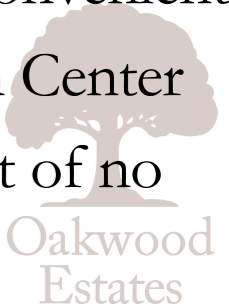

Being Sold via Secure Sale online bidding. Terms & Conditions apply. Starting Bid £210,000. This two double bedroom purpose built apartment is located in the heart of Old Windsor and comes to the market in good condition. The layout features a 20ft living room, 13ft fitted kitchen, a family bathroom and two good sized double bedrooms. This property is an excellent purchase due to its convenient location providing easy access to Windsor Town Center and comes to the market with the added benefit of no onward chain.



# Property Information

# Floor Plan

-  IMMEDIATE 'EXCHANGE OF CONTRACTS' AVAILABLE SOLD VIA 'SECURE SALE'
-  TWO DOUBLE BEDROOMS
-  BALCONY
-  DOUBLE GLAZING THROUGHOUT
-  IDEAL INVESTMENT PROPERTY
-  EPC - E
-  PURPOSE BUILT APARTMENT
-  20FT LIVING ROOM
-  ELECTRIC HEATING
-  NO ONWARD CHAIN
-  CLOSE TO LOCAL AMENITIES

Approximate Area = 690 sq ft / 64.1 sq m  
For identification only - Not to scale

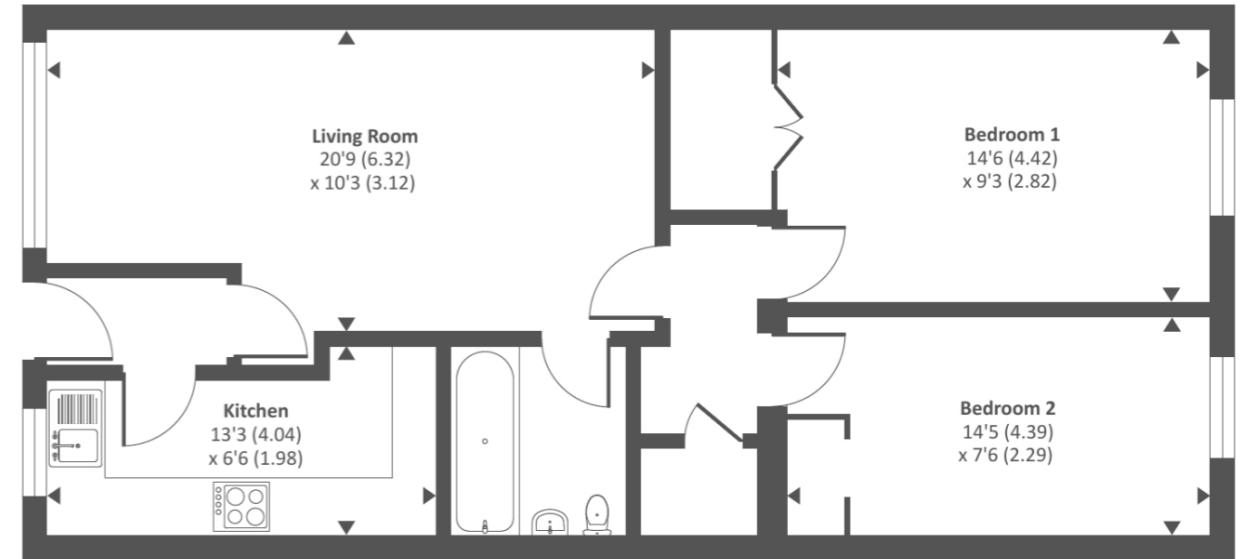

First floor

 Floor plan produced in accordance with RICS Property Measurement Standards incorporating International Property Measurement Standards (IPMS2 Residential). © nldhcom 2024. Produced for Chancellors Estate Agents. REF: 1096639

Prospective purchasers should be aware that these sales particulars are intended as a general guide only and room sizes should not be relied upon for carpets or furnishing. We have not carried out any form of survey nor have we tested any appliance or services, mechanical or electrical. All maps are supplied by Goview.co.uk from Ordnance Survey mapping. Care has been taken in the preparation of these sales particulars, which are thought to be materially correct, although their accuracy is not guaranteed and they do not form part of any contract.

					
x2	x1	x1	0	N	N
Bedrooms	Reception Rooms	Bathrooms	Parking Spaces	Garden	Garage

## Lease Information

91 Years remaining  
Ground rent £200 per year  
Service charge £0

## Transport Links

Nearest train stations:

Datchet (2.2 miles)

Egham (3.1 miles)

Windsor and Eton Riverside (3.3 miles)

## Schools

Primary Schools:

King's Court First School (0.2 miles)

St Peter's C of E Middle School (0.5 miles)

St Johns Beaumont (1.1 miles)

Eton End (2.8 miles)

Secondary Schools:

The Windsor Boys' School (2.7 miles)

Windsor Girl's School (2.5 miles)

Langley Grammar School (3.3 miles)

Upton Court Grammar School (3.5 miles).

## Council Tax

Band E

