

Guide Price  
£195,000  
Leasehold

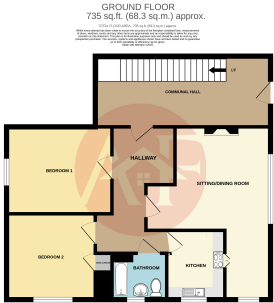

**Furze Close, Weston-Super-Mare, BS22 9SH**  
**2 Bedrooms, Flat**

- Two Double Bedrooms
  - Fitted Kitchen Area
  - UPVC Double Glazed Windows
  - Bathroom With Three-Piece Suite
  - Single Garage In Block
- Allocated Off-Street Parking
  - Elevated Worlebury Hillside Location
  - Wrap Around Garden
  - Spacious Sitting/Dining Room
  - Lease: 999 from 1975. Service Charge £40 pcm



**Building Safety**  
Non Reported

**Mobile Signal**  
Ofcom predicts coverage, nPerf shows real-world signal.

**Construction Type**  
Standard Construction

**Existing Planning Permission**  
Non Reported

**Coalfield or Mining**  
Non Reported

**EPC Rating:** E (49)  
**Council Tax:** Band B  
**Council Tax:** Rate 1820.69  
**Parking Types:** Allocated.  
**Heating Sources:** Electric.  
**Electricity Supply:** Mains Supply.  
**Water Supply:** Mains Supply.  
**Sewerage:** Mains Supply.  
**Broadband Connection Types:** FTTC.  
**Accessibility Types:** Lateral living.  
**Flooding Sources:**

**Has the property been flooded in last 5 years?**  
No  
**Flooding Sources:**  
**Any flood defences at the property?** No  
**Any risk of coastal erosion?** No  
**Is the property listed?** No  
**Are there any restrictions associated with the property?** No  
**Any easements, servitudes, or wayleaves?** No  
**The existence of any public or private right of way?** No