

Truuli



Foxley Gardens, Purley, Surrey, CR8 2DQ

£540,000 Freehold

- Large and inviting double reception room
- Bi-folding doors leading to the garden
- Downstairs W.C and hand basin
- Presented in good decorative order throughout
- Three double bedrooms
- Scope to extend further into the loft
- Modern kitchen with breakfast bar and space to dine in

Southbridge Place, Surrey, CR0 4HA

Tel: 0330 043 0002

Email: save@truuli.co.uk Web: www.truuli.co.uk

Foxley Gardens, Purley, Surrey, CR8 2DQ

£540,000 Freehold

Tucked away at the end of a peaceful cul-de-sac, this spacious three-double-bedroom, end-of-terrace house on Foxley Gardens is immediately available to view. Foxley Gardens is located off Godstone Road and is in close proximity to Purley Station, accommodating all your transport needs. The High Street offers an array of amenities so you would rarely need to leave the area.

Ground Floor
621 sq.ft. (57.7 sq.m.) approx.

1st Floor
505 sq.ft. (46.9 sq.m.) approx.

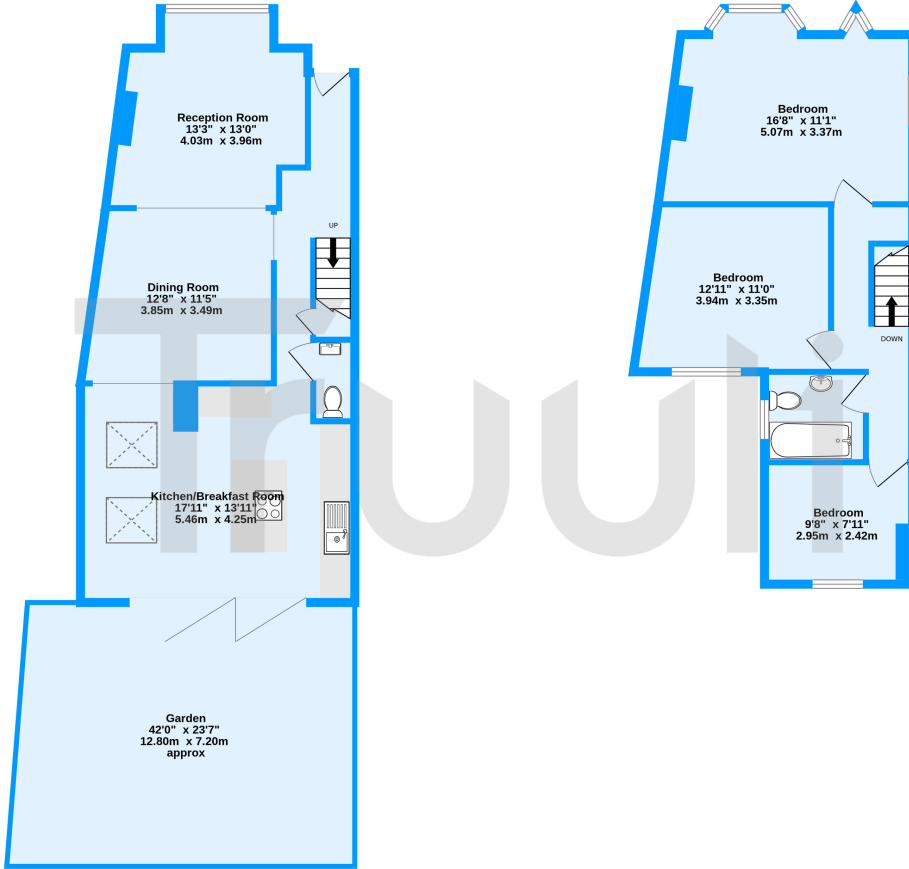

TOTAL FLOOR AREA: 1126 sq.ft. (104.6 sq.m.) approx.
Measurements are approximate. Not to scale. Illustrative purposes only.
Made with Metropix ©2024

Energy Efficiency Rating		Current	Potential
Very energy efficient - lower running costs			
(92-100) A			
(81-91) B			85
(69-80) C			
(55-68) D			
(39-54) E		48	
(21-38) F			
(1-20) G			
Not energy efficient - higher running costs			
England, Scotland & Wales		EU Directive 2002/91/EC	

