



36 Tenby Grove, Kingsmead, Milton Keynes, Buckinghamshire, MK4 4HN

£145,000 Freehold

- Ground rent is £10 a month
- Service charge is £93 per month
- Ideal For First Time Buyers
- Allocated Parking
- Large living room
- Desirable Kingsmead
- EPC Rating





Well positioned and offered for sale at 80% of the market price is this excellent first floor apartment. In brief the accommodation comprises a open plan living room with kitchen area benefitting for integral appliances, one double bedroom with built in wardrobes and a bathroom. Additional benefits include a video/telephone intercom and allocated parking.

Enter via door into:

Entrance Hall

Storage cupboard. Video/telephone intercom. Laminate floor. Doors to:

Open Plan Kitchen/Living Area

20' 9" x 16' 6" (6.32m x 5.03m) Upvc double glazed windows to front and side aspects. Kitchen area comprises 1½ bowl stainless steel sink unit and a further range of units to base and eye level. Integrated oven, hob, fridge/freezer, dishwasher and washing machine. Laminate flooring to kitchen area. Two wall mounted heaters.

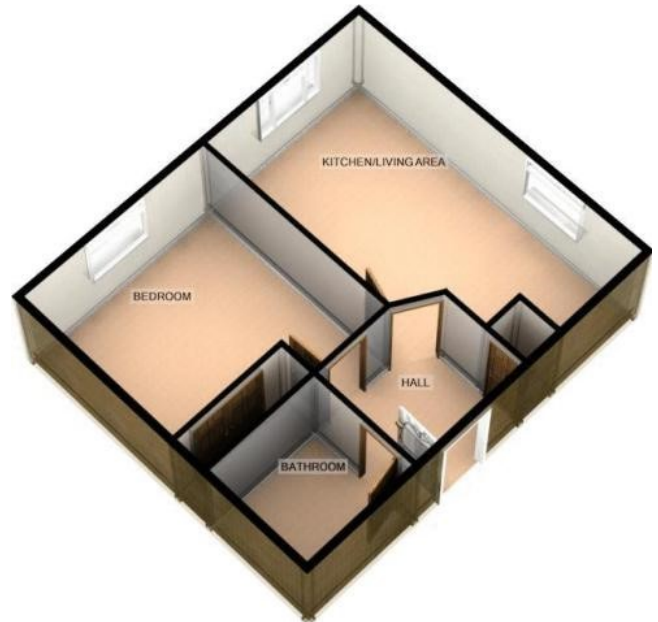

Bedroom

10' 5" x 10' (3.18m x 3.05m) Upvc double glazed window to side aspect. Wall mounted heater. Built-in wardrobe.

Bathroom

P-shaped bath with mixer tap and shower unit over, low level w.c. and wall mounted wash basin. Heated towel rail. Extractor.

Parking

Allocated parking for one car.

Disclaimer

Whilst we have endeavoured to prepare our sales particulars accurately none of the services, appliances or equipment have been tested. A buyer should satisfy themselves on such matters prior to purchase. Any measurements or distances mentioned in these particulars are for guide reference only. If such particulars are fundamental to a purchase, buyers should rely on their own enquiries. All enquiries should be directed to Elevation Estate Agents in the first instance.