



Flat 7, St Leonards Court Fleet Street, LYTHAM ST ANNES, Lancashire, FY8 2SY
£575 pcm Not Applicable

Energy Efficiency Rating		Environmental Impact (CO ₂) Rating	
Current	Potential	Current	Potential
<p>More energy efficient - lower running costs</p> <p>More environmentally friendly - lower CO₂ emissions</p>			
<p>92-100 A</p> <p>81-91 B</p> <p>69-80 C</p> <p>55-68 D</p> <p>45-54 E</p> <p>35-44 F</p> <p>21-34 G</p>		<p>92-100 A</p> <p>81-91 B</p> <p>69-80 C</p> <p>55-68 D</p> <p>45-54 E</p> <p>35-44 F</p> <p>21-34 G</p>	
	73		53
<p>Not energy efficient - higher running costs</p>		<p>Not environmentally friendly - higher CO₂ emissions</p>	
England, Scotland & Wales		England, Scotland & Wales	
EPC 2023		EPC 2023	

Description

Recently modernised Unfurnished Ground Floor Apartment. Large reception, modern fully fitted dining kitchen, 2 double bedrooms, bathroom, electric heating, DG windows, garage. Council Tax: Band A Early viewing highly recommended..

GROUND FLOOR

APPROX. 62.6 SQ. METRES (674.3 SQ. FEET)

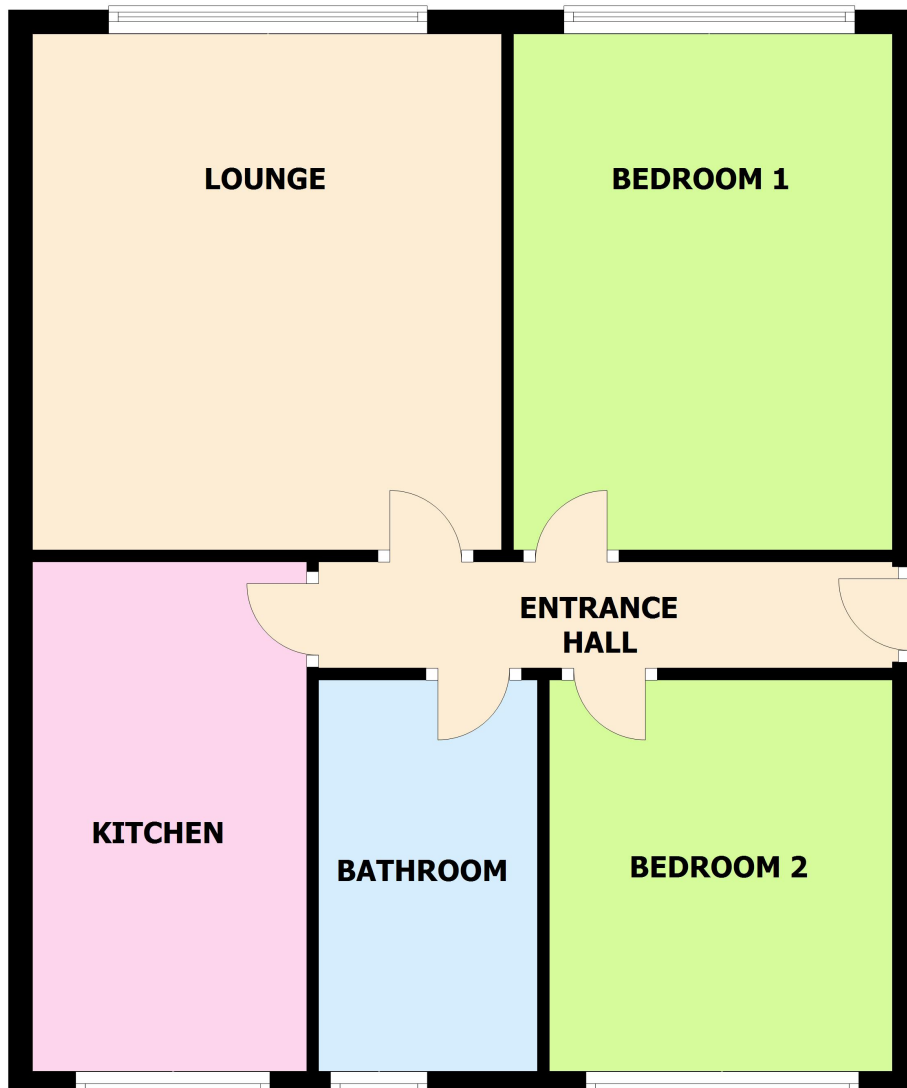

TOTAL AREA: APPROX. 62.6 SQ. METRES (674.3 SQ. FEET)