



**FOR SALE**

## Mead Road, Edgware, Greater London HA8

\*\*\* EDWARDIAN END OF TERRACE \*\*\*

Mischa & Co are proud to present this beautiful 2 bedroom Edwardian end of terraced home, 2 spacious reception rooms, fitted kitchen and downstairs bathroom. Edgware Broadway is within a short walk and offers many local amenities including shops, restaurants and transport links such as Edgware Underground Station (Northern) and various bus routes. We love this property due to the copious amount of natural light, as well as some of the original features that have remained, and this is why we believe internal inspection comes highly recommended.

Call the Vendors Sole Agent, Mischa & Co, today to book your tour!!

Council Tax Band E (Harrow) & EPC rating D (63).

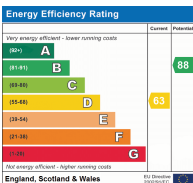

# £399,950 Freehold

4 North Parade, Mollison Way, Edgware, HA8 5QH  
E: info@mischaandco.com T: 0208 951 5000

# Floorplan

GROUND FLOOR  
479 sq.ft. (44.5 sq.m.) approx.

1ST FLOOR  
402 sq.ft. (37.3 sq.m.) approx.

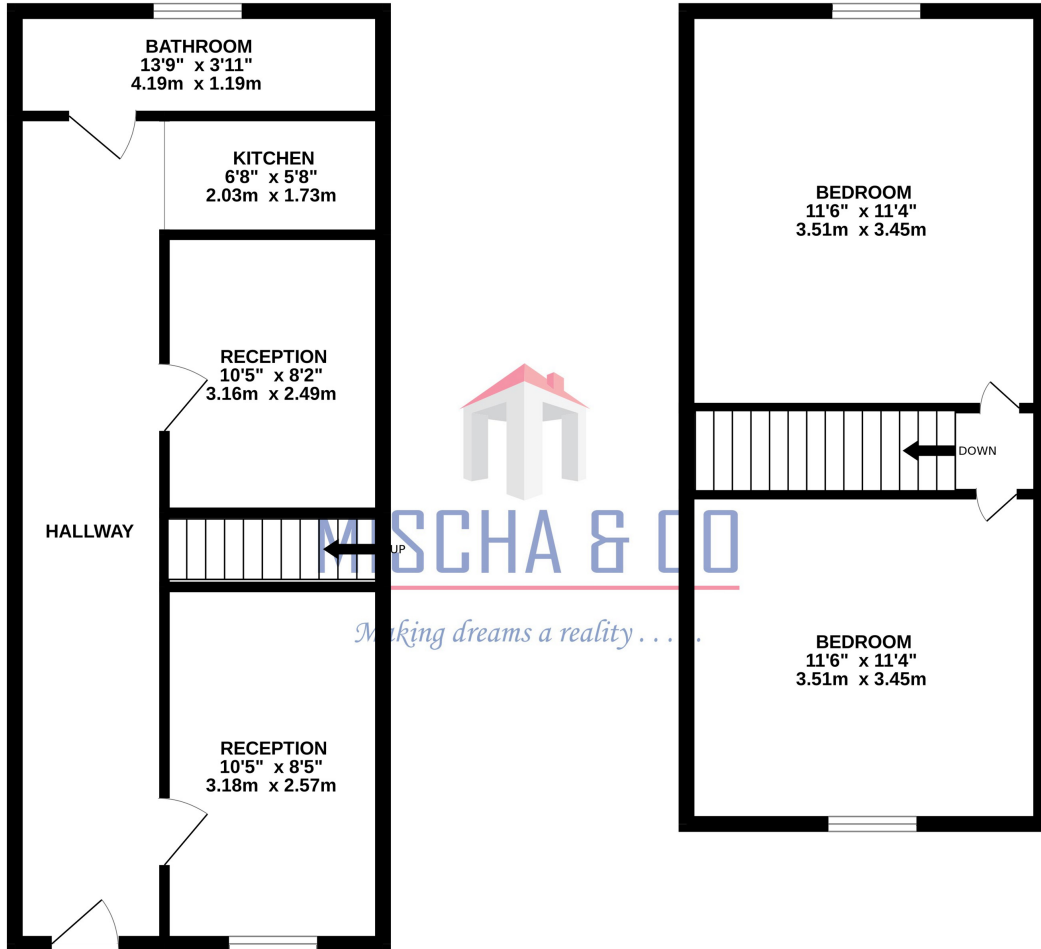

TOTAL FLOOR AREA: 880 sq.ft. (81.8 sq.m.) approx.

Whilst every attempt has been made to ensure the accuracy of the floorplan contained here, measurements of doors, windows, rooms and any other items are approximate and no responsibility is taken for any error, omission or mis-statement. This plan is for illustrative purposes only and should be used as such by any prospective purchaser. The services, systems and appliances shown have not been tested and no guarantee as to their operability or efficiency can be given.  
Made with Metropix ©2026

NB: Please note that all fittings, kitchen appliances and heating systems have not been tested by Mishca & Co Sales & Lettings. Whilst we endeavour to make our sales details accurate and reliable. Room sizes should not be relied upon for carpets and furnishings. If there is any point, which is of particular important to you, please contact our office and we will be pleased to verify any information for you. Do so particularly if contemplating travelling some distance to view this property.

