

FOR SALE

£700,000

Milner Road, Heswall, Wirral. CH60 5RY



IDEAL MODERN DETACHED FAMILY HOME! Offering great privacy this fantastic property is set back from the road and is approached via a private access lane. Only a short walk from Heswall Centre, bustling with local shops, cafes and amenities as well as being in the catchment for highly subscribed local Primary Schools the property has it all to offer for a large family with the added attraction of its generous private rear garden with direct access to Whitfield common. With four/five bedrooms, three bathrooms and ample flexible living space this property has been modernised and well maintained by the current owners and really does need to be seen to fully appreciate the quality and standard of the accommodation it has to offer.





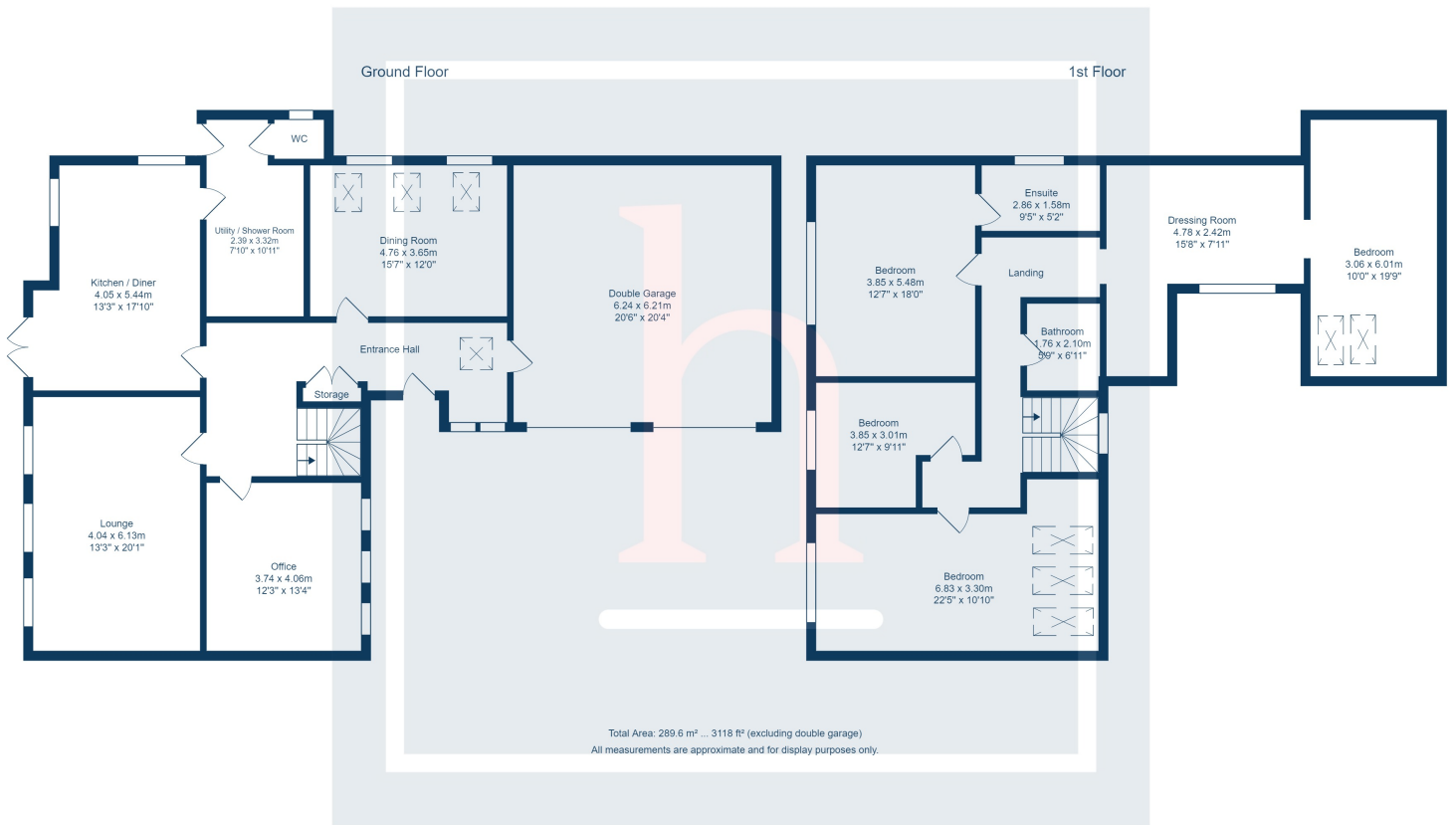

Energy Efficiency Rating		Current	Potential
<i>Very energy efficient - lower running costs</i>			
(92+)	<b>A</b>		
(81-91)	<b>B</b>		
(69-80)	<b>C</b>	77	81
(55-68)	<b>D</b>		
(39-54)	<b>E</b>		
(21-38)	<b>F</b>		
(1-20)	<b>G</b>		
<i>Not energy efficient - higher running costs</i>			
<b>England, Scotland &amp; Wales</b>		EU Directive 2002/91/EC	