

Confidential Instruction



SOLE
AGENT

Confidential

St Sampson |

This light one bedroom wing is located within walking distance of L'Ancrese Common, Les Amarreurs and the amenities at L'islet. Accommodation comprises kitchen, lounge/diner, bedroom and a shower room. There is parking for one car. Regret no smokers or pets. This property is suited to a single professional. Available immediately.

£1,400 pcm

1 BEDROOM

1 BATHROOM

1 RECEPTION

Shields
& Rutland

Entrance Hall

1.86m x 0.91m (6' 1" x 3' 0")

Kitchen

3.82m x 2.91m (12' 6" x 9' 7")

Lounge/Diner

3.83m x 3.04m (12' 7" x 10' 0")

Bedroom

3.34m x 3.06m (10' 11" x 10' 0")

Shower Room

1.95m x 1.75m (6' 5" x 5' 9")

Parking

There is parking for one car.

PRICE INCLUDES

Carpets and light fittings.

SPECIAL FEATURES

- Parking for 1 car
- Light accommodation
- Convenient location
- Amenities close by

SERVICES

Mains drain, water and electricity.
Oil fired central heating.

APPLIANCES INCLUDED

- Beko washer/dryer
- Hotpoint double oven
- Four ring hob

SCHOOL CATCHMENT

N/A

GROUND FLOOR

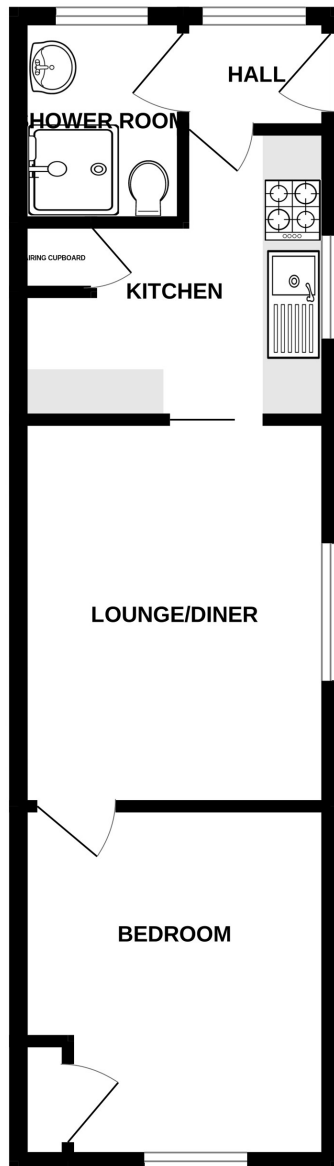

THE WING, SOMERSET

Whilst every attempt has been made to ensure the accuracy of the floorplan contained here, measurements of doors, windows, rooms and any other items are approximate and no responsibility is taken for any error, omission or mis-statement. This plan is for illustrative purposes only and should be used as such by any prospective purchaser. The services, systems and appliances shown have not been tested and no guarantee as to their operability or efficiency can be given.
Made with Metropix ©2024