



KUBIE GOLD  
ASSOCIATES

## WELLESLEY COURT MAIDA VALE MAIDA VALE W9



- THREE BEDROOM APARTMENT
- WOOD FLOOR THROUGHOUT
- PRIVATE PORTERED BLOCK

- DOUBLE GLAZED WINDOWS
- INC HEAT AND HOT WATER
- AVAILABLE IMMEDIATELY

**£646 per week**

SALES, LETTINGS & PROPERTY MANAGEMENT

Tel:

020 7563 7272

36 Ivor, Regents Park, London, NW1 6EA

Email: [info@kubie-gold.co.uk](mailto:info@kubie-gold.co.uk) Website: [www.kubie-gold.co.uk](http://www.kubie-gold.co.uk)

Kubie Gold Associates is the trading name of Kubie Gold Associates Ltd  
Company Registration No. 7271501 registered in England and Wales



## Wellesley Court Maida Vale, W9

Three bedroom apartment in well managed Portered block, good size reception with wood floors, three double bedrooms, separate fully fitted kitchen, full family bathroom, property benefits from wooden floors throughout, set on the ground floor of private purpose built block, rent includes heating and hot water property benefits from double glazing, situated a short walk from Maida Vale Tube Station and all shops and restaurants, available immediately.

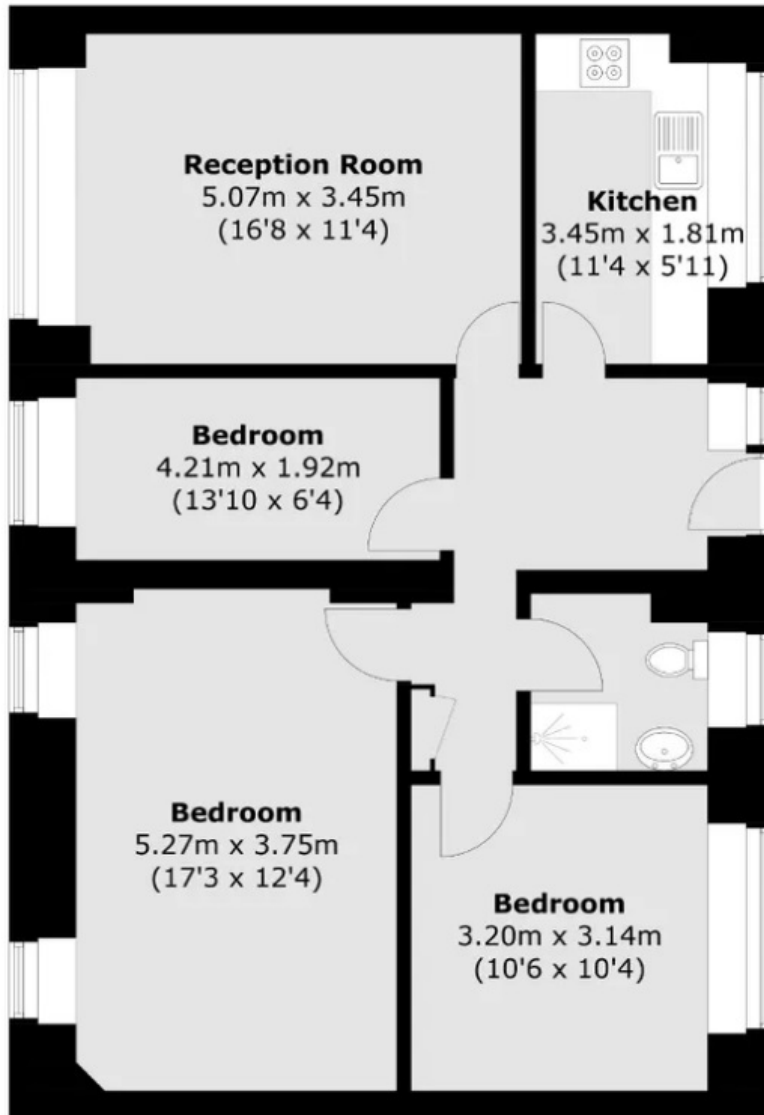

### Ground Floor

Total area (842.8 sq. ft)

### Local Authority:

Westminster

### Tax Band:

Band E

Energy Efficiency Rating		Current	Potential
Very energy efficient - lower running costs			
(92+)	<b>A</b>		
(81-91)	<b>B</b>		
(69-80)	<b>C</b>		
(55-68)	<b>D</b>	56	59
(39-54)	<b>E</b>		
(21-38)	<b>F</b>		
(1-20)	<b>G</b>		
Not energy efficient - higher running costs			
England, Scotland & Wales		EU Directive 2002/91/EC	

