

Ground Floor
Approx. 57.8 sq. metres (622.6 sq. feet)

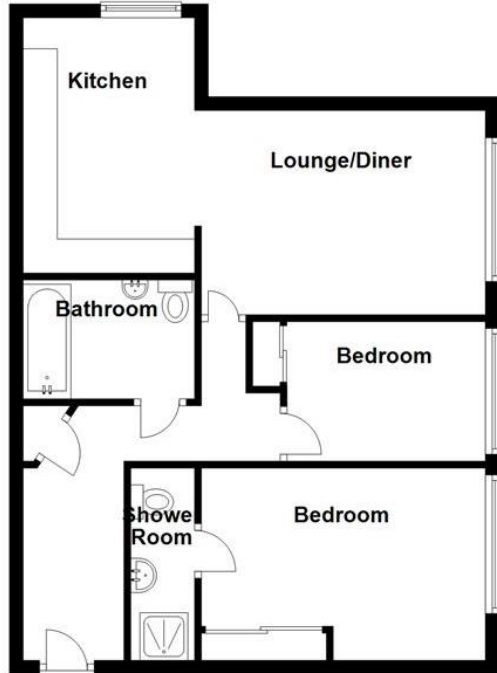

Total area: approx. 57.8 sq. metres (622.6 sq. feet)

FOR ILLUSTRATIVE PURPOSES ONLY. NOT TO SCALE. While every attempt has been made to ensure the accuracy of the floorplan shown, all measurements, positioning, fixtures, fittings and any other data shown are an approximate interpretation for illustrative purposes only and are not to scale. No responsibility is taken for any error, omission, misstatement or use of data shown. B.B.E (UK) LTD
Plan produced using PlanUp.



01708 400 400

Ockendon@pattersonhawthorn.co.uk



Energy Efficiency Rating

	Current	Potential
<i>Very energy efficient - lower running costs</i>		
(92 to 100) A		
(81 to 91) B		
(69 to 80) C		
(55 to 68) D	66	67
(39 to 54) E		
(21 to 38) F		
(1 to 20) G		
<i>Not energy efficient - higher running costs</i>		
England, Wales & N.Ireland	EU Directive 2002/91/EC	

Environmental Impact (CO₂) Rating

	Current	Potential
<i>Very environmentally friendly - lower CO₂ emissions</i>		
(92 to 100) A		
(81 to 91) B		
(69 to 80) C	76	77
(55 to 68) D		
(39 to 54) E		
(21 to 38) F		
(1 to 20) G		
<i>Not environmentally friendly - higher CO₂ emissions</i>		
England, Wales & N.Ireland	EU Directive 2002/91/EC	

Front Lane, Upminster
£310,000

- TWO BEDROOMS
- FIRST FLOOR FLAT
- IMMACULATE THROUGHOUT
- TWO BATHROOMS
- BALCONY
- LEASE IN EXCESS OF 100 YEARS
- ALLOCATED PARKING
- IDEAL FIRST TIME BUY



Appointments to view and offers to purchase must be made through Patterson Hawthorn. These particulars are produced for guidance only and do not form any part of an offer or Contract. These particulars, whilst believed to be accurate are to be used for guidance only and do not constitute any part of an offer or contract. Intending purchasers should not rely on them as statements of representation of fact, but must satisfy themselves by inspection or otherwise as to their accuracy. No person in the employment of Patterson Hawthorn has the authority to make or give any representation or warranty in respect of the property. Patterson Hawthorn have not tested any services or appliances in the property, prospective purchasers should satisfy themselves with regard to the working order of these.

See our full selection of properties online at www.pattersonhawthorn.com



GROUND FLOOR

Communal Entrance

Via security phone entry system, stairs to first floor.

Front Entrance

Via hardwood door into:

Hallway

Spotlight bar to ceiling, built in storage cupboard housing fuse box and water tank, electric heater, fitted carpet.

Bedroom One

4.33m x 2.77m (14' 2" x 9' 1") Double glazed window to rear, electric heater, fitted wardrobes with sliding mirror doors, fitted carpet.

Ensuite Bathroom

Comprising low level flush WC, hand wash basin, shower cubicle, chrome hand towel radiator, tiled splash backs, tile effect vinyl flooring.

Bedroom Two

3.75m x 2.66m (12' 4" x 8' 9") Double glazed windows to rear, electric heater, fitted carpet.



Bathroom

Inset spotlights to ceiling, low level flush WC, hand wash basin, panelled bath with shower attachment, chrome hand towel radiator, tiled splash backs, tile effect vinyl flooring.

Open Plan Kitchen / Lounge / Diner

7.41m x 3.76m (24' 4" x 12' 4") > 2.98m (9' 9") uPVC framed sliding French door opening to Juliette balcony, electric heater, hardwood flooring throughout, kitchen area; range of matching wall and base units, laminate work surfaces, one and half bowl inset sink and drainer with chrome mixer tap, four ringed electric hob, extractor hood, integrated oven, integrated fridge, integrated freezer, space and plumbing for washing machine, integrated washing machine, space for tumble dryer, laminate splash backs, double glazed window to rear of kitchen area.