

## Hugero Point,, , London, SE10 0GS

£1,925 PCM

AVAILABLE NOW. An outstanding furnished two bedroom located on the first floor of a sought after new build situated in Greenwich Millennium Village. Typified by large expanses of glazing that delivers a light-filled interior and a spacious terrace with stunning views, überhaus represents a new way of living. Boasting a high specification and includes a sleek modern kitchen complete with integrated appliances and luxurious bathrooms. No parking available.

Viewing by appointment with 1st avenue.

**Call: 020 8293 8600**

1st avenue, 128 Metcalfe Court, West Parkside, London SE10 0EL  
email: [info@1stavenue.co.uk](mailto:info@1stavenue.co.uk)

# Hugero Point,, , London, SE10 0GS

£1,925 PCM

**1stavenue**  
Real Estate Services

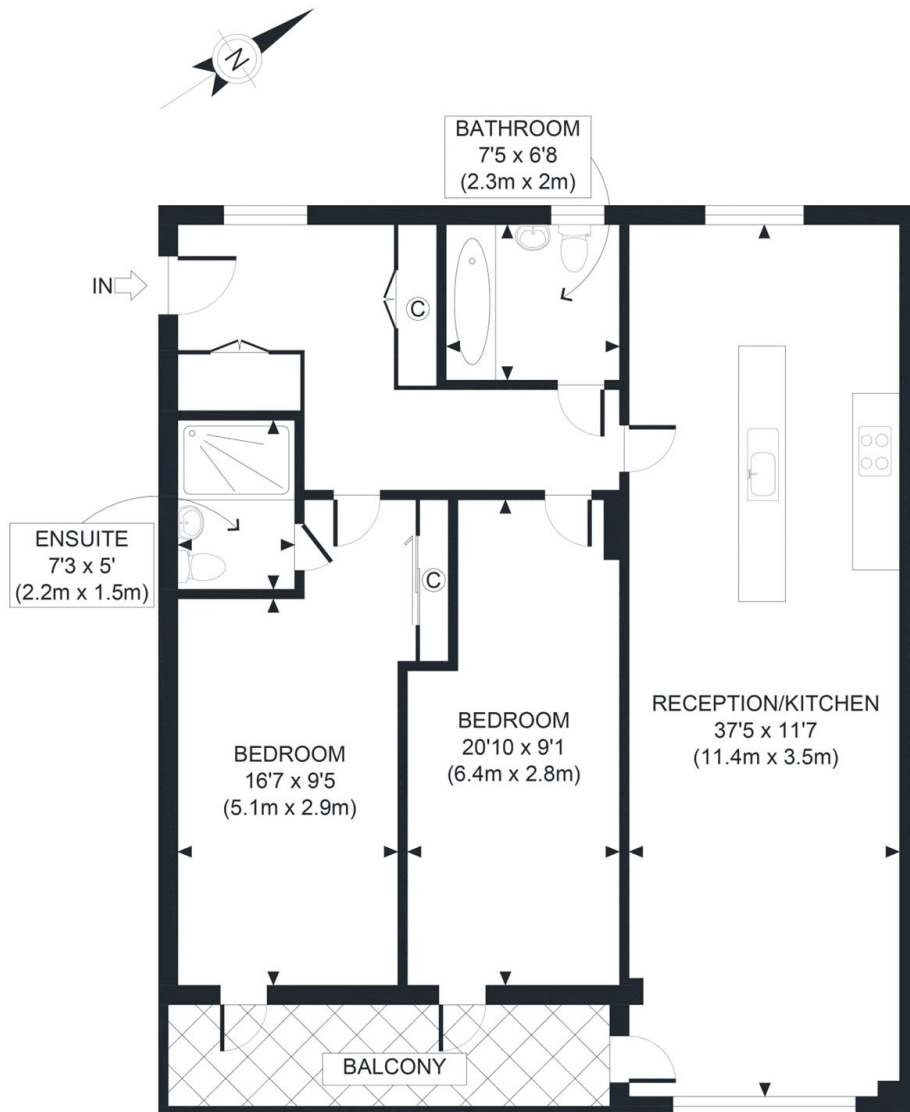

SECOND FLOOR  
GROSS INTERNAL  
FLOOR AREA 1065 SQ FT

APPROX. GROSS INTERNAL FLOOR AREA 1065 SQ FT / 99 SQM

Ref:

Copyright **photoplan** 

Disclaimer: Floor plan measurements are approximate and are for illustrative purposes only. While we do not doubt the floor plan accuracy and completeness, you or your advisors should conduct a careful, independent investigation of the property in respect of monetary valuation

Viewing by appointment with 1st avenue.

**Call: 020 8293 8600**

1st avenue, 128 Metcalfe Court, West Parkside, London SE10 0EL  
email: [info@1stavenue.co.uk](mailto:info@1stavenue.co.uk)

**1stavenue**  
Real Estate Services