

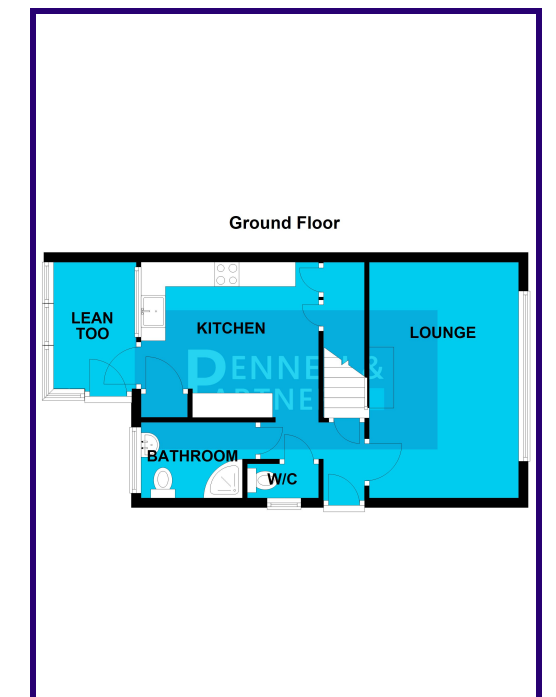

52 SPRINGFIELD ROAD, OUNDLE, PETERBOROUGH, NORTHAMPTONSHIRE. PE8 4LT

£260,000

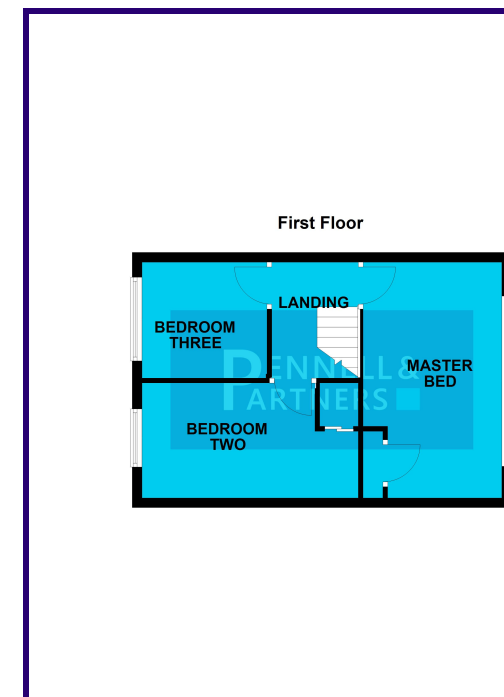

PENNELL & PARTNERS

Pennell & Partners, 5 Cross Street, Peterborough, PE1 1XA - 01733 209222 - hello@pennellandpartners.co.uk

ABOUT THE PROPERTY

This charming property boasts a generous-sized lounge perfect for relaxation and entertaining.

On the ground floor, you'll find a convenient bathroom complete with a shower, as well as an additional separate WC for added convenience.

The first floor offers three spacious bedrooms, each providing ample storage space, making it ideal for families or those in need of extra room.

Outside, the property features off-road parking and a compact rear garden that offers plenty of storage, perfect for enjoying sunny days or a bit of gardening.

Located in a quiet and sought-after area, this home provides a serene lifestyle while still being close to local amenities.

Don't miss the chance to view this wonderful home!

Contact us today to arrange a viewing.

EPC Rating:



ENTRANCE HALL

LOUNGE

4.837m x 3.050m (15' 10" x 10' 0")

W/C

1.587m x 0.736m (5' 2" x 2' 5")

BATHROOM

2.068m x 1.544m (6' 9" x 5' 1")

KITCHEN

3.644m x 3.184m (11' 11" x 10' 5")

CONSERVATORY/SNUG

2.686m x 1.688m (8' 10" x 5' 6")

FIRST FLOOR

MASTER BEDROOM

4.819m x 2.840m (15' 10" x 9' 4")

BEDROOM TWO

2.391m x 2.570m (7' 10" x 8' 5")

BEDROOM THREE

4.275m x 2.380m (14' 0" x 7' 10")

FRONT OF HOUSE

OFF ROAD PARKING FOR 2 CARS

REAR GARDEN

COMPACT GARDEN WITH RAISED DECKIN AREA, SHEDS AND BORDERS