



## Kingswood

Uzmaston, Haverfordwest, SA61 1UR

Guide Price Of £599,950 | Freehold | EPC: C





### **An Exceptional Multi-Generational Residence in a Prime Setting**

Situated along the desirable Uzmaston Road, this impeccably presented detached bungalow offers a rare combination of space, versatility and style. Beautifully extended and thoughtfully upgraded by its current owners, the property is perfectly suited for large families, multi-generational living or those seeking flexible accommodation with potential for commercial or guest use.

Upon entry, a bright and spacious hallway with engineered oak flooring leads to an elegant lounge featuring a log burner set on a slate hearth. The adjoining kitchen/sitting room forms the heart of the home, offering a range of matching eye and base level units, high-end integrated appliances, dining space, plus garden and countryside views to the rear, making this a superb area for everyday living and entertaining. A practical utility room is positioned conveniently off the kitchen. Three double bedrooms and a modern family bathroom are located on the ground floor, while a dedicated office space with staircase access leads to three further double bedrooms and a stylish shower room above.

Adjoining the main house, the former garage has been converted into a self-contained annexe. This beautifully appointed space comprises a high-spec hardwood kitchen with integrated appliances, a functional utility room with airing cupboard, a spacious lounge/diner with ample room for sofas and a large dining table, plus an additional ground floor shower room for further future proofing and convenience. Upstairs, two generously proportioned double bedrooms and a bathroom provide further private accommodation—ideal for extended family or guests.



In addition, a detached annexe provides a third self-contained unit, accessed independently with dedicated parking. The ground floor offers a welcoming lounge and a fully equipped kitchen, alongside a modern shower room. Upstairs, a spacious double bedroom benefits from a walk-in wardrobe and a separate WC—offering the perfect solution for visitors, live-in carers, or potential holiday let use.

### **Beautiful Patio and Garden with Countryside Views**

The property is accessed via a spacious block-paved driveway, providing ample parking and framed by a dwarf stone wall and mature hedging for added privacy. The rear garden is as well-considered as the interior, landscaped to offer a peaceful outdoor retreat. An elevated patio area provides space for al fresco dining, while stone walling, tree-lined borders and a large lawn offer both privacy and a sense of openness. A summer house with a covered seating area sits to the rear, ideally placed to take in the uninterrupted views of the surrounding countryside.

### **Prime Location with Town & Coastal Access**

Positioned on the edge of Haverfordwest, this property enjoys the perfect balance of tranquillity and accessibility. A range of essential amenities, including supermarkets, independent shops, schools, healthcare facilities, and leisure centres, are within easy reach. The nearby train station provides excellent transport links, making travel across the region effortless. The renowned Pembrokeshire coastline lies just five miles to the southwest, offering spectacular blue flag beaches and scenic walking routes along the Pembrokeshire Coastal Path—one of the UK's most celebrated landscapes.





### Entrance Hallway

5.47m x 3.77m (17'11" x 12'5")

A uPVC front door with glass panelling opens into a welcoming hallway with engineered oak flooring. An integrated storage cupboard provides practical space, while double doors lead into the lounge.

### Lounge

5.47m x 3.77m (17'11" x 12'5")

A spacious reception room featuring engineered oak flooring and a log burner set on a slate hearth. A large double-fronted window to the fore aspect allows natural light to flow throughout.

### Kitchen / Sitting Room

7.41m x 3.64m (24'4" x 11'11")

An open-plan space with tiled flooring and a range of matching eye and base-level units with worktops and tiled splash backs. A composite double sink with a draining board is positioned beneath a window overlooking the garden and countryside. Appliances include a Bosch eye-level double oven, a Bosch integrated dishwasher, and an AEG electric stove with four rings and an extractor above. A dwarf red brick wall subtly separates the sitting area, with a sliding patio door providing access to the patio and garden beyond.

### Utility Room

2.89m x 1.82m (9'6" x 6'0")

Tiled flooring, a Worcester boiler, and space for a washer/dryer and fridge/freezer. A uPVC door leads directly to the garden and patio, while an additional door opens to the boiler room, which houses water tanks and further shelving.

### Bedroom

4.48m x 3.04m (14'8" x 10'0")

A double bedroom offering carpet underfoot and a window to the fore aspect, with ample space for wardrobes.

### Bedroom

4.48m x 4.00m (14'8" x 13'2")

A spacious double bedroom benefiting from fitted wardrobes, drawers, and a dressing table. A window to the fore aspect allows plenty of natural light.

### Family Bathroom

3.00m x 2.60m (9'10" x 8'6")

Fitted with oak-effect vinyl flooring and tiled walls, this bathroom comprises a WC, a sink with a mirrored cabinet above, a walk-in shower with a rainfall head and glass screen surround, and a large corner bath. A heated towel rail, extractor fan, and window to the side aspect complete the space.







### **Bedroom**

**3.63m x 3.00m (11'11" x 9'10")**

A double bedroom overlooking the rear garden, complete with carpet underfoot and ample room for wardrobes.

### **Office**

**3.64m x 3.34m (11'11" x 11'0")**

An ideal space for home working with carpet underfoot, a window to the rear aspect, and a staircase leading to the first floor. Internet connections are installed, with ample space for a desk.

### **Main House - First Floor**

#### **Bedroom**

**9.44m x 5.02m (31'0" x 16'6")**

A substantial double bedroom with integrated wardrobes, eave storage, and a chimney breast in the centre of the room. Velux windows to the rear aspect bring in natural light.

#### **Bedroom**

**3.71m x 3.60m (12'2" x 11'10")**

A double bedroom with a window to the rear overlooking the garden and countryside, along with eave storage.

#### **Bedroom**

**4.65m x 3.95m (15'3" x 13'0")**

A well-sized double bedroom featuring a velux window to the fore aspect and ample space for wardrobes.

#### **Shower Room**

**2.26m x 1.65m (7'5" x 5'5")**

Waterproof vinyl flooring, tiled walls, a WC, a sink with a mirrored cabinet above, and a corner shower with a rainfall head and sliding glass screen. A heated towel rail, velux window, and extractor fan complete the space.

### **Adjoined Annexe**

#### **Kitchen**

**3.40m x 2.80m (11'2" x 9'2")**

Tiled flooring, a range of matching solid eye and base-level units with worktops and splash backs, a composite double sink, a four-ring electric stove with an extractor hood, and a double oven below. A window to the rear overlooks the garden.

#### **Utility Room**

**1.80m x 1.67m (5'11" x 5'6")**

Tiled flooring, space for a stacked washing machine and dryer, uPVC door leading to patio and garden and an integrated airing cupboard ideal for storage.



### **Lounge / Diner**

**6.03m x 5.98m (19'9" x 19'8")**

A generous living space with carpet underfoot and windows to the fore aspect. Ample room for sofas and a large dining table.

### **Shower Room**

**3.40m x 1.51m (11'2" x 4'11")**

Waterproof vinyl flooring, tiled walls, a WC, a sink, and a walk-in shower with a rainfall head, plus a window to the rear aspect and an extractor fan enhancing ventilation.

### **Adjoined Annexe - First Floor**

#### **Bedroom**

**4.95m x 3.53m (16'3" x 11'7")**

A double bedroom with carpet and a window to the rear, with space for wardrobes.

#### **Bedroom**

**4.95m x 3.45m (16'3" x 11'4")**

A double bedroom with carpet underfoot and a window to the fore aspect, with ample space for wardrobes.

#### **Bathroom**

**2.26m x 1.80m (7'5" x 5'11")**

Oak-effect vinyl flooring, a WC, a sink with a mirrored cabinet above, and a panelled bath. A velux window and extractor fan enhance ventilation.

### **Detached Annexe**

#### **Lounge**

**4.80m x 3.07m (15'9" x 10'1")**

A comfortable living space with carpet underfoot, space for sofas, and a window to the fore aspect allowing plenty of natural light.

#### **Kitchen**

**4.80m x 2.35m (15'9" x 7'9")**

Tiled flooring, a range of matching base units with worktops and splash backs, double sink, an electric stove with hood, plumbing for appliances and window to the rear aspect.

#### **Master Bedroom**

**5.42m x 4.32m (17'9" x 14'2")**

Spacious bedroom with carpet underfoot, wardrobe and window to the fore aspect.

#### **Shower Room**

**2.35m x 2.20m (7'9" x 7'3")**

Oak-effect vinyl flooring, tiled walls, a WC, a sink with a mirror above, a walk-in shower with a glass screen surround, an extractor fan, heated towel rail, and window to the rear.







GROUND FLOOR  
2375 sq.ft. (220.7 sq.m.) approx.



1ST FLOOR  
1873 sq.ft. (174.0 sq.m.) approx.

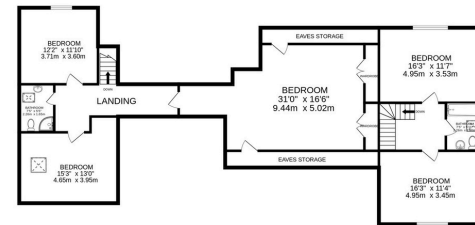

TOTAL FLOOR AREA : 4248 sq.ft. (394.7 sq.m.) approx.

Whilst every attempt has been made to ensure the accuracy of the floorplan contained here, measurements of doors, windows, rooms and any other items are approximate and no responsibility is taken for any error, omission or mis-statement. This plan is for illustrative purposes only and should be used as such by any prospective purchaser. The services, systems and appliances shown have not been tested and no guarantee as to their operability or efficiency can be given.



# Kingswood

Uzmaston, Haverfordwest, SA61 1UR

Guide Price Of £599,950

## Enquire



**Dan Bryce MNAEA**

01437 620 220 | [dan@bryceandco.co.uk](mailto:dan@bryceandco.co.uk)



**Visit Our Website**

[www.bryceandco.co.uk/properties](http://www.bryceandco.co.uk/properties)



**Find Us On Instagram**

[www.instagram.com/bryce.and.co](https://www.instagram.com/bryce.and.co)

## Energy Performance Certificate

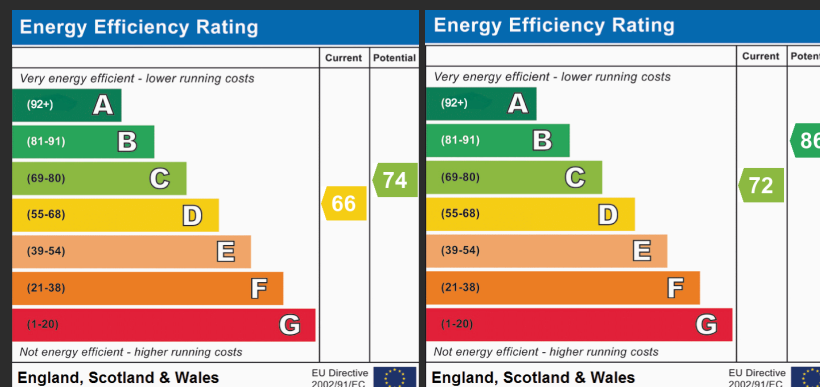

## Additional Information:

Mains electricity, drainage and water are connected. Oil-fired central heating. Council tax band F (£2182.15).

While we endeavour to make our sales particulars fair, accurate and reliable, they are only a general guide to the property and, accordingly, if there is any point which is of particular importance to you, please contact the office and we will be pleased to check the position for you, especially if you are contemplating travelling some distance to view the property. These approximate room sizes are only intended as general guidance. You must verify the dimensions carefully before ordering carpets or any built-in furniture. Please note we have not tested the services or any of the equipment or appliances in this property, accordingly we strongly advise prospective buyers to commission their own survey or service reports before finalising their offer to purchase.

THESE PARTICULARS ARE ISSUED IN GOOD FAITH BUT DO NOT CONSTITUTE REPRESENTATIONS OF FACT OR FORM PART OF ANY OFFER OR CONTRACT. THE MATTERS REFERRED TO IN THESE PARTICULARS SHOULD BE INDEPENDENTLY VERIFIED BY PROSPECTIVE BUYERS OR TENANTS. NEITHER BRYCE & CO ESTATES LIMITED NOR ANY OF ITS EMPLOYEES OR AGENTS HAS ANY AUTHORITY TO MAKE OR GIVE ANY GUARANTEES OR WARRANTIES WHATSOEVER IN RELATION TO THIS PROPERTY.