



NEWSON & BUCK
ESTATE AGENTS

1 Frederick Close
North Wootton
King's Lynn
Norfolk
PE30 3RF

£495,000

Fully renovated and modernised throughout! Newson & Buck are pleased to offer to the open market this beautifully presented three bedroom detached bungalow, situated in the desirable village location of North Wootton just four miles from King's Lynn town centre. The property comprises of an entrance porch, open plan kitchen diner, living room, utility area, three bedrooms with an en suite to the master and a family bathroom. The property has undergone an extensive renovation throughout alongside and beautiful living room extension to the side of the property offering open plan and spacious family living. Further benefits include off road parking for numerous vehicles and an enclosed rear garden with both patio and decking areas. Viewing is highly essential for this property so please call our office today to book your appointment.

- Fully Renovated Throughout
- Extended Bungalow
- Off Road Parking
- Desirable Village Location
- Three Bedrooms - En-suite to master
- Viewing Highly Recommended



Porch

6' 09" x 7' 11" (2.06m x 2.41m) Tiled flooring

Kitchen Diner

14' 03" x 33' 04" (max) (4.34m x 10.16m) LVT flooring, bi flooding patio doors leading to rear garden decking area, fully fitted kitchen, island with integrated wine cooler, sink, induction hob with ceiling extractor, charging station with built in wireless charger, double ovens, fridge freezer, dishwasher, two radiators.

Living Room

15' 11" x 24' 00" (4.85m x 7.32m) LVT flooring, two radiators, two Velux windows, two double glazed windows, log burner.

Utility

4' 09" x 7' 08" (1.45m x 2.34m) LVT flooring, fitted units, integrated sink and microwave, space for washing machine and tumble dryer.

Bedroom One

17' 02" x 10' 0" (5.23m x 3.05m) LVT flooring, double glazed patio doors leading to side garden area, one radiator, fitted wardrobes.

En Suite

4' 08" x 9' 11" (1.42m x 3.02m) Tiled flooring, one towel radiator, rainfall shower, low flush w/c, sink, one double glazed window.

Bedroom Two

12' 02" x 8' 0" (3.71m x 2.44m) LVT flooring, fitted wardrobes, one radiator, one double glazed window.

Bedroom Three

10' 04" x 15' 06" (3.15m x 4.72m) LVT flooring, one double glazed window, one radiator.

Bathroom

7' 04" x 7' 06" (2.24m x 2.29m) Tiled flooring, bathtub with shower attachment, low flush w/c, sink, one towel radiator, one double glazed window.

EPC - TBC

Council Tax Band



GROUND FLOOR

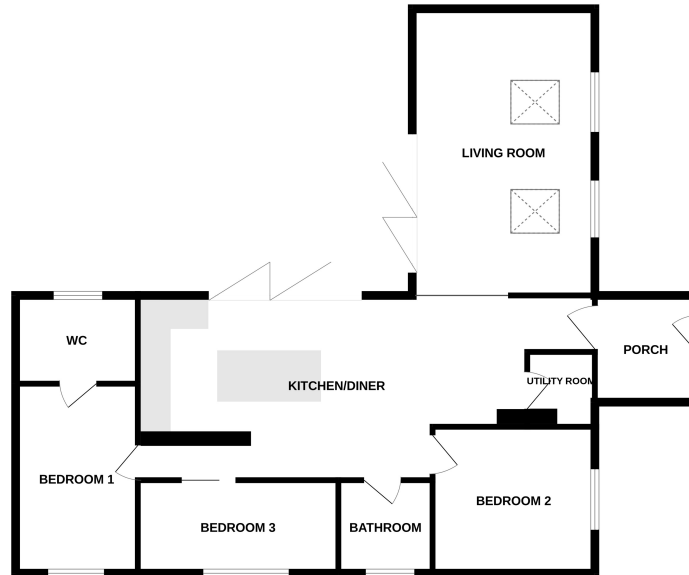

Whilst every attempt has been made to ensure the accuracy of the floorplan contained herein, measurements of doors, windows, stairs and any other items are approximate and no responsibility is taken for any error, omission or mis-statement. This plan is for illustrative purposes only and should be used as such by any prospective purchaser. The services, systems and appliances shown have not been tested and no guarantee as to their operability or efficiency can be given.
Made with Mapbox ©2021



18-20 King Street, King's Lynn, Norfolk, PE30 1ES

Tel: 01553 775151 Email: kingslynn@millsopps.com www.millsopps.com