



Day & Co  
ESTATE AGENTS

28 Cavendish Street

Keighley

BD21 3RG



15 Harden Road, Long Lee,  
Keighley, West Yorkshire, BD21  
4TP

£155,000

T: 01535 664609

W: [www.dayandcoestateagents.co.uk](http://www.dayandcoestateagents.co.uk)

E: [keighley@dayandcoestateagents.co.uk](mailto:keighley@dayandcoestateagents.co.uk)



- COTTAGE
  - CHARACTER FEATURES
  - REAR GARDEN
- TWO BEDROOMS
  - CONSERVATORY
  - NO CHAIN, EPC RATING D

SUMMARY

\*\* CHARMING TWO BEDROOM COTTAGE, CHARACTER FEATURES, CONSERVATORY, GAS CENTRAL HEATING, DOUBLE GLAZING, REAR GARDEN, NO CHAIN, EPC RATING D \*\*

FULL DESCRIPTION

An internal viewing is advised to appreciate this charming two bedroom terraced cottage situated in this popular location. This character property briefly comprises of a lounge with a wood burning stove in feature stone fireplace, feature window seat and double glazed window to front, the kitchen has attractive range of modern base and wall mounted units, integrated fridge, washer dryer, from the kitchen it opens out into a delightful conservatory with French doors to rear, radiator and boiler cupboard. To first floor landing, loft hatch with drop down ladder to boarded loft, the main bedroom has feature stonework to walls, pleasant outlook and fitted wardrobes, there is a second bedroom with a roof window and also the bathroom which is a real feature of this property having feature stonework to walls and a three piece modern suite. Gas Central Heating & Double Glazing. Externally there is an enclosed rear garden. No Chain. EPC RATING D

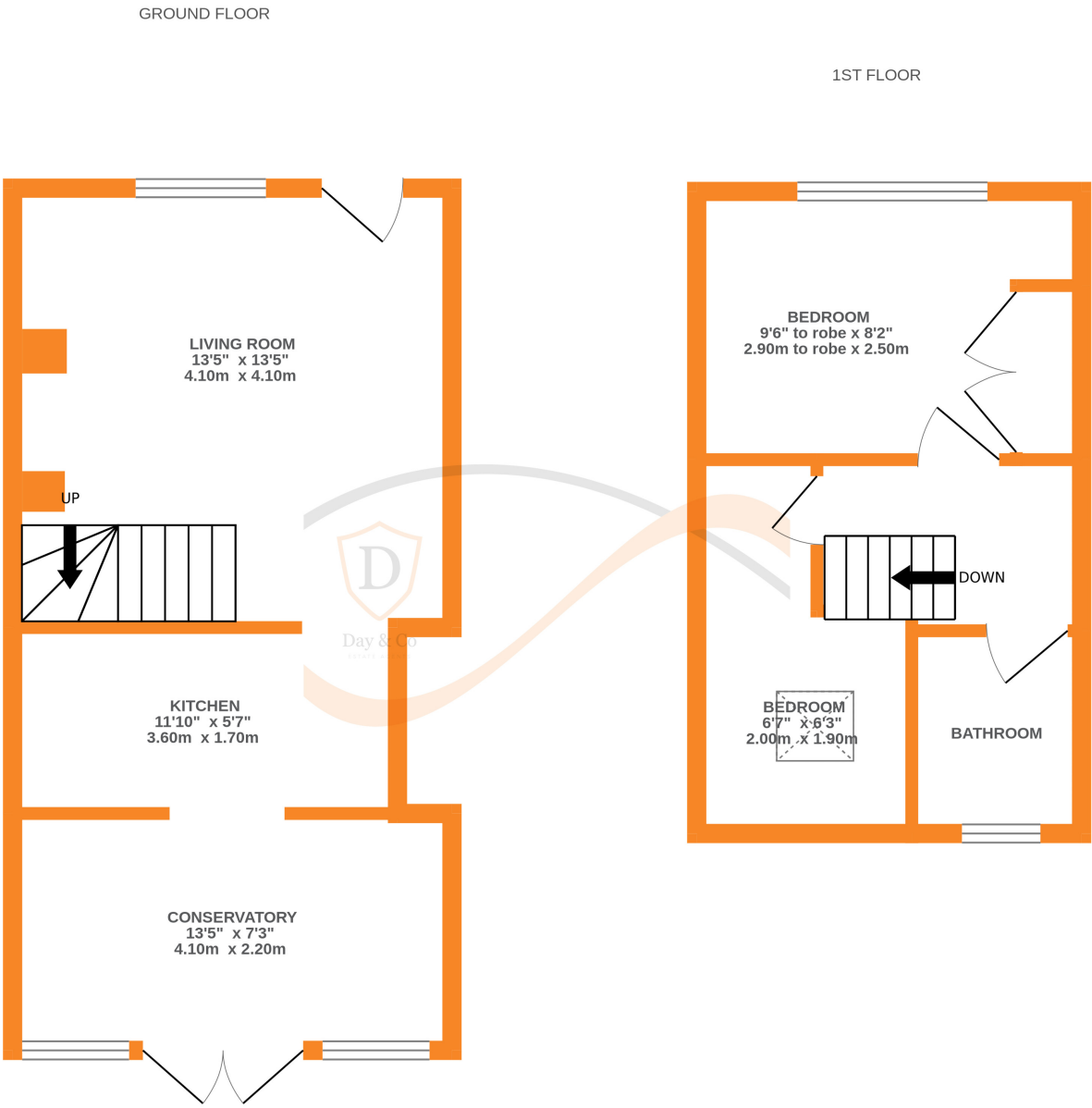

Whilst every attempt has been made to ensure the accuracy of the floorplan contained here, measurements of doors, windows, rooms and any other items are approximate and no responsibility is taken for any error, omission or mis-statement. This plan is for illustrative purposes only and should be used as such by any prospective purchaser. The services, systems and appliances shown have not been tested and no guarantee as to their operability or efficiency can be given.  
Made with Metropix ©2024