



daniels
danielsestateagents.co.uk



Redfern Road, Harlesden, London NW10 9LB
£305,000 - Leasehold



PROPERTY DESCRIPTION

NO UPPER CHAIN...

A SPACIOUS and WELL PRESENTED ONE BEDROOM GROUND FLOOR GARDEN FLAT located on a popular no through road in Harlesden.

The property is conveniently located offering easy access to High Street Harlesden & the beautiful open spaces of Roundwood Park. Benefits include BAY FRONTED RECEPTION ROOM, KITCHEN BREAKFAST ROOM, FITTED BATHROOM, DOUBLE BEDROOM & SOLE USE OF REAR GARDEN.

The leasehold has approx 116 years remaining with a current monthly service charge of £97.91, Ground rent is £100 per annum.

POINTS OF INTEREST

- LEASEHOLD 116 YEARS REMAINING
- ONE BEDROOM
- PRIVATE REAR GARDEN
- PERIOD CONVERSION
- WELL PRESENTED
- NO THROUGH ROAD

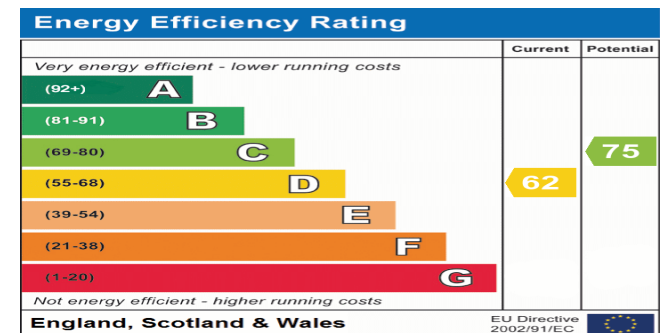

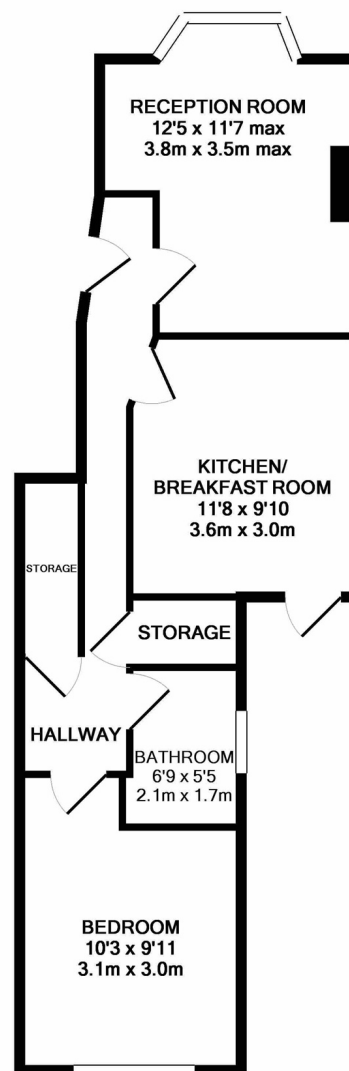

REDFERN ROAD, HARLESDEN, LONDON, NW10 9LB
TOTAL APPROX. FLOOR AREA 519 SQ.FT. (48.2 SQ.M.)

Whilst every attempt has been made to ensure the accuracy of the floor plan contained here, measurements of doors, windows, rooms and any other items are approximate and no responsibility is taken for any error, omission, or mis-statement. This plan is for illustrative purposes only and should be used as such by any prospective purchaser. The services, systems and appliances shown have not been tested and no guarantee as to their operability or efficiency can be given
Made with Metropix ©2017