

Important Notice: These Particulars have been prepared for prospective purchasers for guidance only. They are not part of an offer or contract. Whilst some descriptions are obviously subjective and information is given in good faith, they should not be relied upon as statements or representative of fact. If the property has been extended, or altered, we may not have seen evidence of planning consent or building regulation approval, although we will have made enquiries about these matters with the Vendor.

Made with Mapbox ©2025

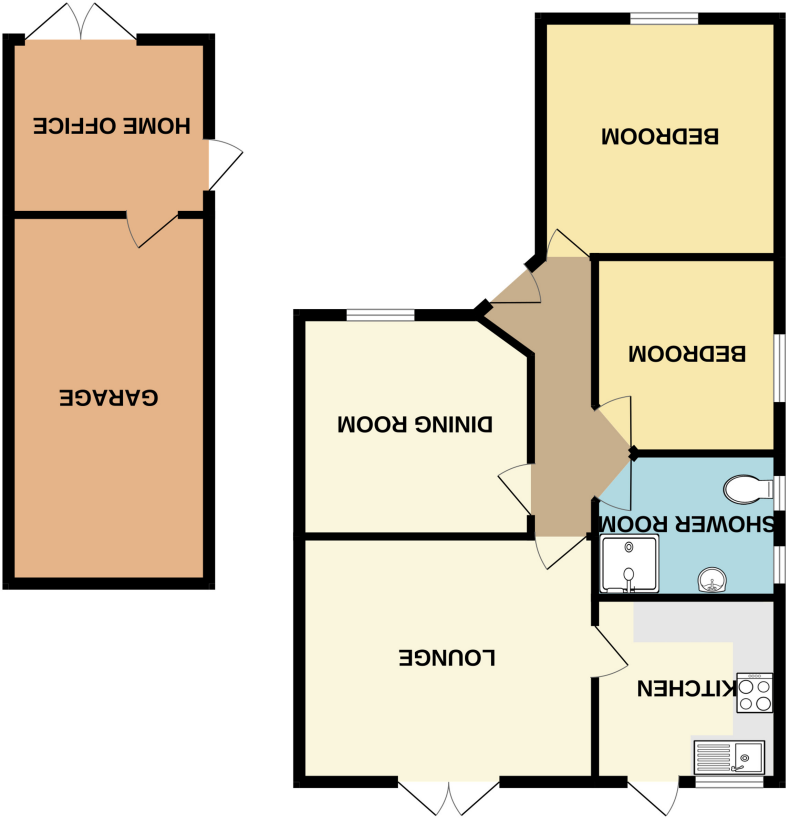

GROUND FLOOR

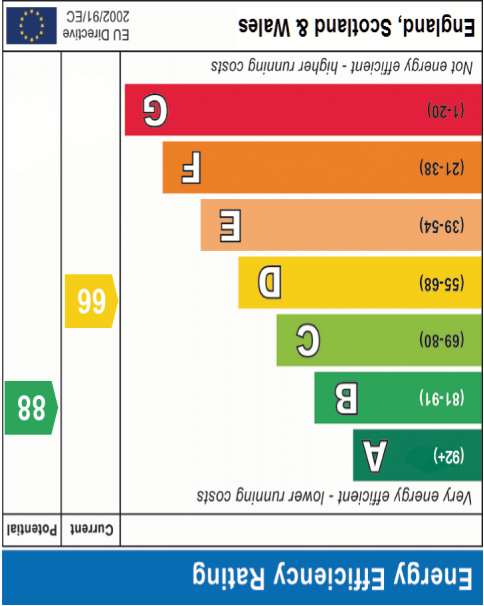



PROPERTY EXTERIOR

Street appeal, this attractive bungalow boasts: Low-Maintenance Front Garden; Shared Driveway to Garage at Rear; and Spacious Parking Area; Gated Access to Rear Garden.

HALLWAY

14' 5" x 5' 0" (4.39m x 1.52m) narrows to 3ft 2ins Light and bright entrance hallway with laminate flooring throughout. Doors to: Dining, Living Room; Bedrooms; Shower Room.

LIVING ROOM

14' 4" x 11' 0" (4.37m x 3.35m) Double-Glazed French Doors boasting lovely rear garden views. Laminate Flooring; Plantation Shutters; Feature Fireplace; Built-in Display Cabinets; Wall-Mounted Cylinder Radiator; Ceiling Light Fittings.

KITCHEN

8' 11" x 8' 2" (2.72m x 2.49m) Tile-Effect Laminte Flooring; Ample Wall and Base Units to include Matching Floor to Ceiling Cabinets; Mixer Tap to Stainless Steel Sink; Extractor Fan; Space for Dishwasher and Cooker; Tiled Splashbacks; Plantation Shutter to Double-Glazed Window; Door to Rear Garden.

SHOWER ROOM

8' 11" x 7' 0" (2.72m x 2.13m) Modern shower room comprising of: Glass Door to Shower Cubicle; Hot and Cold Water Taps to Vanity Basin; WC. Wall-Mounted Mirrors with Over-Head Lighting; Extractor Fan; Wall-Mounted Radiator; Double-Glazed Windows; Ceiling Light Fittings; Mosaic Tile Effect Flooring.

The shower room boasts plenty of units to include space to integrate your washing machine and dryer.

BEDROOM ONE

11' 7" x 10' 11" (3.53m x 3.33m) Lovely and light front facing bedroom with: Large Bay Window; Plantation Shutters; Built-in-Robes; Built-in-Dresser; Radiator; Carpeted Flooring; Ceiling Light Fitting.

BEDROOM

11' 3" x 10' 10" (3.43m x 3.30m) Double bedroom with: Carpeted Flooring; Radiator; Ceiling Light Fittings; Plantation Shutters to Double-Glazed Window.

BEDROOM

9' 7" x 8' 11" (2.92m x 2.72m) Laminate Flooring; Radiator; Ceiling Light Fittings; Plantation Shutters to Double-Glazed Window. This room would make an ideal formal dining room, if a third bedroom is not required.

REAR GARDEN

WEST-FACING GARDEN - Sunny all day long! A beautiful low-maintenance garden of approximately 55ft comprising of: Paved Patio; Bordered Brick-Built Flower & Shrub Beds; Lawn Areas; Fully Fenced; Gate to Side Access; Door to Office Space with Internal Door to Garage.

OFFICE 9ft 6ins x 8ft 6 ins - Laminate Flooring; Ceiling Spot Lights; Double-Glazed Window; Electrics with Independent Consumer Unit.

GARAGE 17 ft 11 ins x 9 ft 9 ins

ROCHFORD COUNCIL

TAX BAND C

