

FOR SALE

Offers in Excess Of £350,000

Escolme Drive, Greasby, Wirral. CH49 1SF



Walk in Wow Factor! This incredible, extended three bedroom semi-detached residence will no doubt impress you from the moment of entry as our vendors have created something special.

Positioned on the quiet Escolme Drive in Greasby yet nearby to excellent local amenities such as shops, schools and transport links.





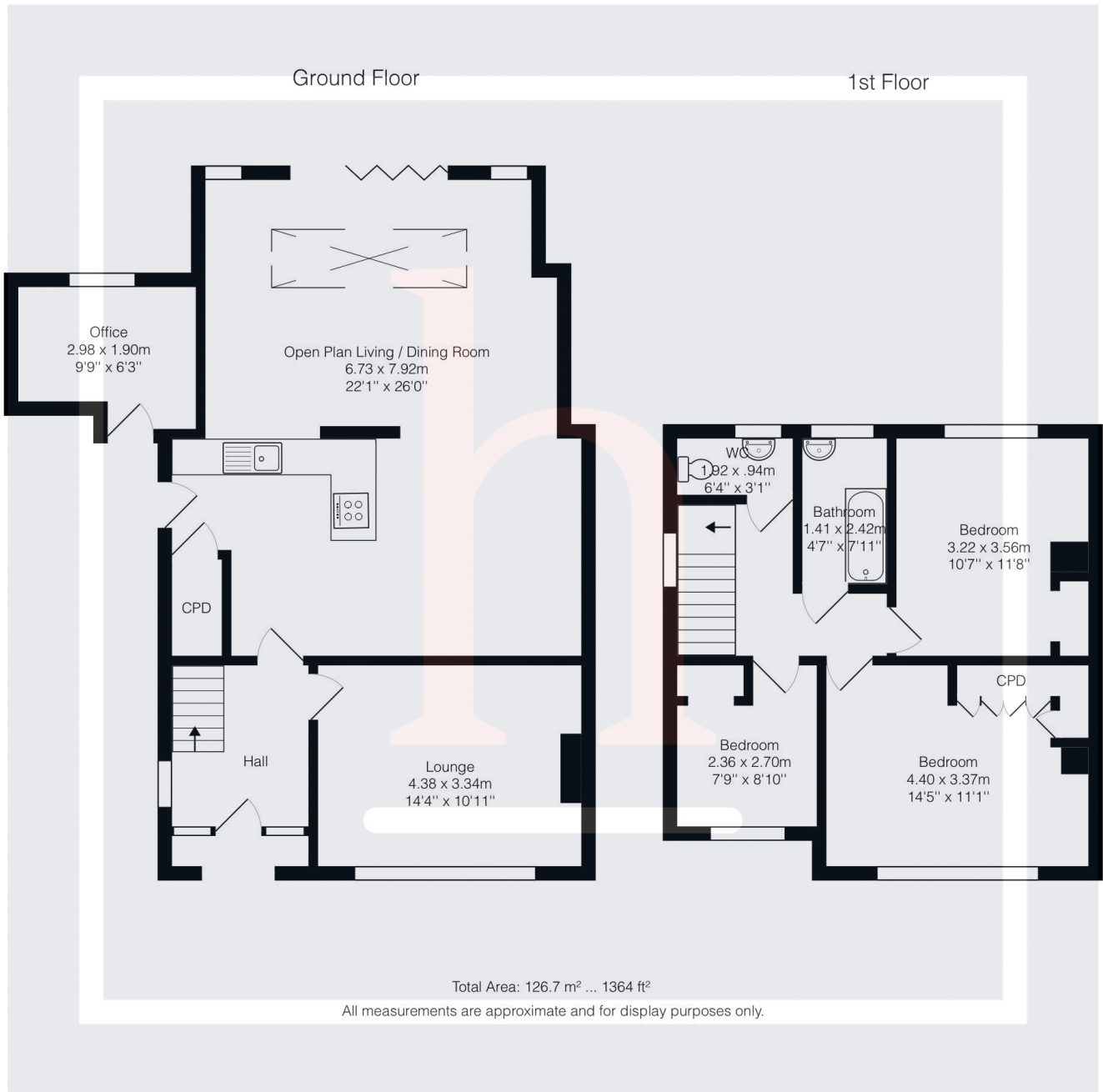

Energy Efficiency Rating		Current	Potential
Very energy efficient - lower running costs			
(92+)	A		
(81-91)	B		84
(69-80)	C		
(55-68)	D	65	
(39-54)	E		
(21-38)	F		
(1-20)	G		
Not energy efficient - higher running costs			
England, Scotland & Wales		EU Directive 2002/91/EC	