



16 Fraser Avenue, St Andrews, Fife, KY16 8HX

Beautifully Presented, Three-Bedroom, Mid-Terrace Villa with Garden

Up to date price and viewing info at [mov8realestate.com/property](https://www.mov8realestate.com/property)



Property Description

Beautifully-presented, spacious and flexible, three-bedroom, mid-terrace villa, with a private garden. Located in an established, quiet and desirable residential area of St Andrews, Fife.

Comprises an entrance hall, a living room, a flexible dining room/potential fourth bedroom, a kitchen, three double bedrooms, and a shower room.

Highlights include a modern integrated fitted kitchen and a stylish bathroom, with contemporary flooring and decor - ready-to-move-in. In addition, there is double glazing, gas central heating, good storage provision; and well-proportioned room sizes, with the potential of a four-bed, one-public room configuration.

Externally, the property benefits from an enclosed rear garden, featuring a composite decked patio, a synthetic turf lawn, and a brick-built store shed.

A welcoming entrance hall affords access to the carpeted stairs leading to the upper hall and throughout the ground floor, including two built-in cupboards, providing superb storage provision. Set to the rear, the living room is tastefully finished with contemporary decor, wood effect flooring, a central light fitting and uplights, and a sliding door leading to the garden. A spacious kitchen is also set to the rear, providing further garden access whilst, fitted wall and base units include stone effect worktops, a breakfast bar, a tiled surround, a sink with a drainer; and an integrated oven, gas hob, dishwasher, washing machine and fridge/freezer. Completing the ground floor, the dining room is set to the front, offering the potential for a fourth bedroom if desired, finished with light decor and wood effect flooring.

On the upper floor, bedrooms one and two are set to the rear, similarly well-sized, featuring carpeted flooring and central light fittings, with bedroom two also including a built-in wardrobe, whilst, another well-finished carpeted bedroom is set to the front. Completing the accommodation, the shower room is fitted with a modern suite including a corner cubicle with a rainfall shower and panelled splash walls, wood effect flooring, a ladder-style radiator, and tiled splash walls.



16 Fraser Avenue, St. Andrews KY16 8HX

Approximate Gross Internal Area: (1023 sq ft - 95 sq m.)

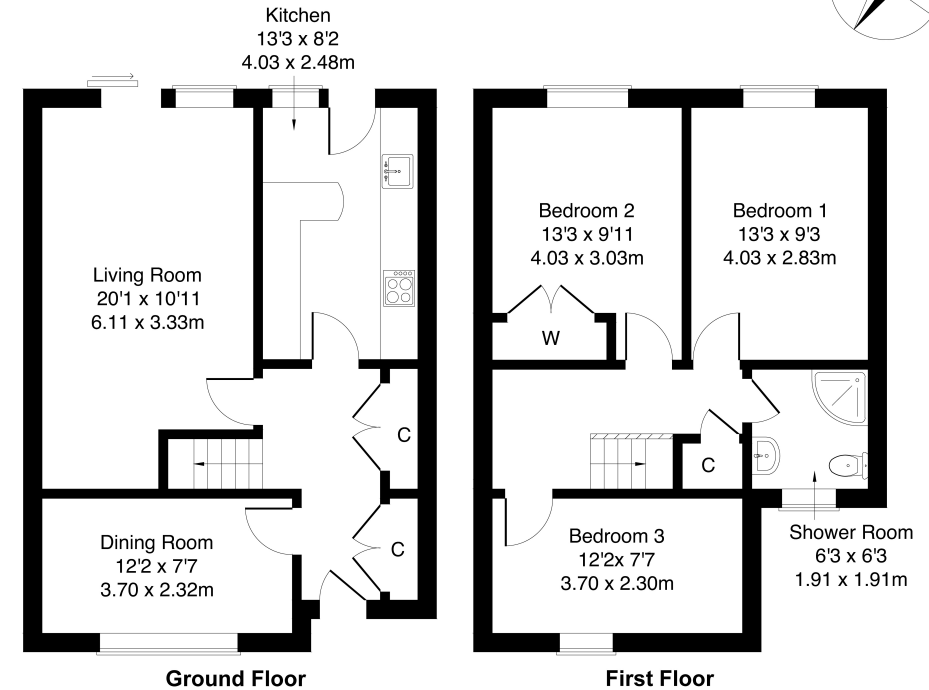
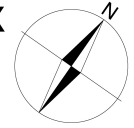

Legal Disclaimer : Floor-plan and measurements are for illustrative guidance only, and not intended to form part of any contract.

Area Description

St. Andrews is a seaside town, on Scotland's east coast, a world-famous home of golf, and known for its medieval streets, historic university and charismatic traditional buildings. With the largest public golf complex in Europe offering seven golf courses, the town also offers a range of outdoor recreation with the Fife Coastal Path, West and East Sands Beach and Craigtoun Country Park, as well as a leisure

centre. St. Andrews has a wide variety of everyday amenities, with several food stores, cafes and restaurants, as well as well-regarded schooling for all levels, with The University of St Andrews ranked number one in the UK. The town has excellent travel facilities, including a railway station, and local bus services, with the A91 and A915 connecting to the north and south.





Our Services

- Free pre-sale property valuations
- Great value fixed estate agency fees
- Extensive buyer matching database
- Purchase and sale conveyancing

Contact Us

0345 646 0208

sales@mov8realestate.com

www.mov8.com

Head Office

6 Redheughs Rigg, Edinburgh, EH12 9DQ

Glasgow Office

77 Renfrew Street, Glasgow, G2 3BZ



Estate Agents and Solicitors

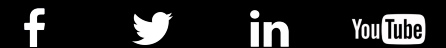

These particulars do not form part of any contract and the statements or plans contained herein are not warranted nor are they to scale. All descriptions, dimensions, areas, reference to condition and necessary permissions for use and occupation and other details are given in good faith, and are believed to be correct, but any prospective purchaser should not rely on them as statements or representations of fact, and any prospective purchaser must satisfy themselves by inspection or otherwise as to the correctness of each of them. The Seller shall not be bound to accept the highest or any offer nor to accept a full offer of the Fixed Price where this is applicable. Approximate measurements have been taken by sonic device and measurements are most often taken to the widest point of any room or space. Services and appliances have not been tested for efficiency or safety and no warranty is given as to their compliance with any Regulations. Offers should be made using the Combined Standard Clauses.