

44 Hutton Road  
Shenfield Brentwood  
Essex CM15 8LB

Telephone: 01277 203322  
Email: [info@courtco.co.uk](mailto:info@courtco.co.uk)  
Web: [www.courtco.co.uk](http://www.courtco.co.uk)

# COURT CO



## Clune Court, Hutton Road, Shenfield, Brentwood, Essex, CM15 8NQ

£900,000

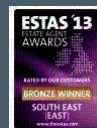

**\*\* Guide Price £900,000 - £950,000\*\*** Available for the first time since its construction in 1996 is this impressive approx. 2000 Sq Ft Three Bedroom Penthouse Apartment. Located in the much sought after private development Clune Court the property is quite literally a few steps away from Shenfield vibrant Broadway, with its many independent coffee shops, boutiques, restaurants, Main and Elizabeth Line Station. The Penthouse has elevator access and also features a private roof terrace, its own garage and parking space.

- SHARE OF FREEHOLD
- APPROX. 2000 SQ FT
- MASTER BED WITH DRESSING ROOM AND EN-SUITE
- PRIVATE ROOF TERRACE
- UTILITY ROOM
- ELEVATOR ACCESS
- PENTHOUSE APARTMENT
- THREE BEDROOMS
- KITCHEN BREAKFAST WITH VAULTED GLASS CEILING
- LARGE LOUNGE & DINING AREA
- PRIVATE GARAGE & OFF STREET PARKING





**Entrance Hall**

**Lounge Dining Room**



**Kitchen Breakfast Room**



**Dining Area**



**Utility Room**

**Bedroom One**

**Walk in Wardrobe**

**En-suite**

**Bedroom Two**

**Bedroom Three**

**Private Roof Terrace**



# Floor Plan

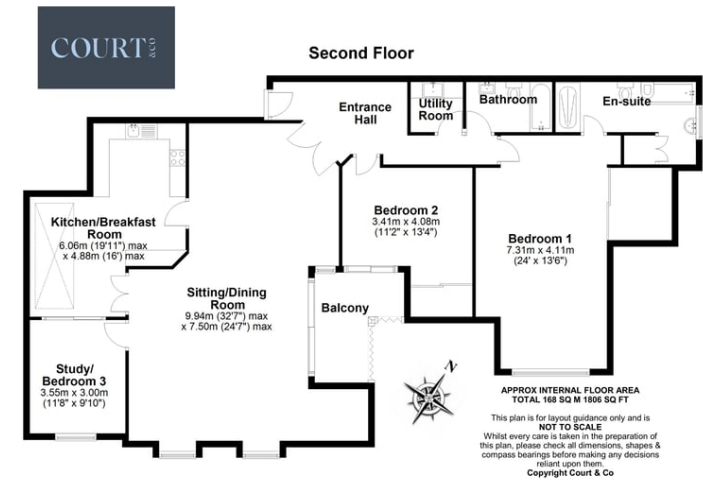

## External

### Private Garage Plus Allocated Parking Space

#### PROPERTY MISDESCRIPTIONS ACT 1991

The Agents not tested any apparatus, fixtures and fittings, or services, so cannot verify that they are in working order or fit for the purpose. The buyer is advised to obtain verification from his or her Professional Adviser. Refernces to the Tenure of the property are based on information supplied by the Vendor. The agent has not had sight of the title documents. The buyer is advised to obtain verification from their Solicitor. You are advised to check the availability of any property before travelling any distance to view.