



Baldock Road
Stotfold,
Bedfordshire, SG5 4NZ
Offers Over £200,000

COUNTRY PROPERTIES
PART OF HUNTERS

Chain Free - Renovation opportunity. This 2 bedroom character cottage is just waiting for someone to give it a new lease of life and turn it into their perfect home. It does have the basics, with double glazing and gas central heating. The ground floor is open plan and a good size, the property has a long south westerly facing rear garden with an off street parking space at the rear accessed from Murrell Lane.



- Chain free
- Terraced cottage
- Renovation opportunity
- 2 bedrooms
- South westerly facing rear garden
- Off street parking for one vehicle
- Spacious open plan ground floor accommodation
- Double glazed
- Gas central heating





Room Sizes

Living Room - 3.64m x 3.66m (11' 11" x 12' 0")

Dining Room - 2.47m x 3.66m (into cupboard) (8' 1" x 12' 0")

Kitchen - 2.21m x 2.59m (7' 3" x 8' 6")

Bathroom - 1.83m x 1.50m (6' 0" x 4' 11")

Bedroom 1 - 3.64m x 3.66m (11' 11" x 12' 0")

Bedroom 2 - 2.47m x 2.81m (8' 1" x 9' 3")



Location

Stotfold

Stotfold has a good range of local facilities including a doctor's surgery, dentist, post office and Co-op. The town is close to excellent transport links to London and Cambridge via the A1 and train stations in Arlesey and Letchworth. There are lots of lovely countryside walks nearby, including around Stotfold Mill where there is a tranquil nature reserve for peaceful days out. On the Hertfordshire border, Stotfold has good access to leisure and shopping facilities in the nearby towns of Hitchin, Letchworth and Biggleswade.

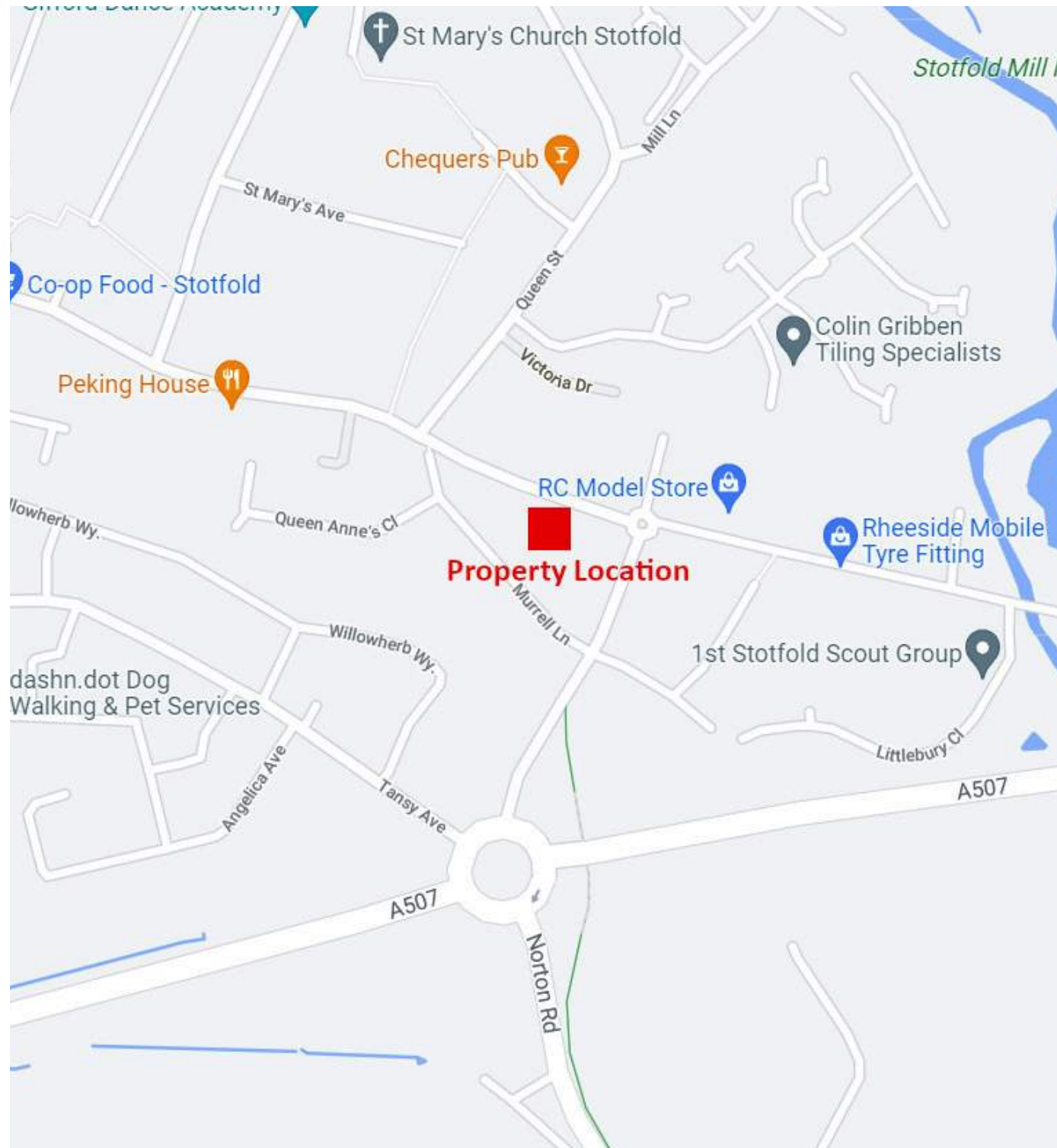

Ground Floor

Approx. 33.1 sq. metres (356.6 sq. feet)

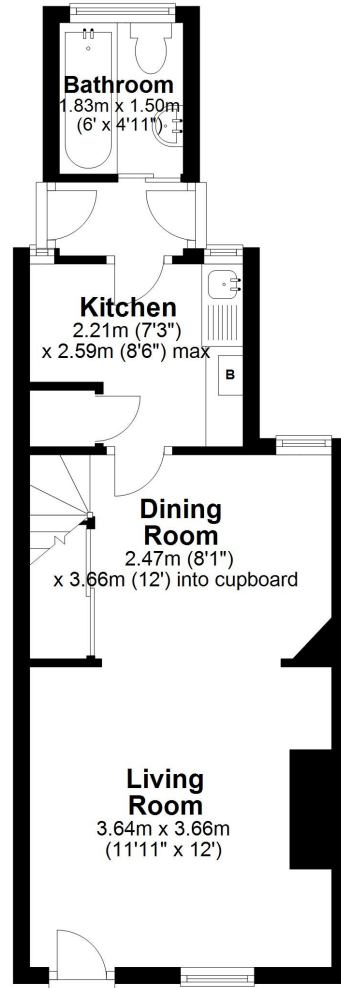

First Floor

Approx. 22.8 sq. metres (244.9 sq. feet)

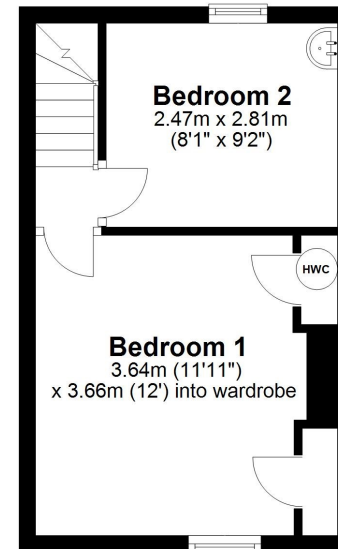

Total area: approx. 55.9 sq. metres (601.5 sq. feet)

All measurements are approximate and quoted in metric with imperial equivalents and for general guidance only and whilst every attempt has been made to ensure accuracy, they must not be relied on. The fixtures, fittings and appliances referred to have not been tested and therefore no guarantee can be given and that they are in working order. Internal photographs are reproduced for general information and it must not be inferred that any item shown is included with the property. For a free valuation, contact the numbers listed on the brochure.

Viewing by appointment only

Country Properties | 1, Arlesey Road | SG5 4HA

T: 01462 834022 | E: stoffold@country-properties.co.uk

www.country-properties.co.uk

