



Tel: 01242 676767

www.cotswoldestateagents.co.uk

41a Church Road, Bishops Cleeve, Cheltenham, GL52 8LP

88, Staverton Park
Staverton GL51 6TD

£140,000



FOR SALE

Set in a pleasant location is this modern light and airy two bedroom park home. The comfortable well planned living accommodation comprises entrance hall, Lounge, modern fitted kitchen with built in and intergraded appliances, modern bathroom suite, double bedroom and one single. To the exterior there is an enclosed garden with feature raised patio area and off road parking for one vehicle. The spa town of Cheltenham is approximately six miles distance with extensive range of shopping facilities and amenities.

The accommodation comprises: entrance hall with doors to lounge, kitchen, bathroom, bedroom one and two. Lounge: windows to front and side aspect, fireplace fitted with electric fire, double panelled radiator. Kitchen: french doors to raised patio area, window to side aspect, modern fitted kitchen comprising a matching range of eye and base level storage units with built-in oven, gas hob and extractor hood, space and plumbing for washing machine, and integrated fridge freezer. Bathroom with window to side aspect, modern white suite comprising bath fitted with shower unit and shower screen, vanity unit, WC and single panelled radiator. Bedroom one: bay window to front aspect, single panelled radiator, built-in double wardrobe and drawer unit.

Exterior: front garden being mainly laid to lawn with raised brick planter, there is a block paved driveway for one vehicle: rear garden is enclosed with a raised patio area with wrought iron railings and is laid to lawn and stocked with various flowers and shrubs and metal storage shed.





GROUND FLOOR
35.8 sq.m. (386 sq.ft.) approx.

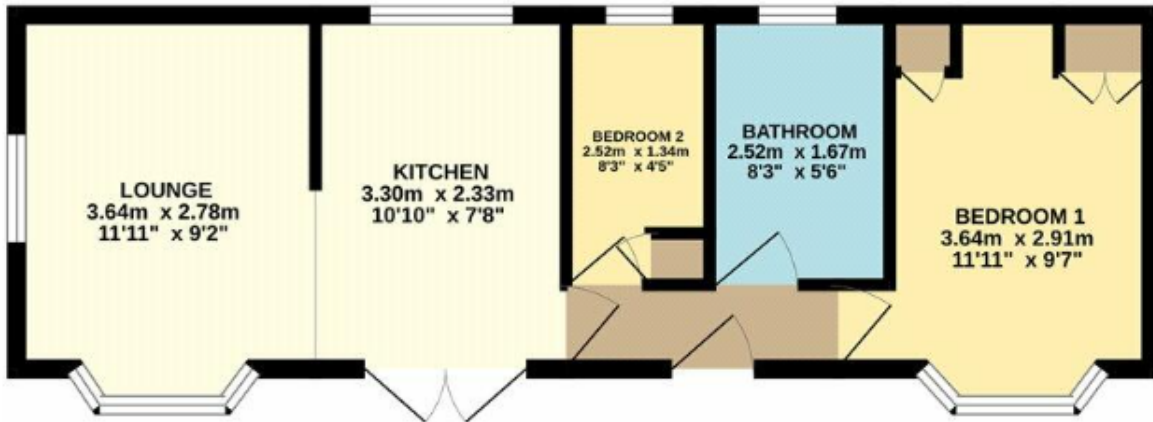

TOTAL FLOOR AREA: 35.8 sq.m. (386 sq.ft.) approx.

Whilst every attempt has been made to ensure the accuracy of the floor plan contained here, measurements of doors, windows, rooms and any other items are approximate and no responsibility is taken for any error, omission or mis-statement. This plan is for illustrative purposes only and should be used as such by any prospective purchaser. The services, systems and appliances shown have not been tested and no guarantee as to their operability or efficiency can be given.

Made with Meropix ©2023