



London Road | Billericay | £550,000



London Road

Billericay | Essex | CM11 2XL

The Property Specialists of Billericay are delighted to offer for sale this beautifully presented four double bedroom semi detached house which has a fantastic size plot.

The family home is entered via a porch to the front, where you are greeted by a good size hallway with feature window, stairs to first floor with ample under stair storage and a downstairs cloakroom W/C. To the front of the property is a large kitchen breakfast room with a range of fitted units incorporating integrated appliances, including two ovens and an induction hob. This space is a fantastic area for entertaining.

The property also boasts a separate utility room with further storage units and space for a washing machine and tumble dryer. To the rear of the property are the two fantastic reception rooms giving you so much space for the family, overlooking the large rear garden.

Upstairs there are four great size bedrooms all with big double glazed windows letting in lots of natural light and a modern white three piece bathroom suite to the side.

The Property is nicely set back from the road providing parking for several cars and the rear garden is mainly laid to lawn and over 140 feet in length.

An internal viewing is strongly advised to fully appreciate the size of the accommodation on offer.





- Large Semi Detached Family Home
- Entrance Porch And Spacious Hallway
- Kitchen Breakfast Room With Integrated Appliances
- Four Double Bedrooms
- Three Piece Family bathroom
- Set Back From The Road Enjoying A Generous Size Plot
- Two Fantastic Reception Rooms With Fitted Storage Units
- Separate Utility Room
- Rear Garden Approaching 145ft



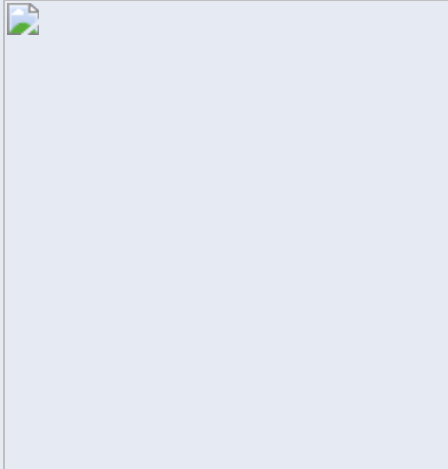
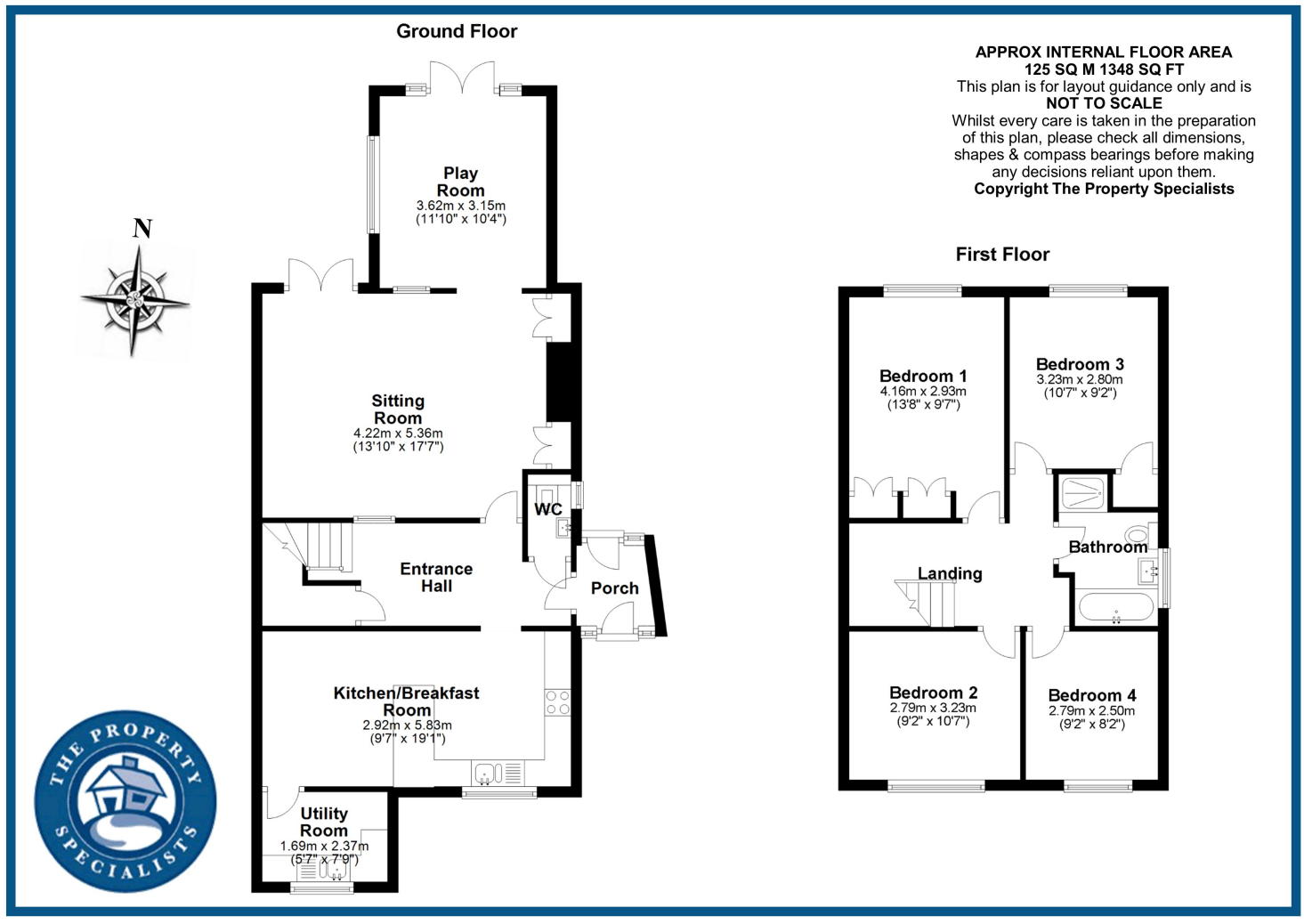

Viewing strictly by appointment with The Property Specialists



Making Moving Home
Less Stressful

135 High Street, Billericay,
Essex, CM12 9AB
Tel: 01277 654446
sales@thepropertyspecialists.co.uk