

The map displays the Foord area, characterized by a dense network of roads. A blue location pin is positioned on a road near the center of the map, specifically on the road between Hill Rd and Dover Rd. The map includes labels for major roads such as Hill Rd, Dover Rd, and Tram Rd, as well as numerous residential streets like Park Farm Rd, Down Rd, and Joyes Rd. Green spaces are visible, particularly in the upper and lower left areas. The names of surrounding areas, Lynwood to the west and East Cliff to the east, are also present. The map is oriented with North at the top.





Located just moments away from local amenities and transport links, you'll enjoy easy access to everything Folkestone has to offer—from quaint shops and cafes to scenic coastal walks along the picturesque sea front.

Available Immediately.

Working and Retired Tenants must be earning a minimum of £37,500 per annum as a combined household.

No smoking.

Call Burnap + Abel on 01303258590 to organise a viewing.



**Ground Floor**  
Approx. 40.4 sq. metres (435.1 sq. feet)

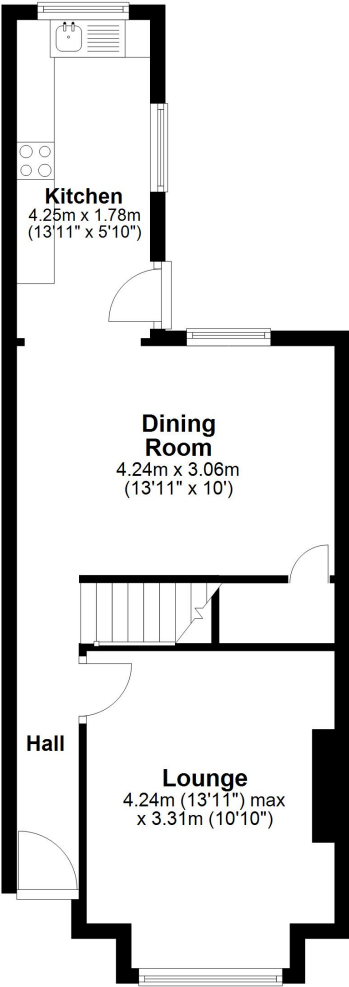

**First Floor**  
Approx. 33.2 sq. metres (357.9 sq. feet)

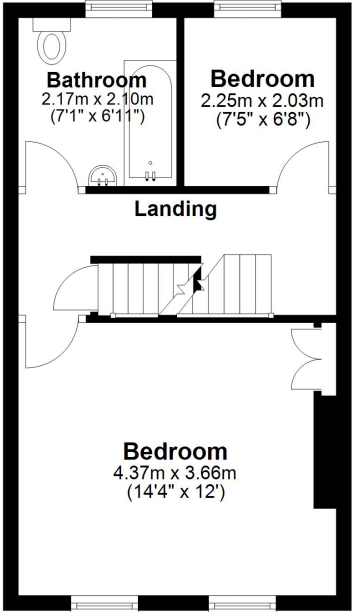

**Second Floor**  
Approx. 23.0 sq. metres (247.5 sq. feet)

