

FOR SALE

£795,000

Mill Lane, Willaston, Neston, Cheshire. CH64 1RW

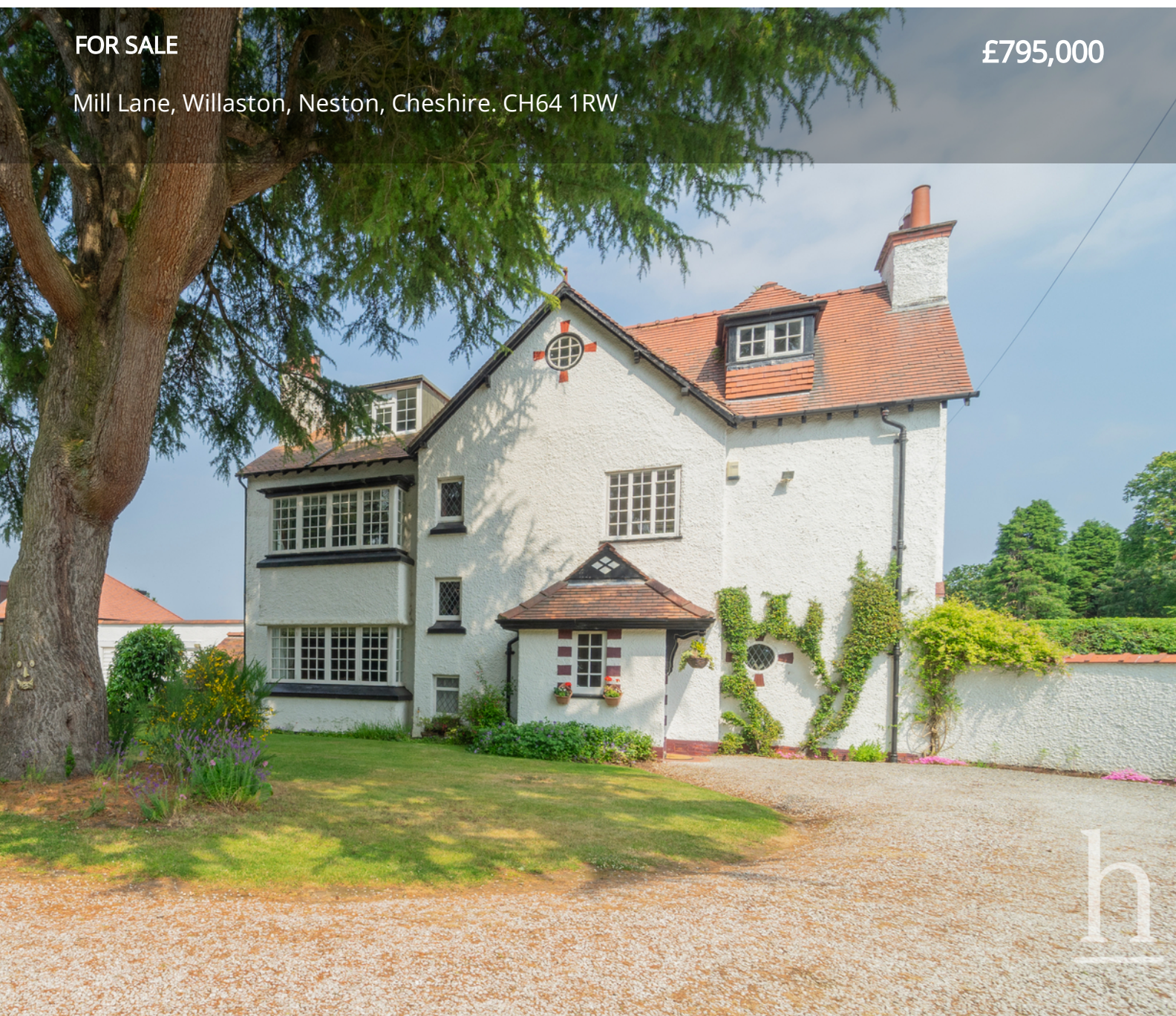

h

Impressive Detached Period Family Residence! Located in the highly desirable village of Willaston the property offers incredibly spacious accommodation arranged over three floors and retains many of its original charm, character and period features. Whilst the property requires some upgrading, it offers huge potential to create a stunning home. With six bedrooms, two bathrooms, flexible living accommodation, generous grounds, ample parking, garaging and outbuildings the property could easily satisfy the needs of many buyers with an appetite to renovate and finish a property to their own vision, tastes and specifications. Dating back to circa 1910, Netherfield is situated on one of the most sought after roads in Willaston and enjoys a semi-rural yet accessible location close to the village.





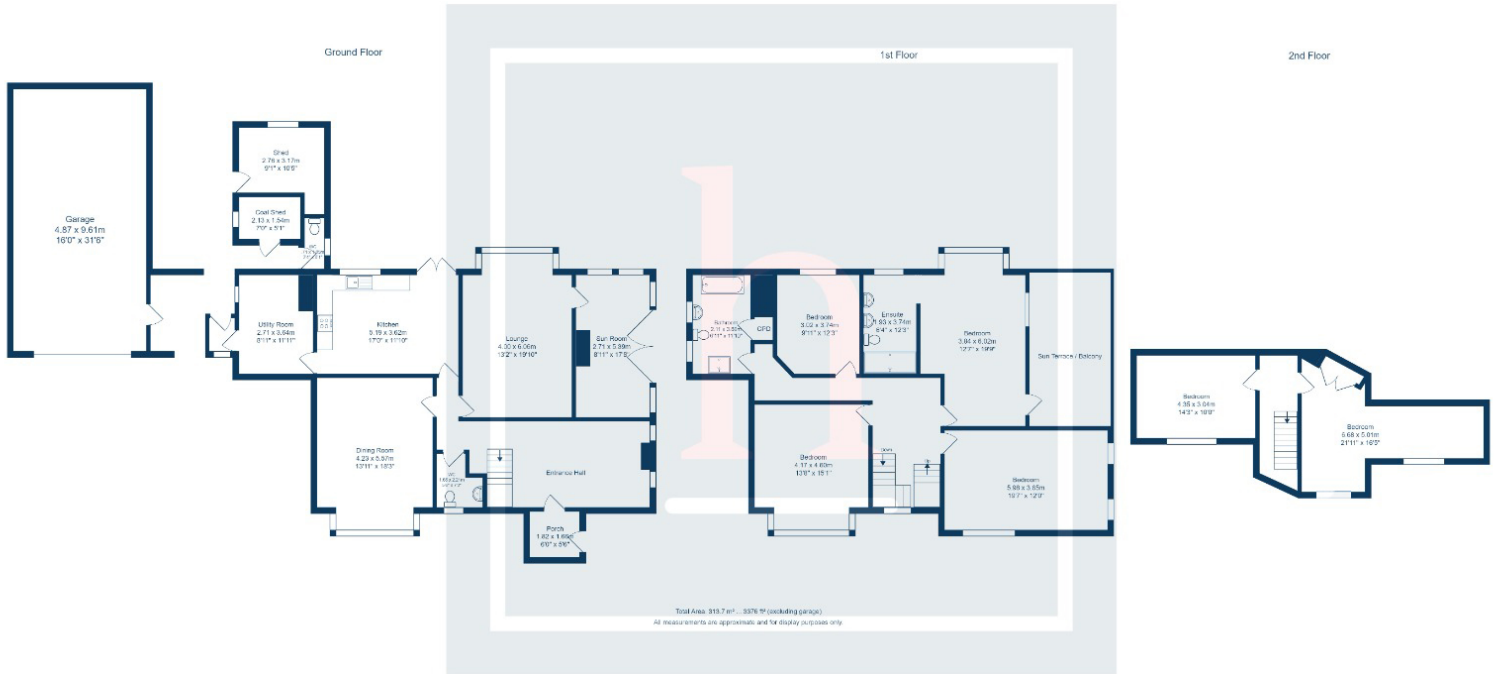

Energy Efficiency Rating		Current	Potential
Very energy efficient - lower running costs			
(92+)	A		
(81-91)	B		
(69-80)	C		73
(55-68)	D		
(39-54)	E	47	
(21-38)	F		
(1-20)	G		
Not energy efficient - higher running costs			
England, Scotland & Wales		EU Directive 2002/91/EC	